

# TRAIL KING

PRO SCALE CHASSIS

1/10 SCALE ELECTRIC 4X4 – BUILDERS KIT

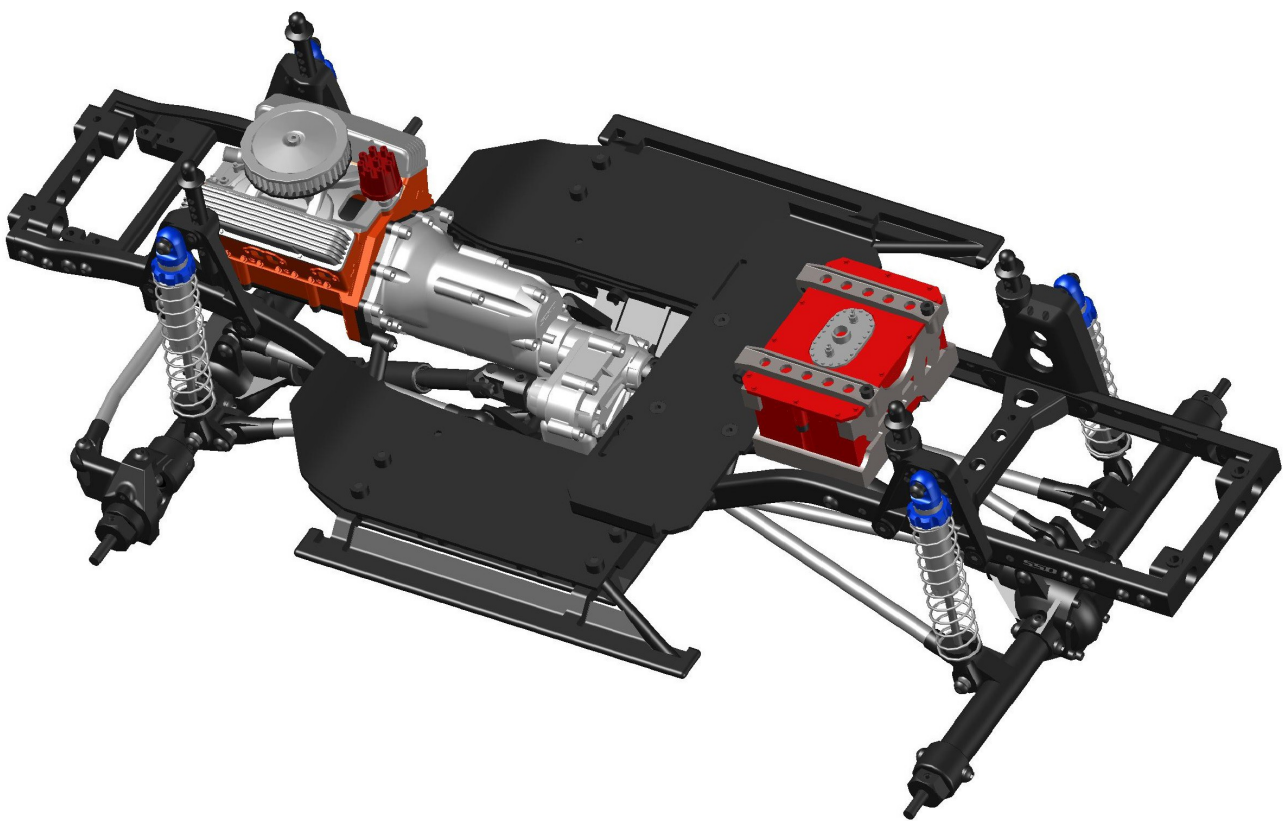

SSD

## Kit Box Contents

Bag A	Rear Axle
Bag B	Front Axle
Bag C	Aluminum Hex set
Bag D	Transmission
Bag E	Titanium Suspension Link set
Bag F	Titanium Steering Link set
Bag G	Transmission Mounts
Bag H	Steel Frame set
Bag J	Plastic Chassis parts
Bag K	Aluminum parts
Bag M	Steel Driveshafts
Bag P	Aluminum Shocks
Bag Q	Aluminum Battery Tray
Bag R	Fuel Cell
Bag S	V8 Engine
Bag T	Hardware

## Tools and items required for assembly:

- 2.0mm hex driver
- 1.5mm hex driver
- Grease
- Shock oil
- Thread lock (blue)
- ABS plastic model glue/cement

## Parts and electronics needed to complete chassis:

- 540 size electric motor
- Steering servo + servo horn (20mm)
- 1.9" Wheels
- 1.9" Tires
- Body (313mm wheelbase)
- Bumpers (SCX10 II compatible)
- Electronic speed controller
- Transmitter & receiver
- Battery

## Assembly Tips

- Use a very small amount of thread lock on metal screws in metal parts
- Grease all gears thoroughly
- Do not over tighten screws into plastic parts

## Open Bag A - Rear Axle

- 1 30T Ring gear and steel locker  
Use thread lock on screws

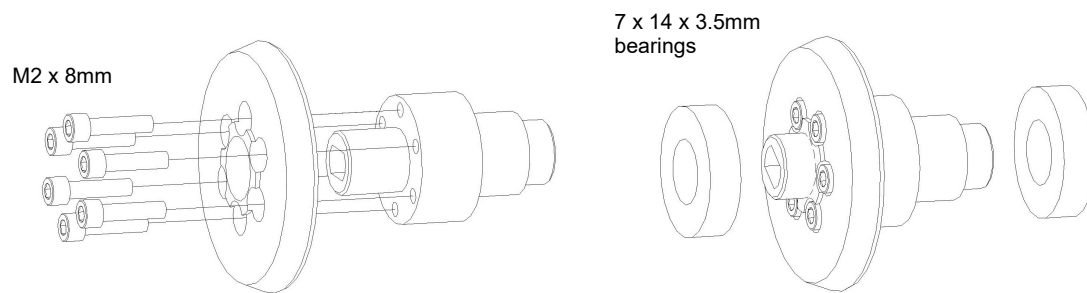

2

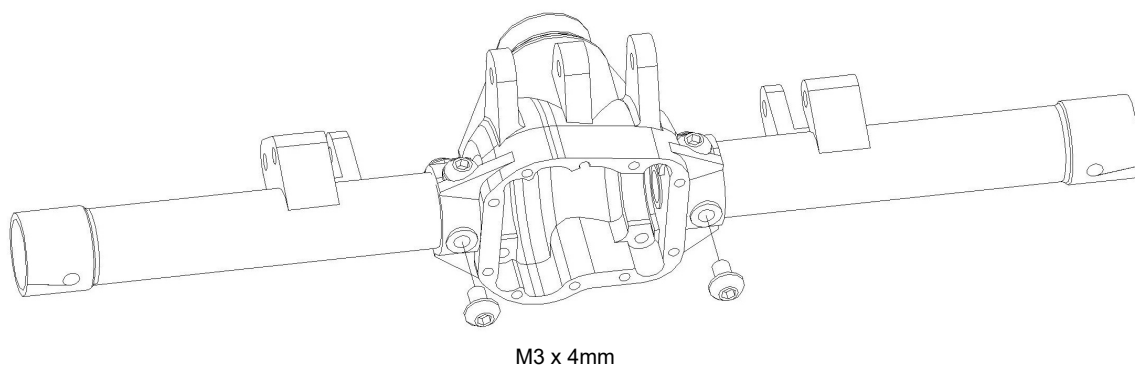
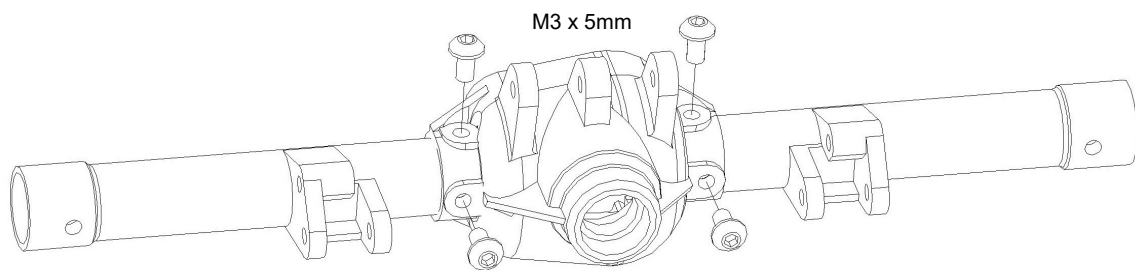
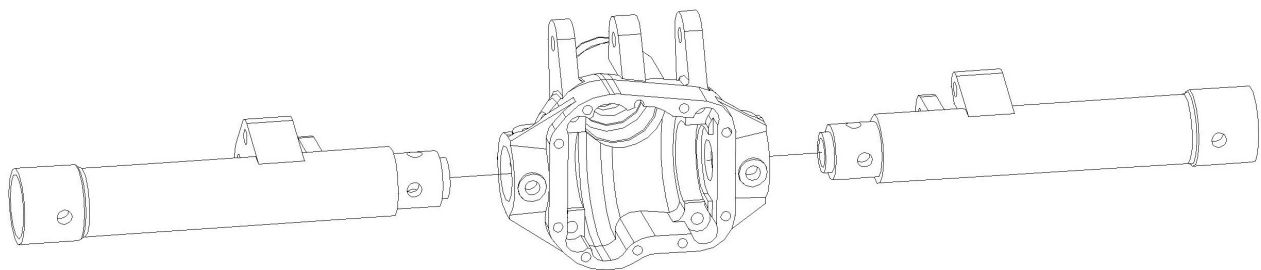

**3** Install gears in housing, apply plenty of grease to both gears

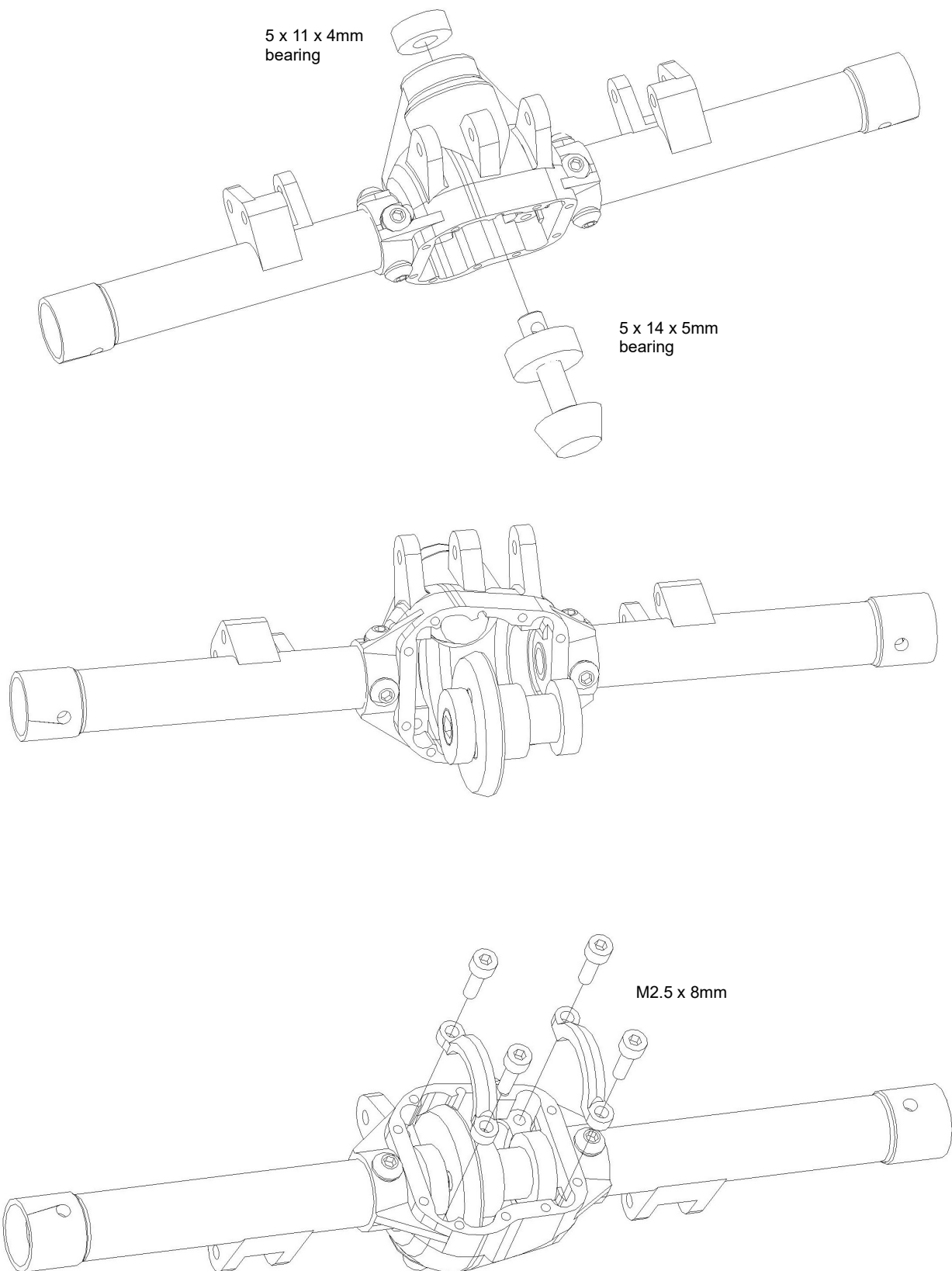



4

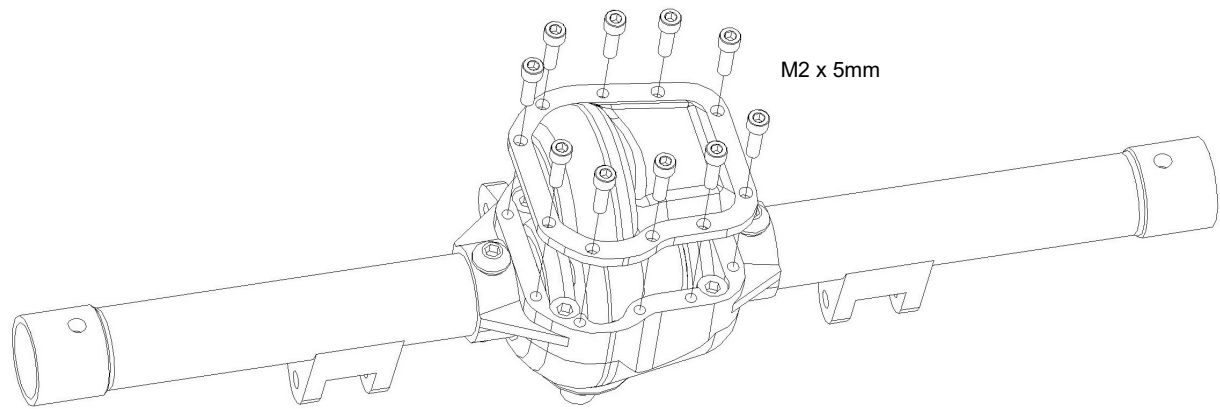

5 The next two steps should be done on both sides

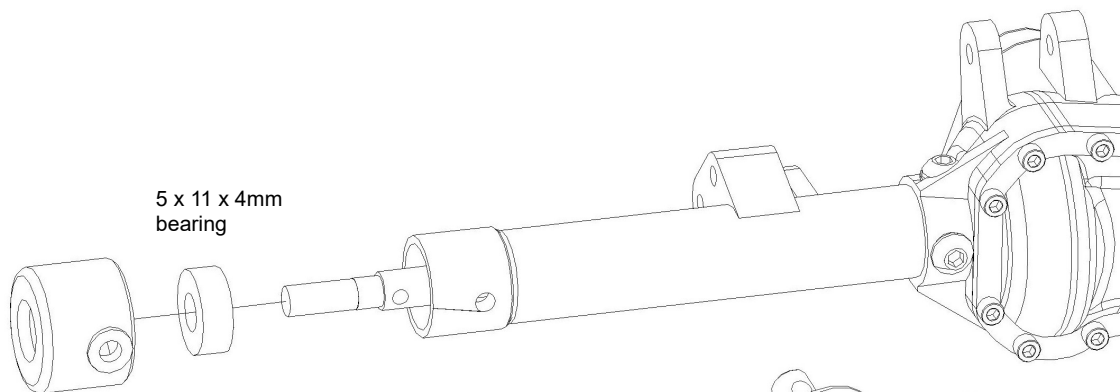
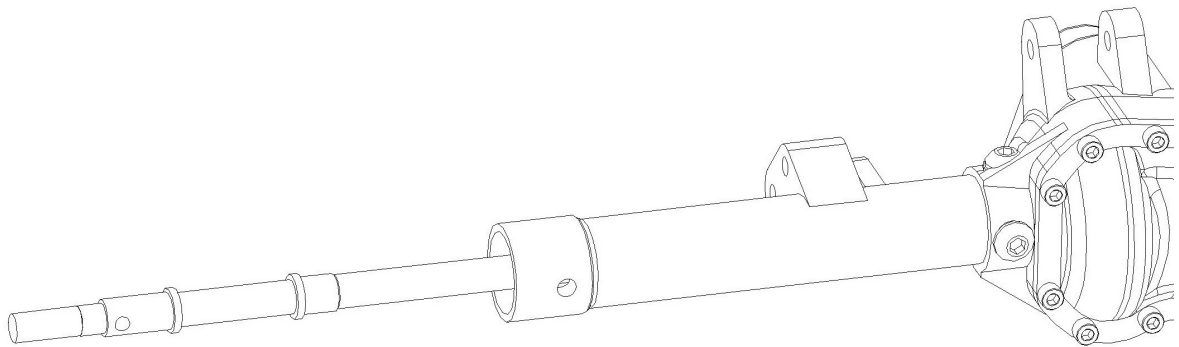

**Note:** the remaining screws from bag A will be used to attach links & shocks later

## Open Bag C – Aluminum Hex set

### 6 Insert spacers before fitting pin and hex

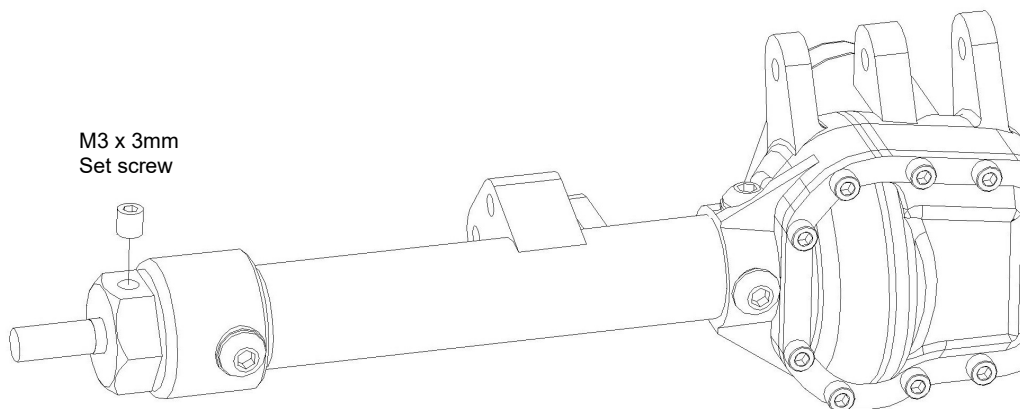
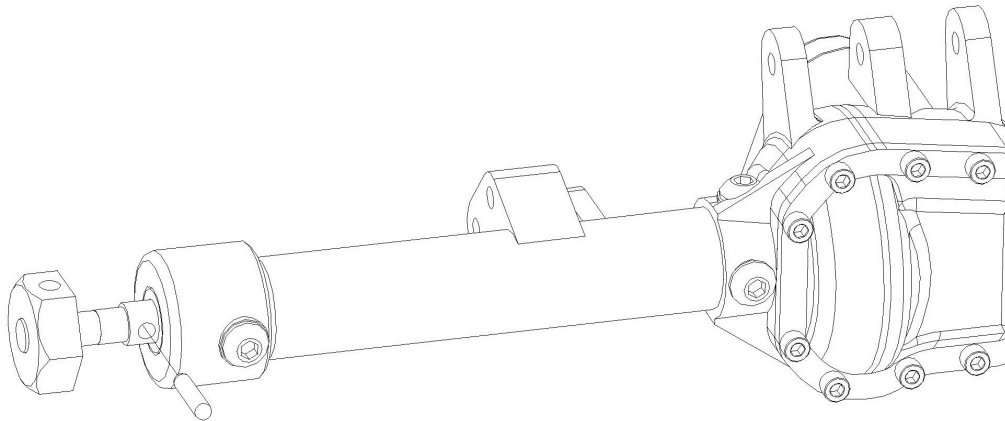
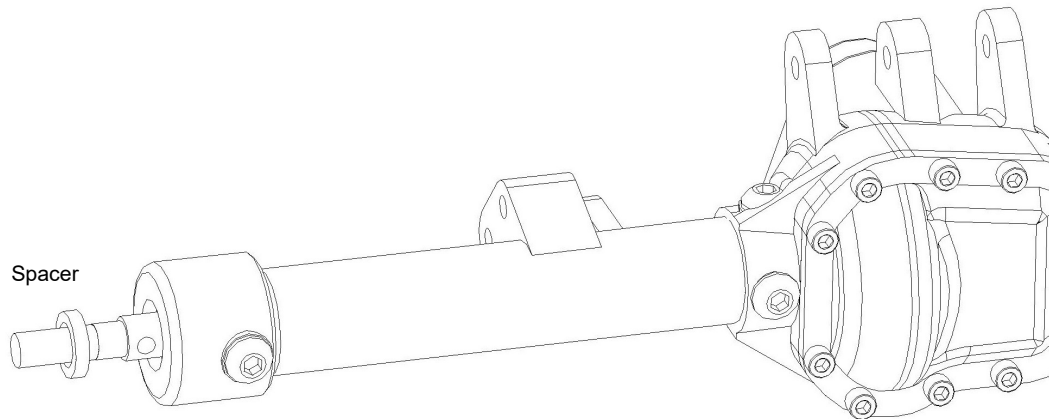

## Open Bag B – Front Axle

7 Use thread lock on screws

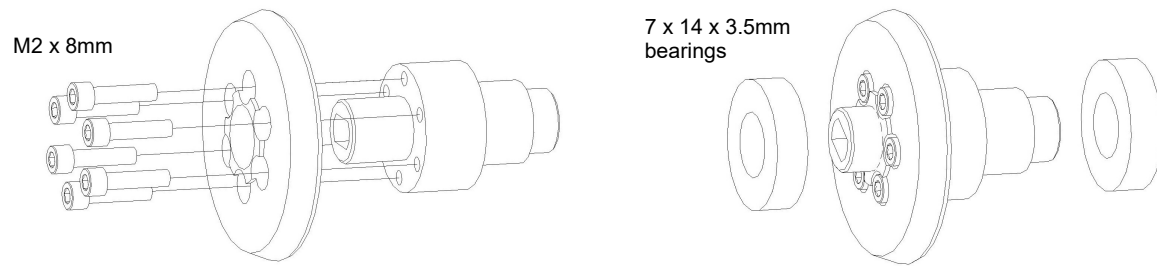

8

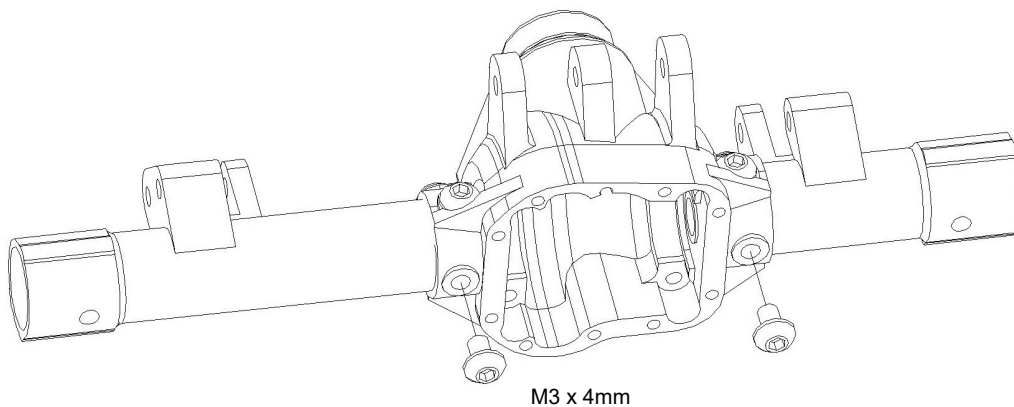
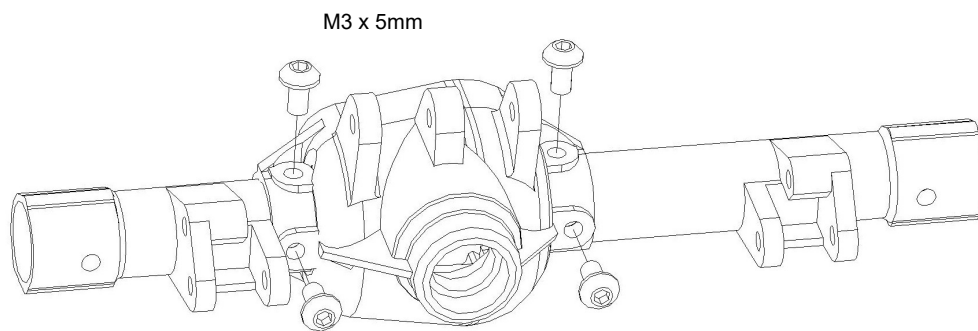
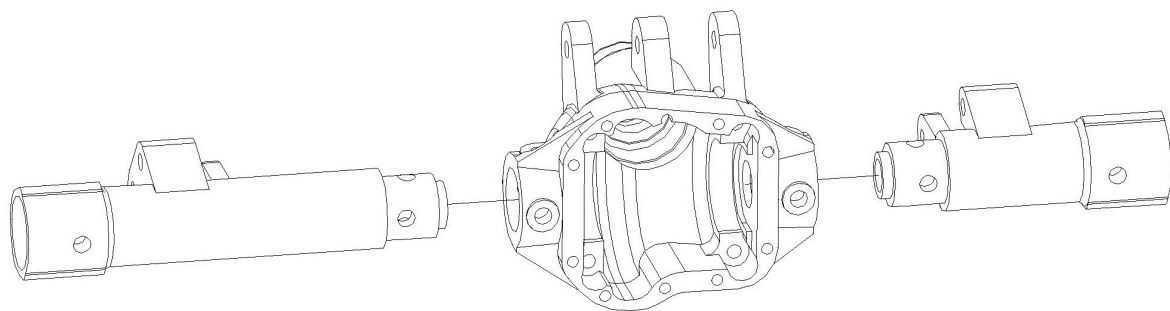

9 Install gears in housing, apply plenty of grease to both gears

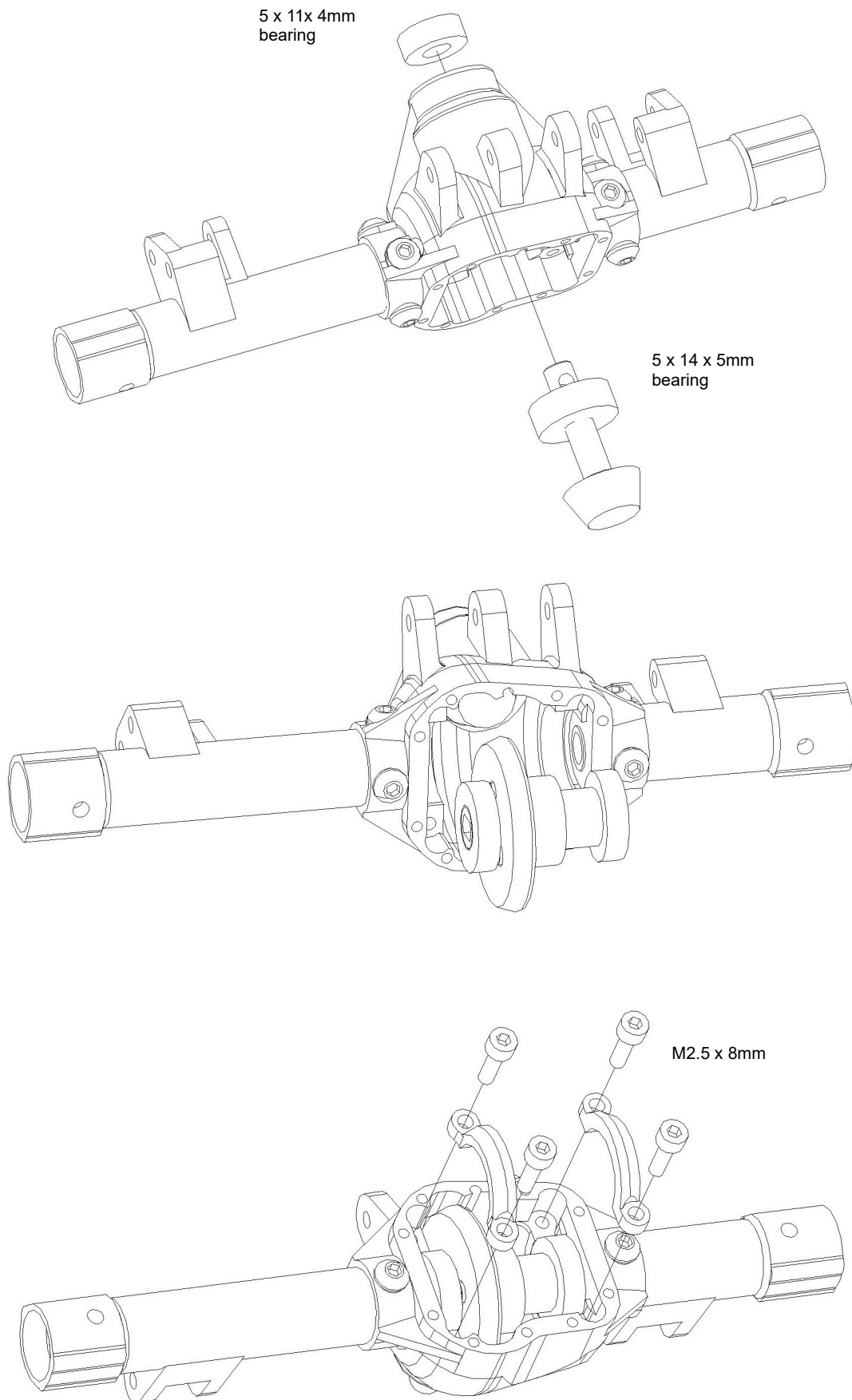

10

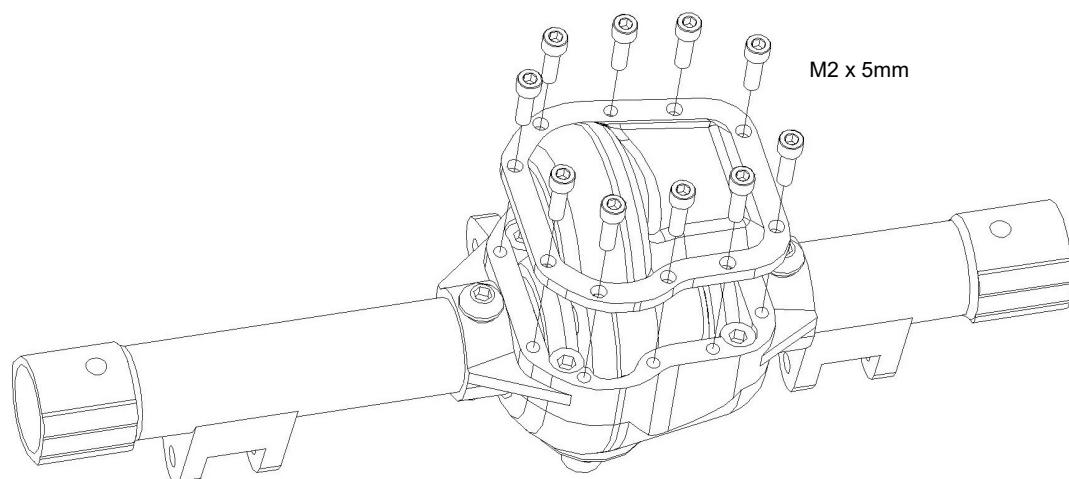

11

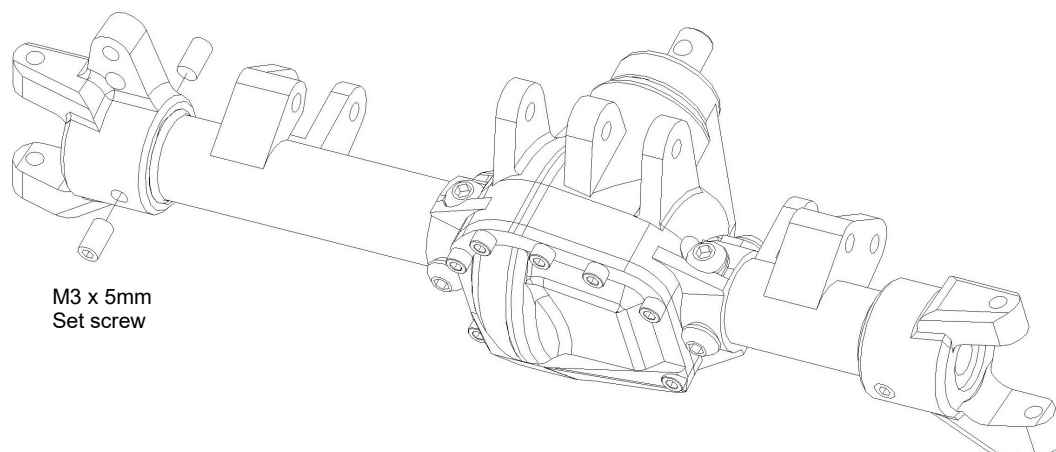
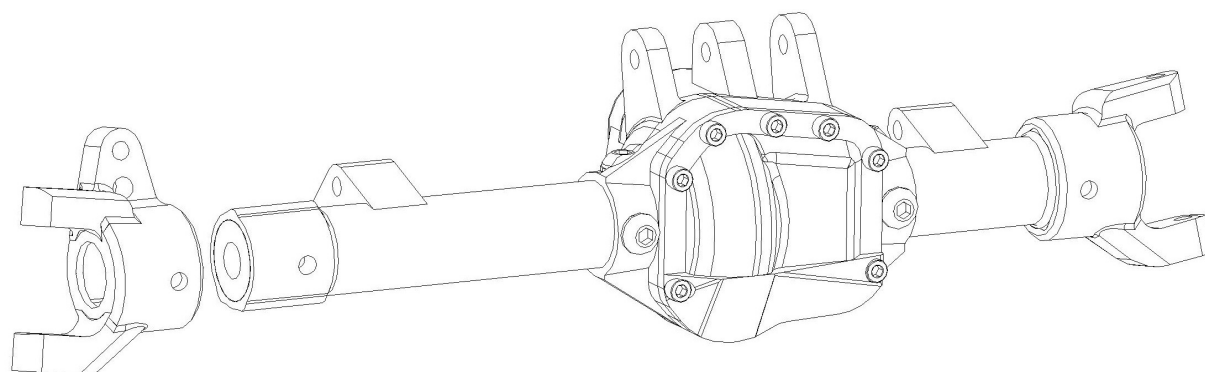
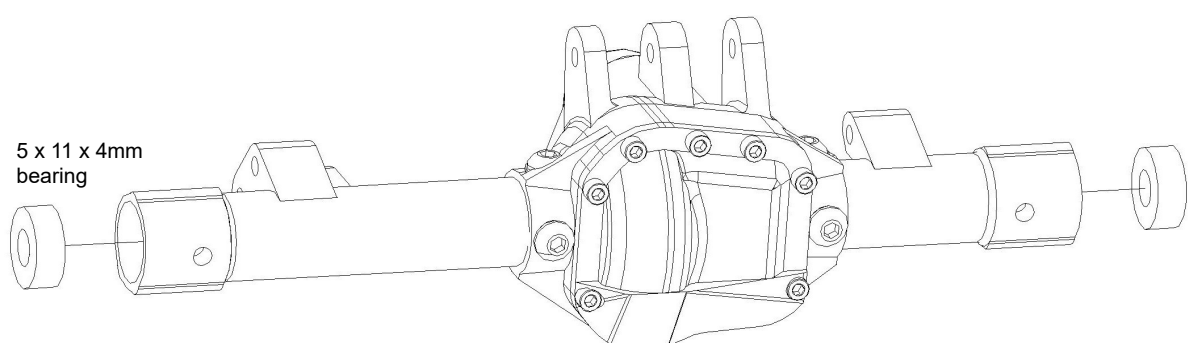

- 12 The next four steps should be done on both sides

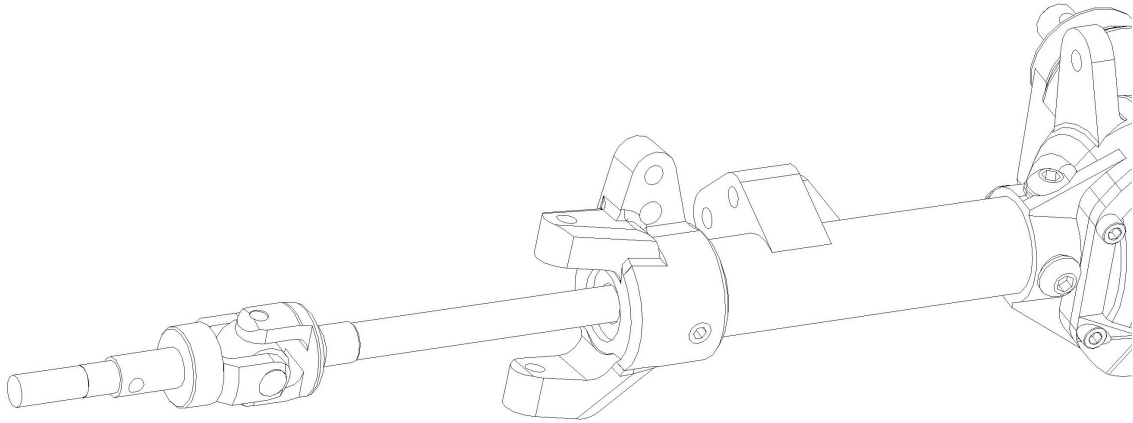

- 13 Install bearings in aluminum knuckles

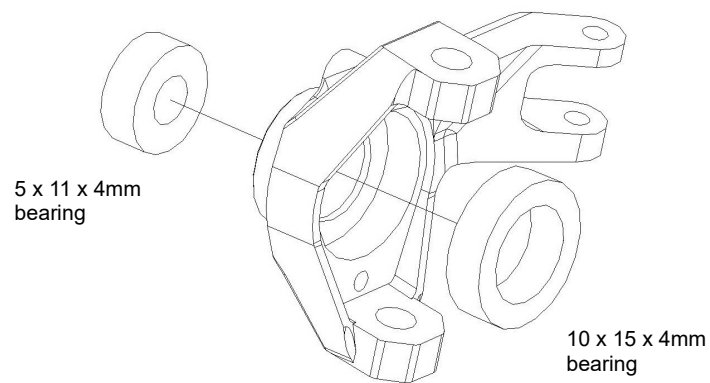

- 14 Attach knuckles to C hubs

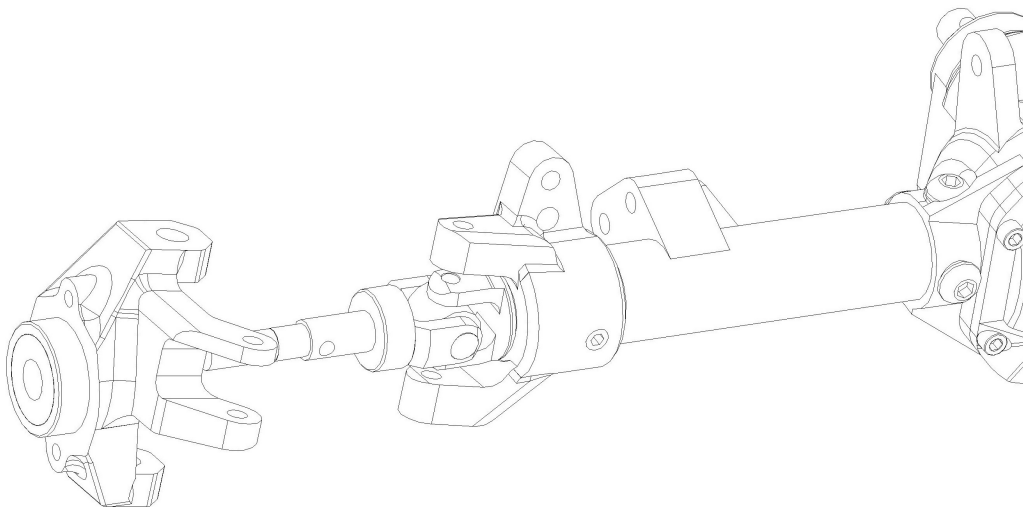

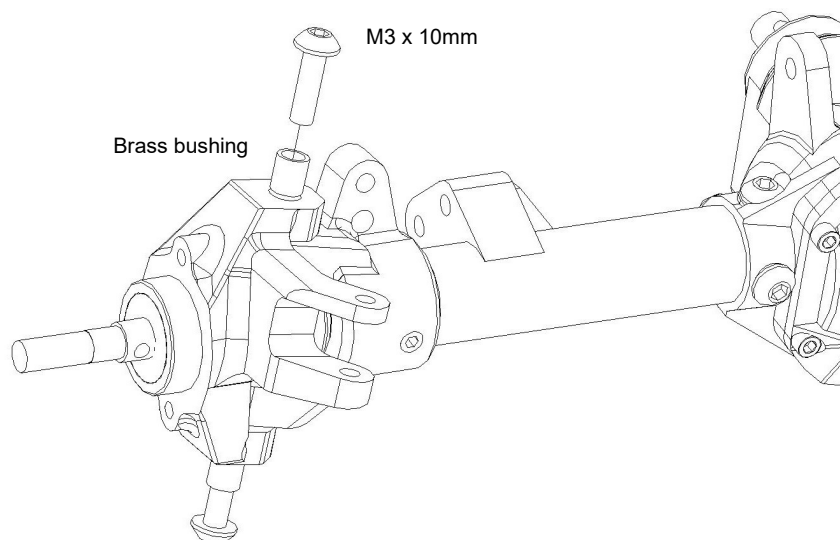

**Note:** the remaining screws from bag B will be used to attach links & shocks later

## 15 Install Hex from bag C

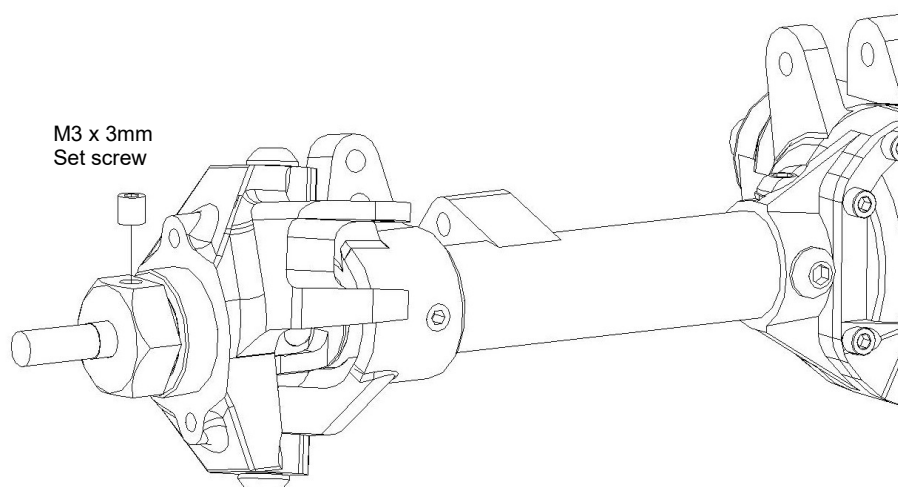
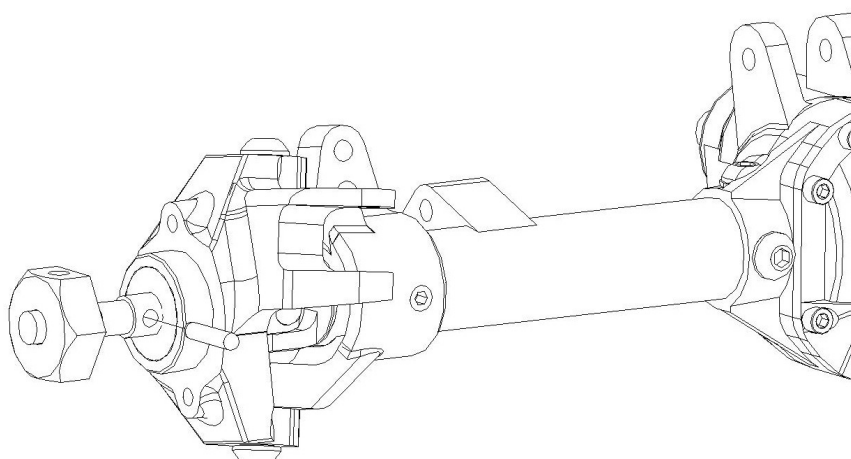

## Open Bag D – Transmission

- 16 Install motor (not included) on aluminum mount and 16T pinion gear on motor shaft

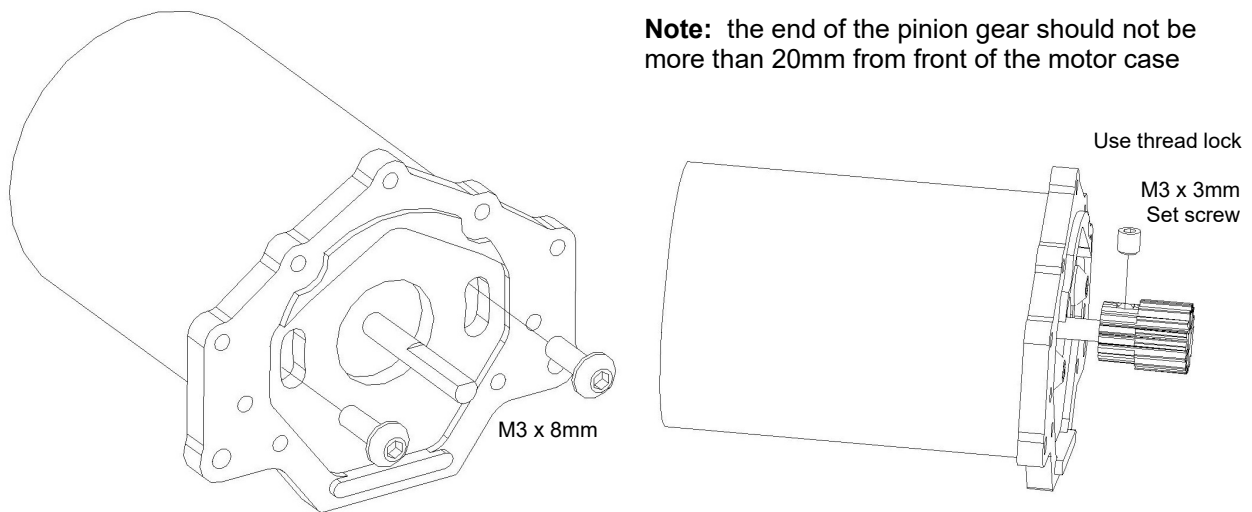

17

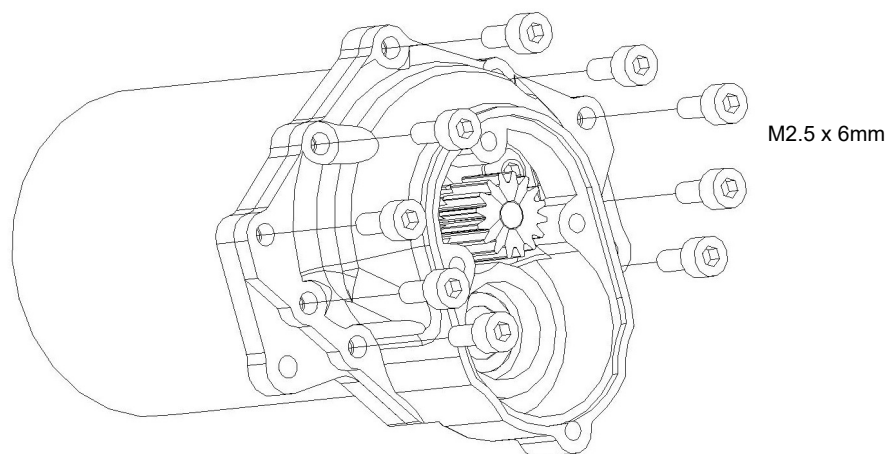

- 18 Apply plenty of grease to all gears during transmission assembly

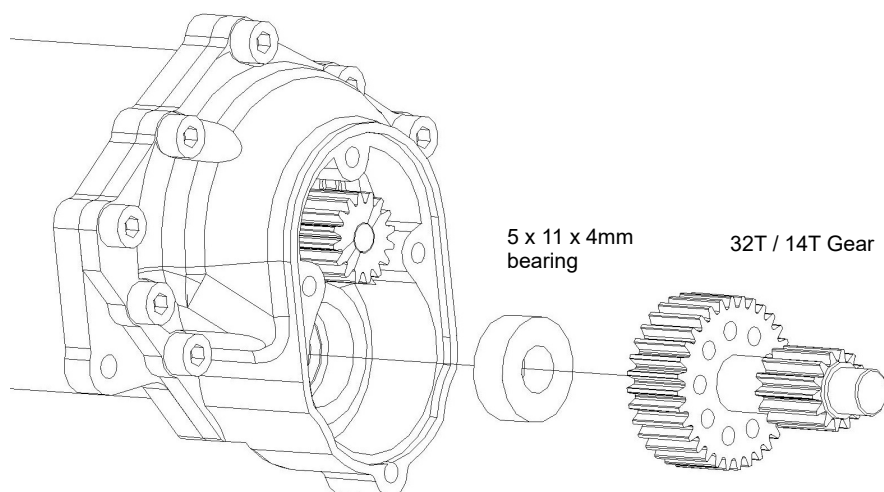



19

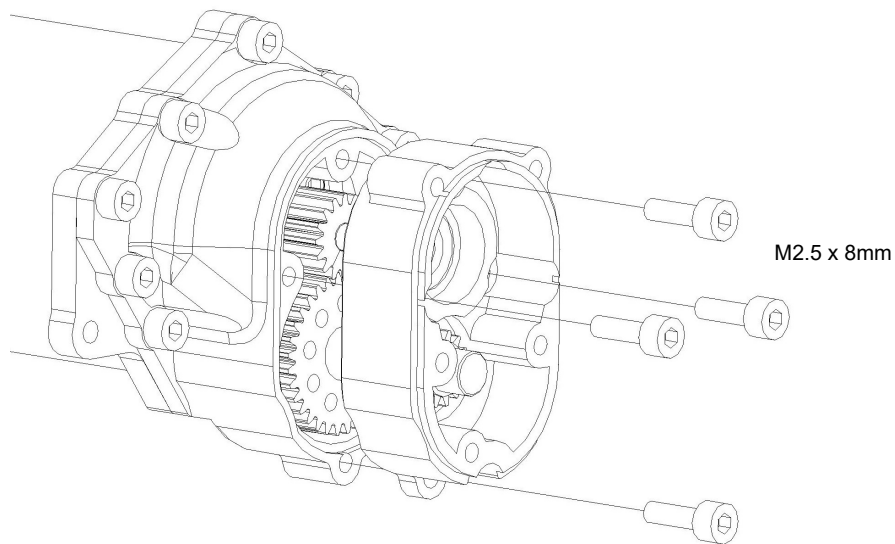

20

34T Gear

14T Gear shaft

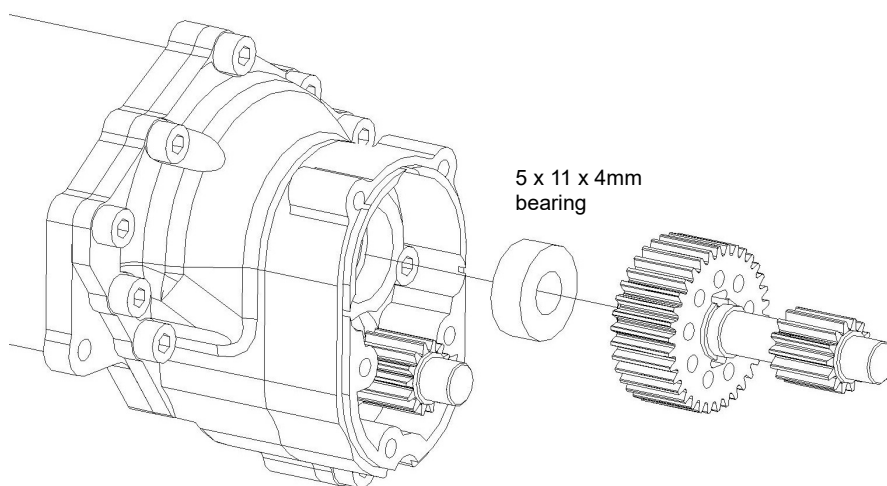
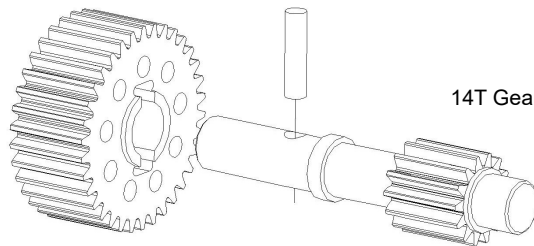

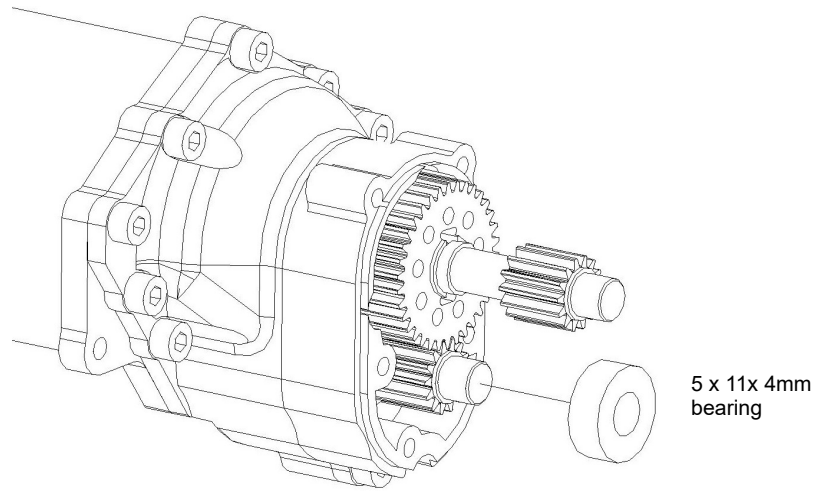

21

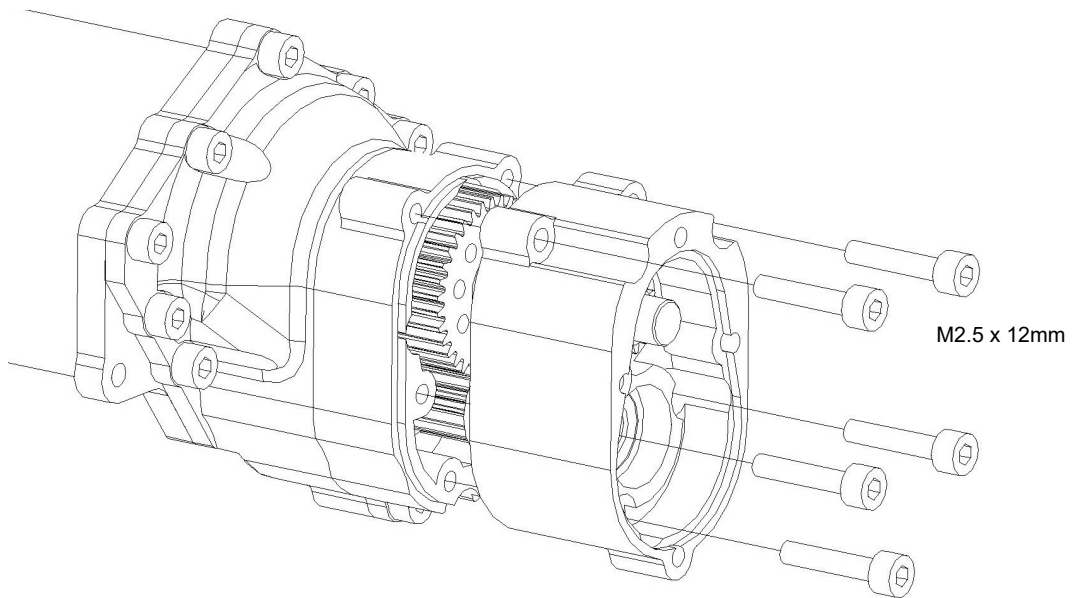

22

34T Gear

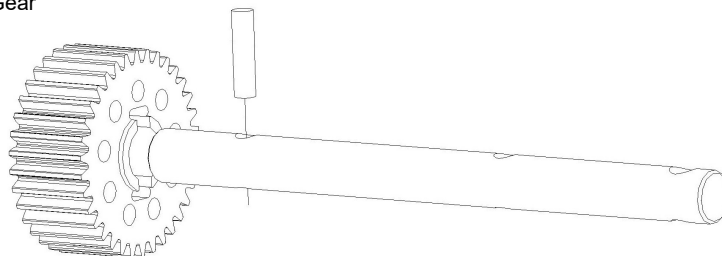

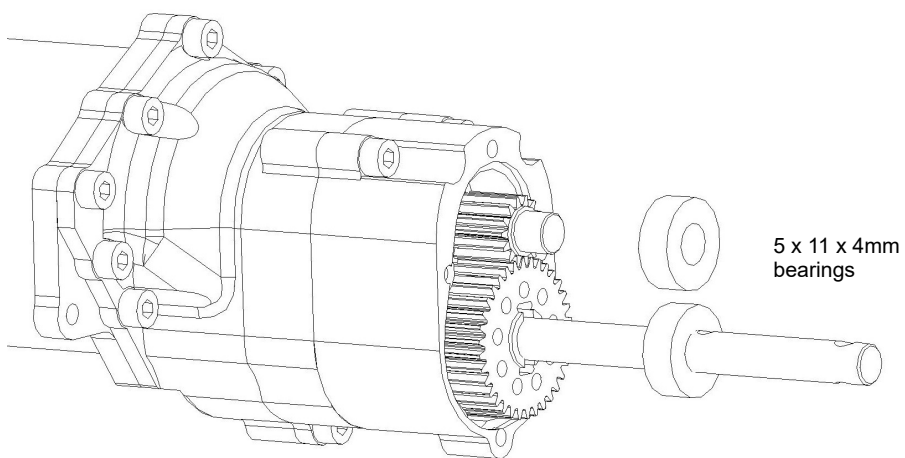
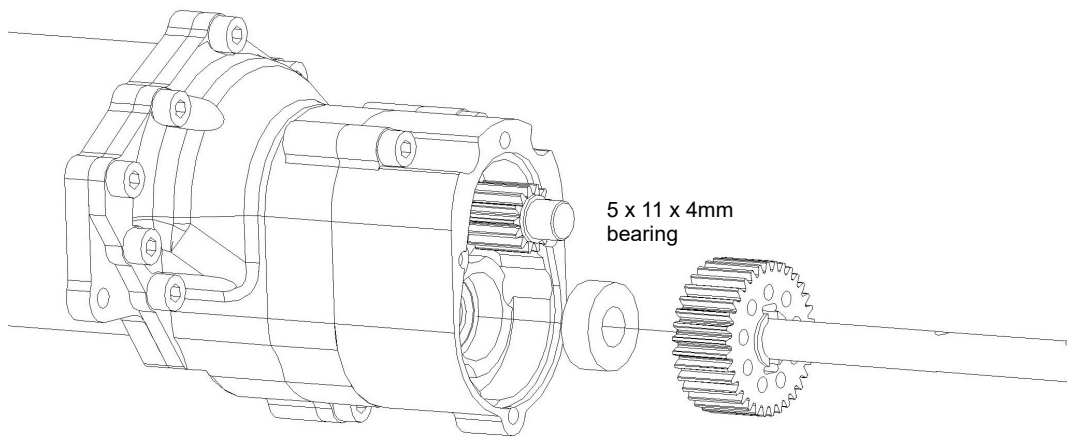

23

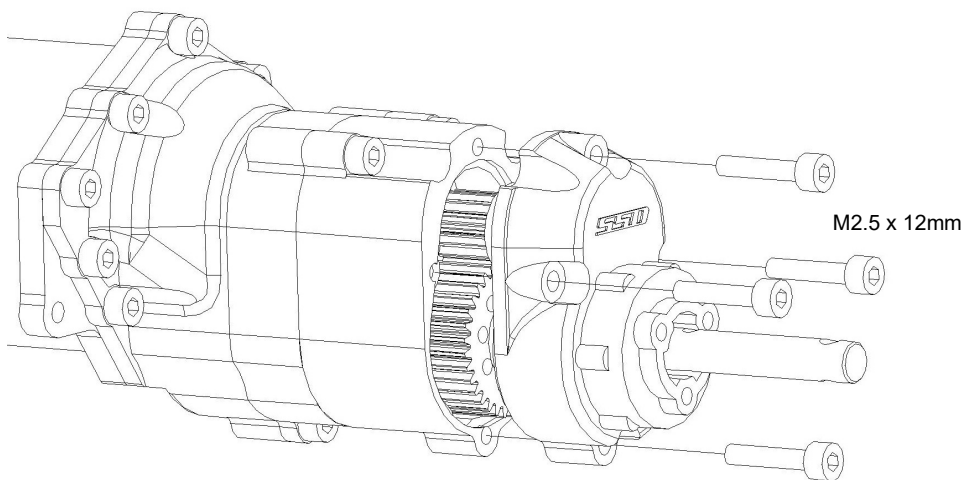

## Open Bag G – Transmission Mounts

24

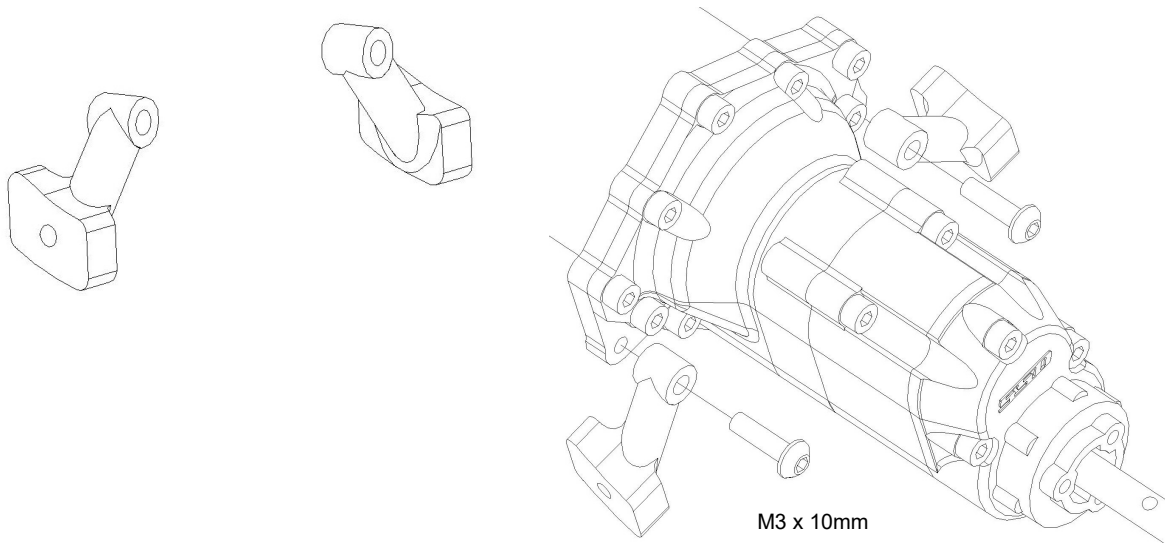

25 Transfer case

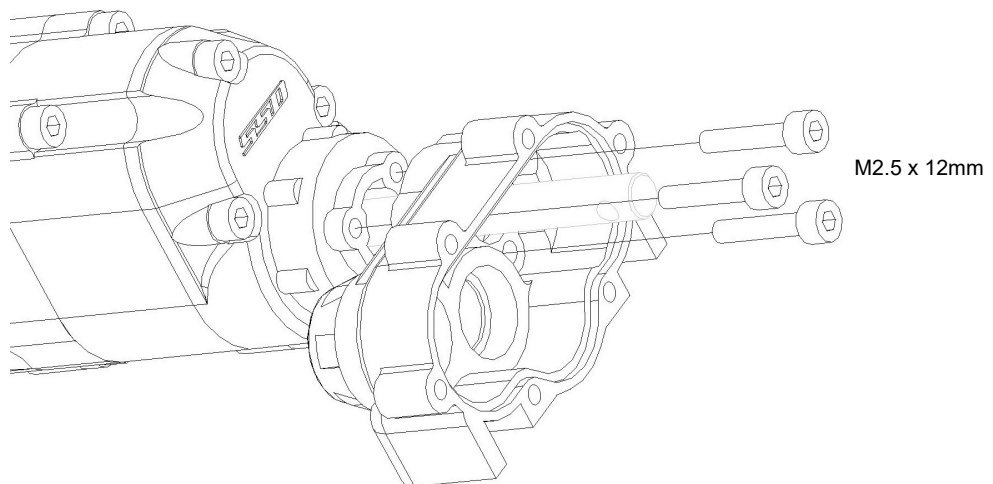

26

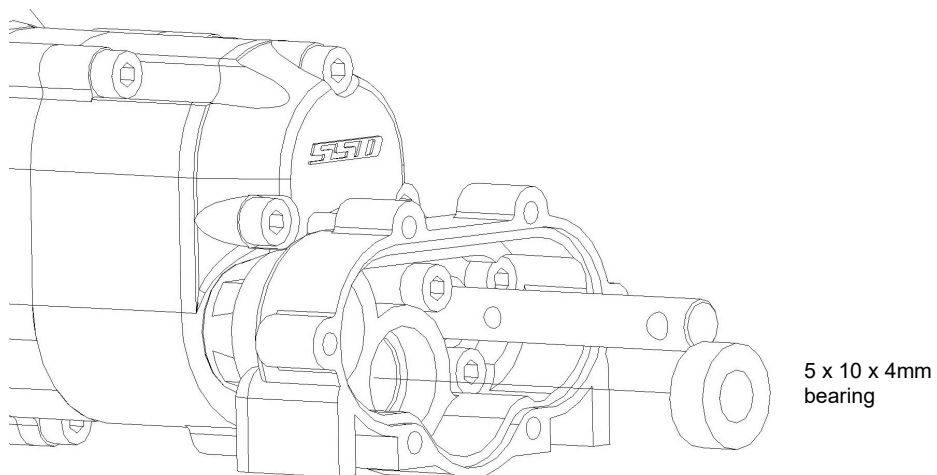

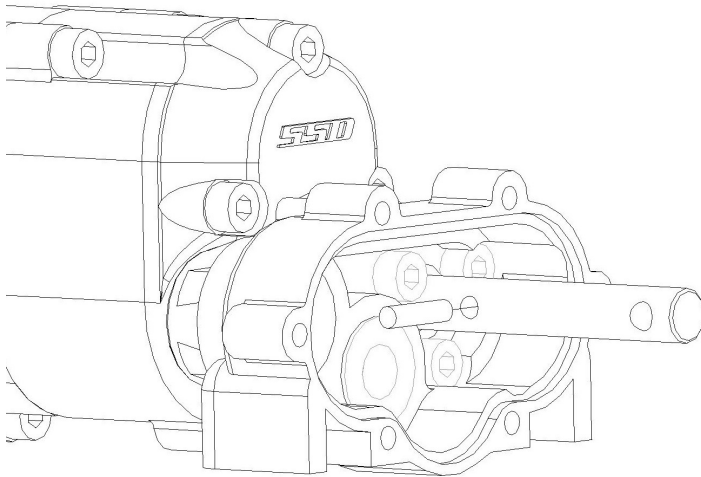

Apply plenty of grease to all gears

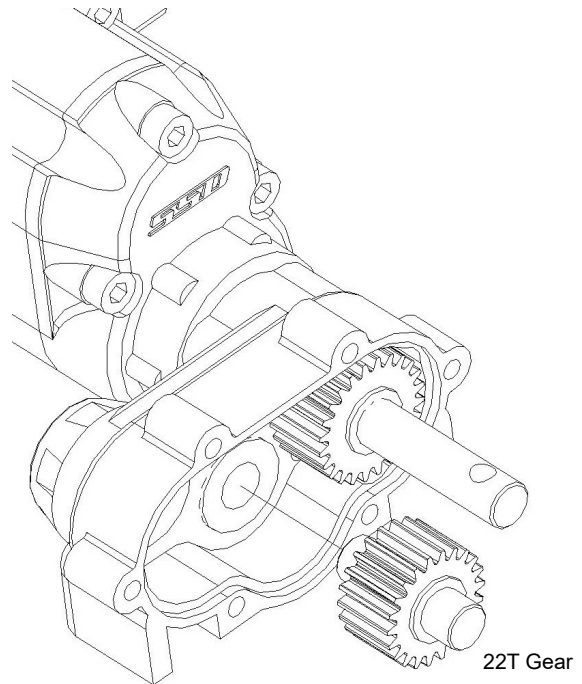
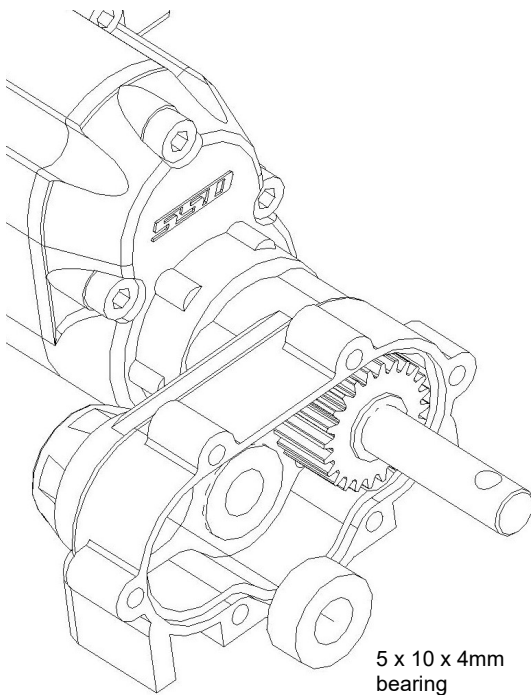
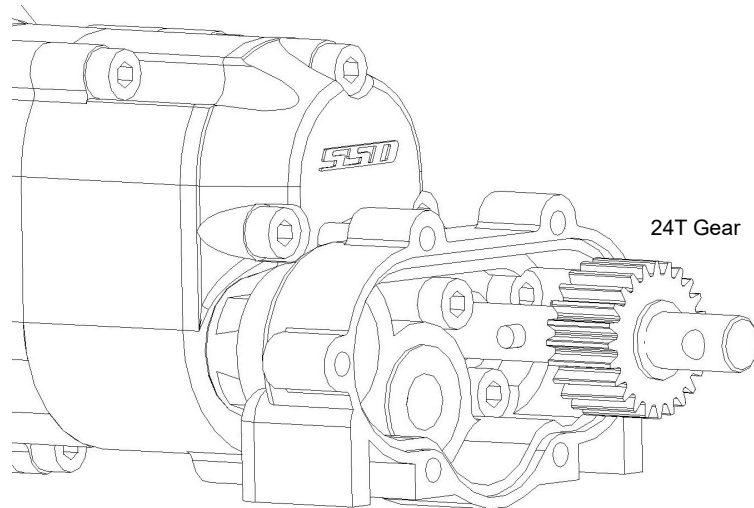

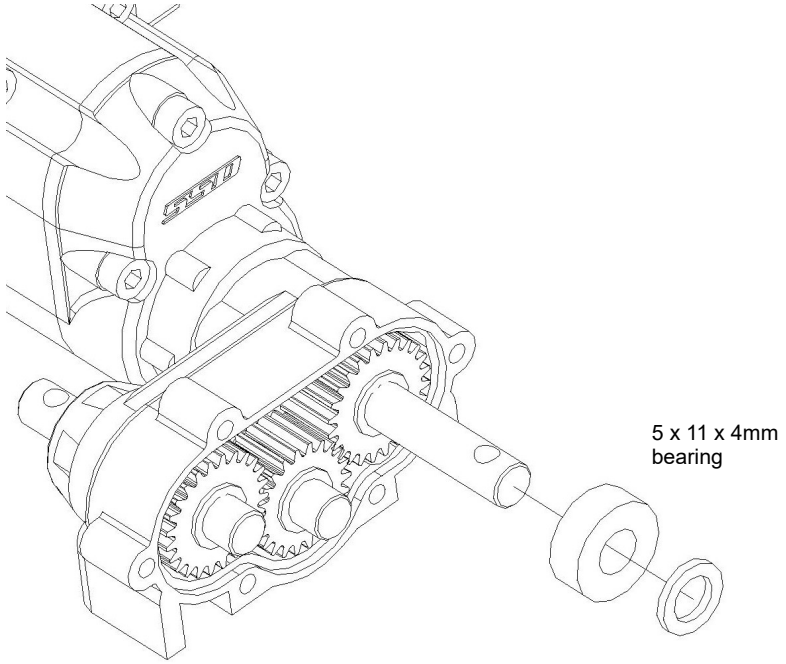
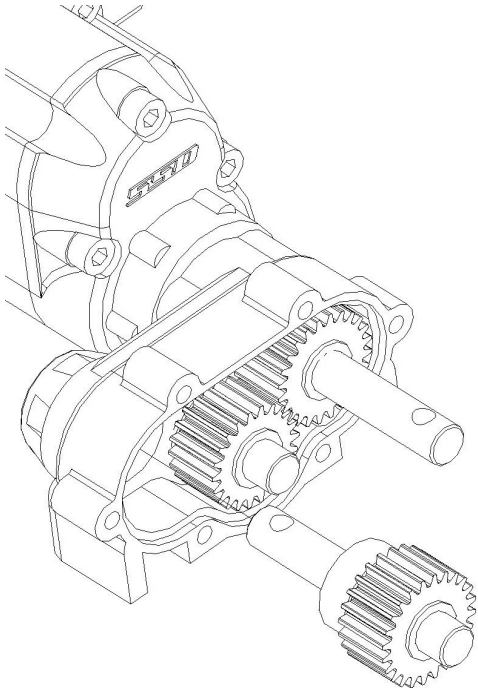
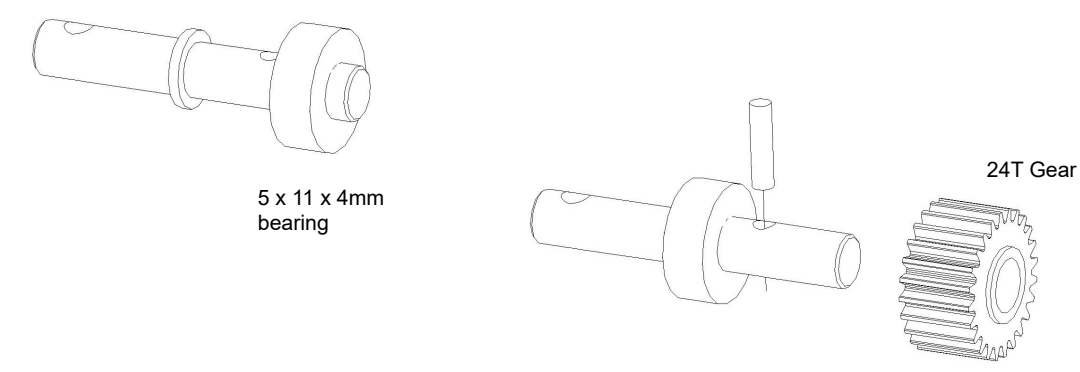

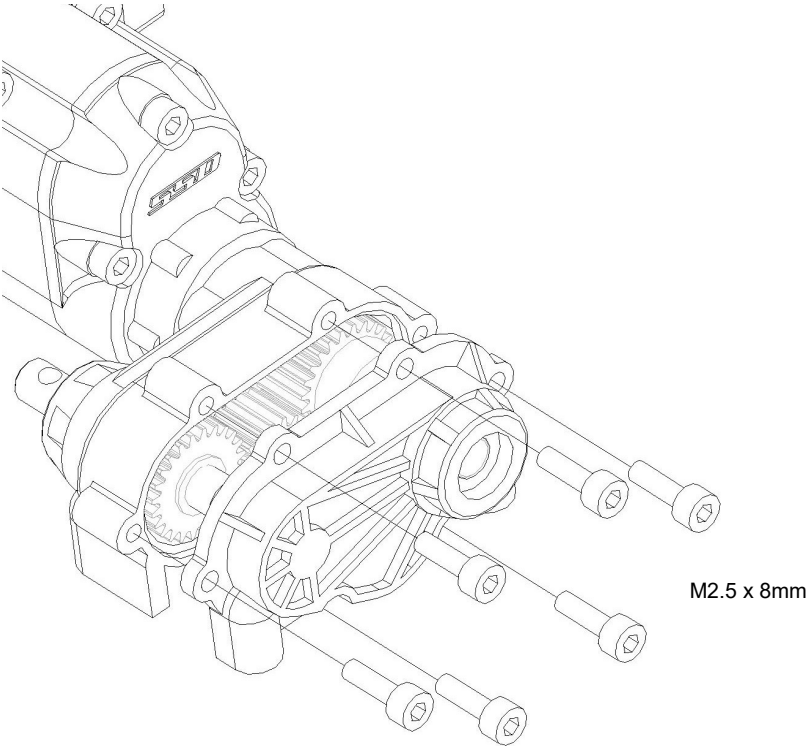
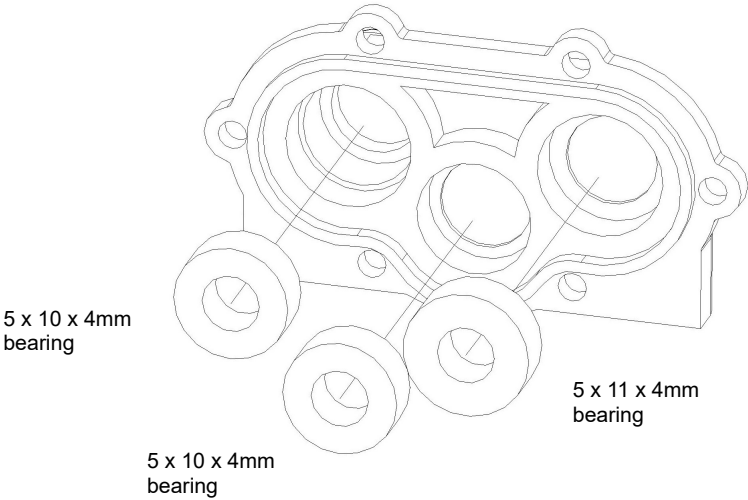

## Open Bag E - Titanium Suspension Links

### 30 Front upper link

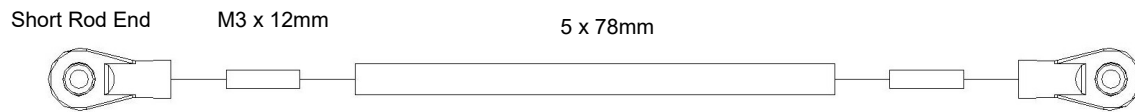

### 31 Front lower links, make 2

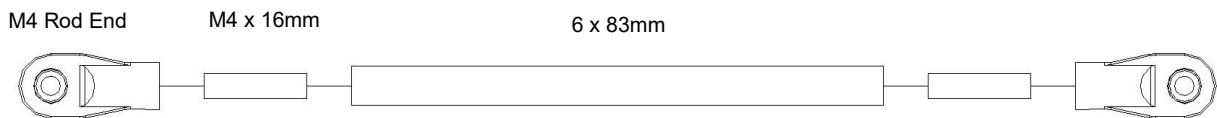

### 32 Rear upper links, make 2

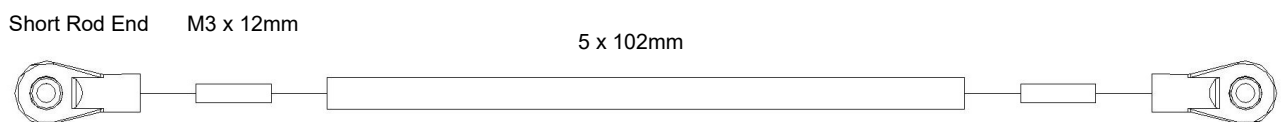

### 33 Rear lower links, make 2

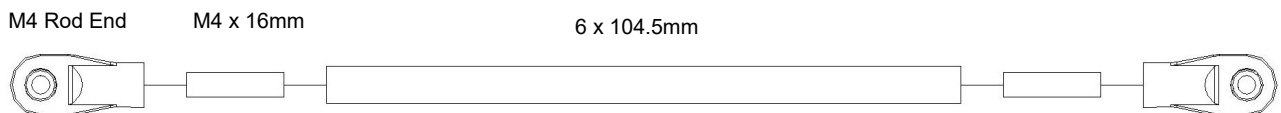

### 34 Panhard bar

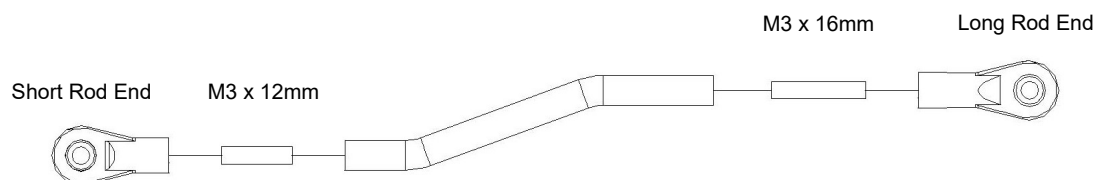



# Open Bag F - Titanium Steering Links

## 35 Drag link

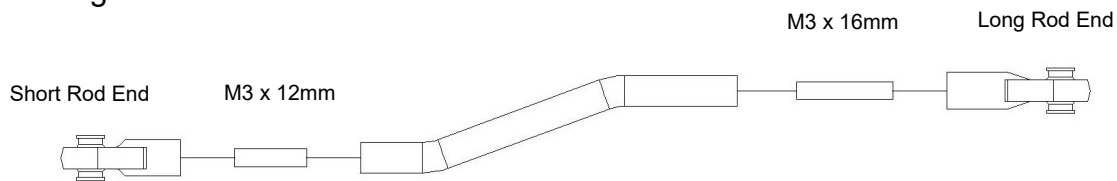

## Tie rod

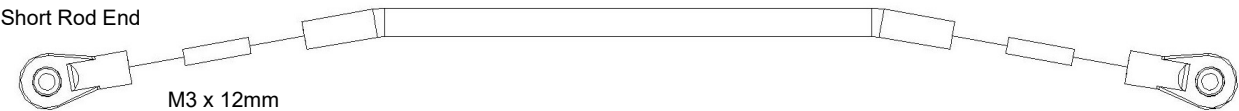

## 36

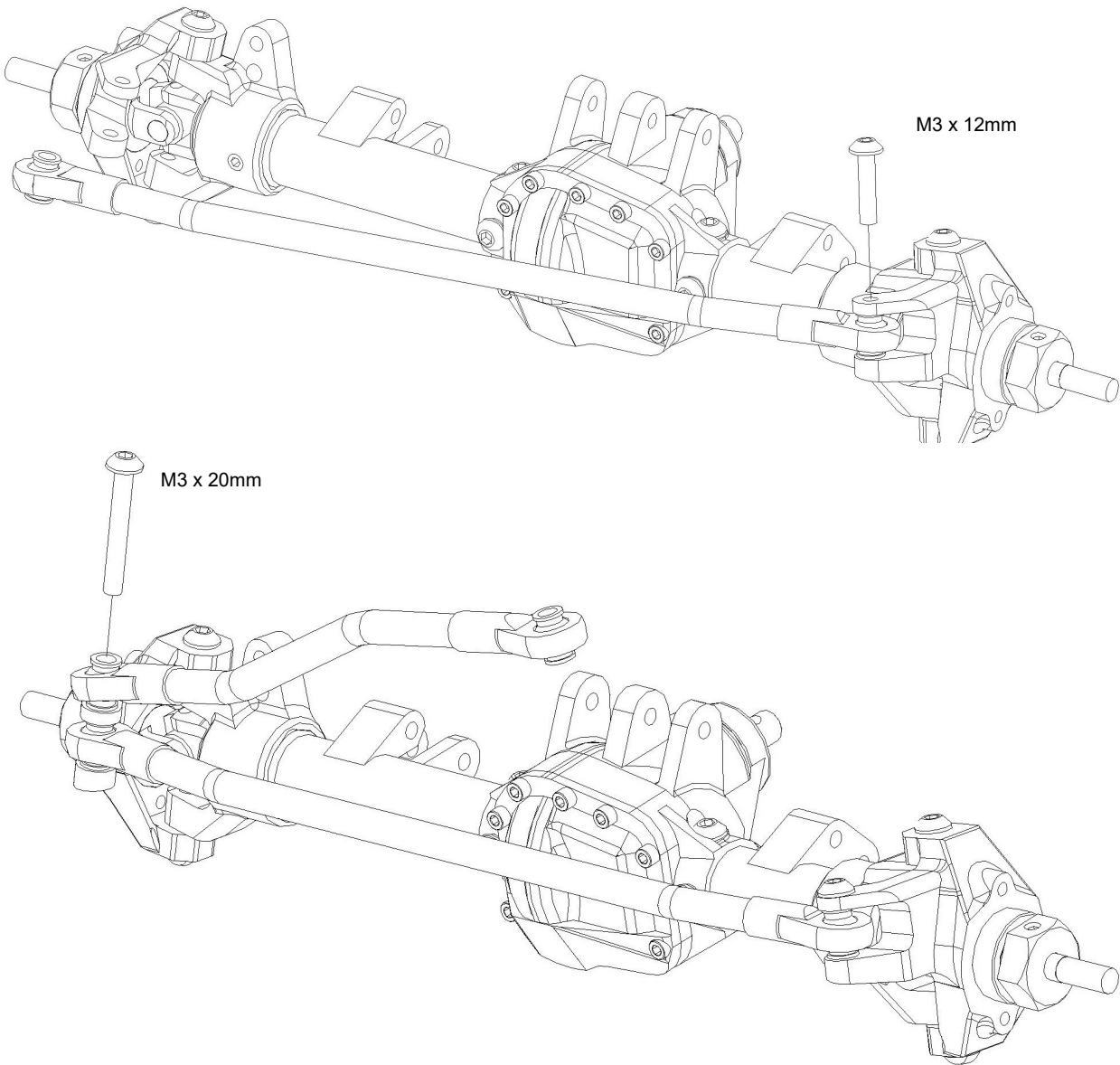

**Open Bag H – Steel Frame Rails**  
**Open Bag J – Plastic Parts**  
**Open Bag K – Aluminum parts**

**37** Aluminum panhard mount

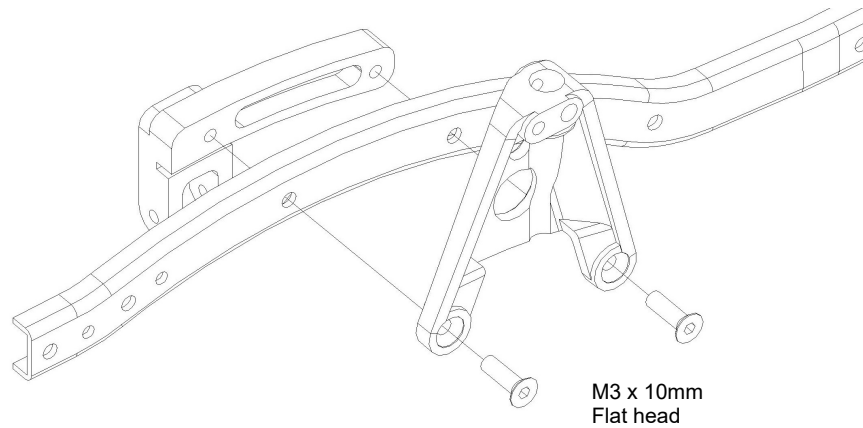

**38**

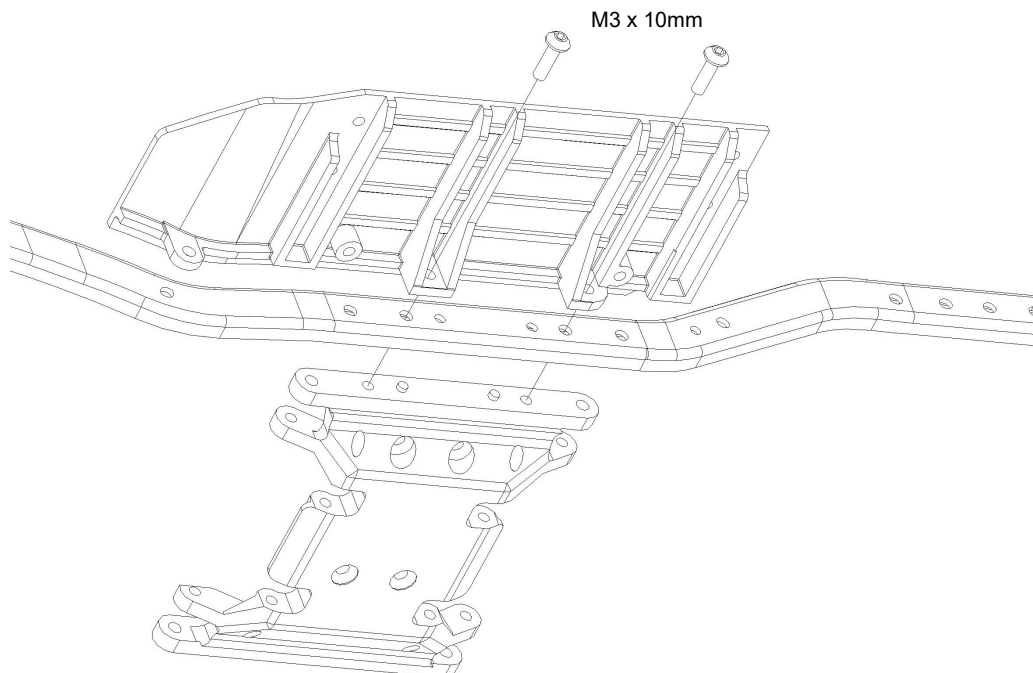

39

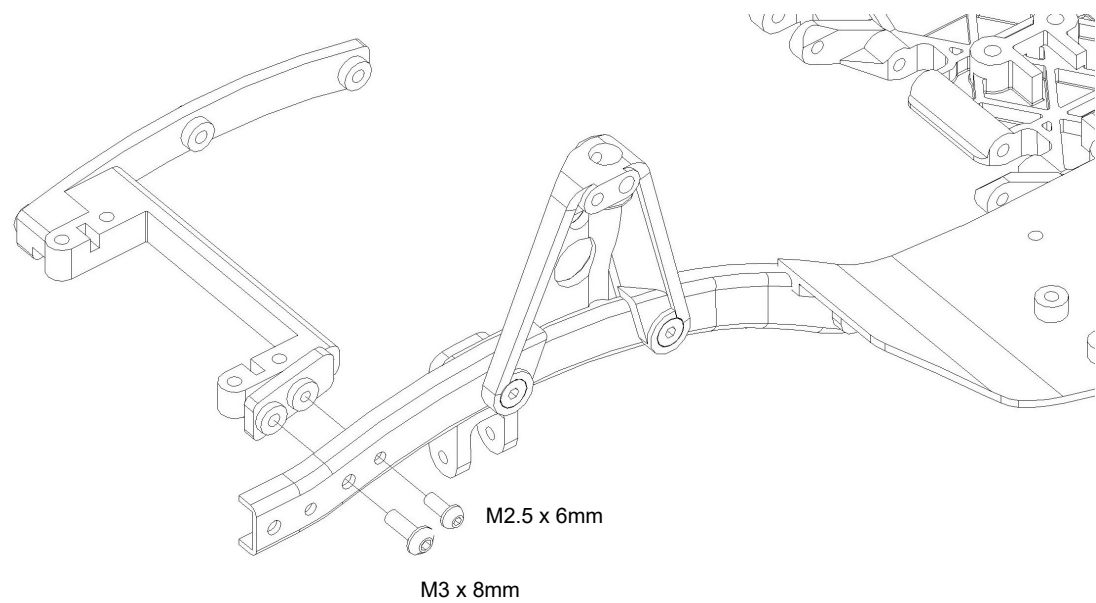

40

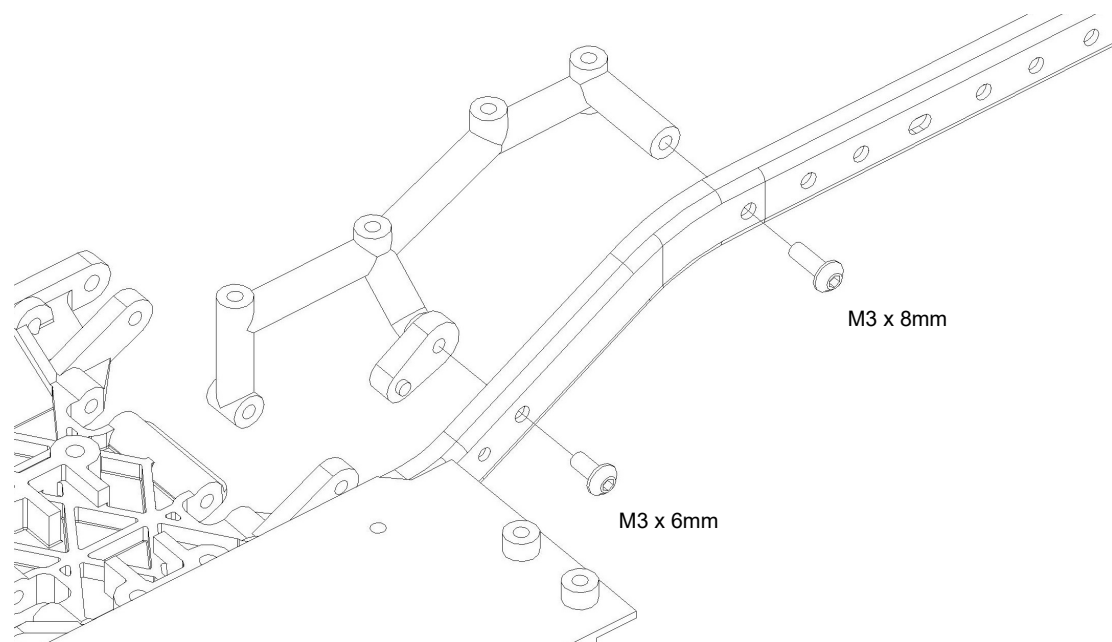

41

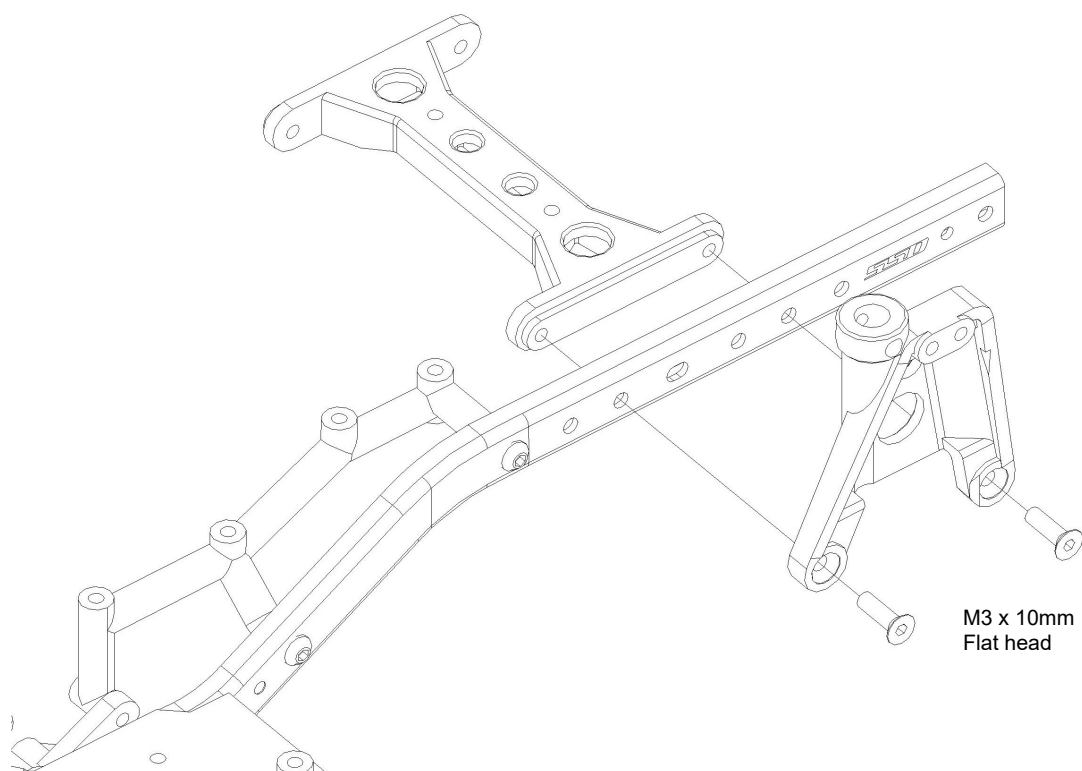

## 42 Transmission

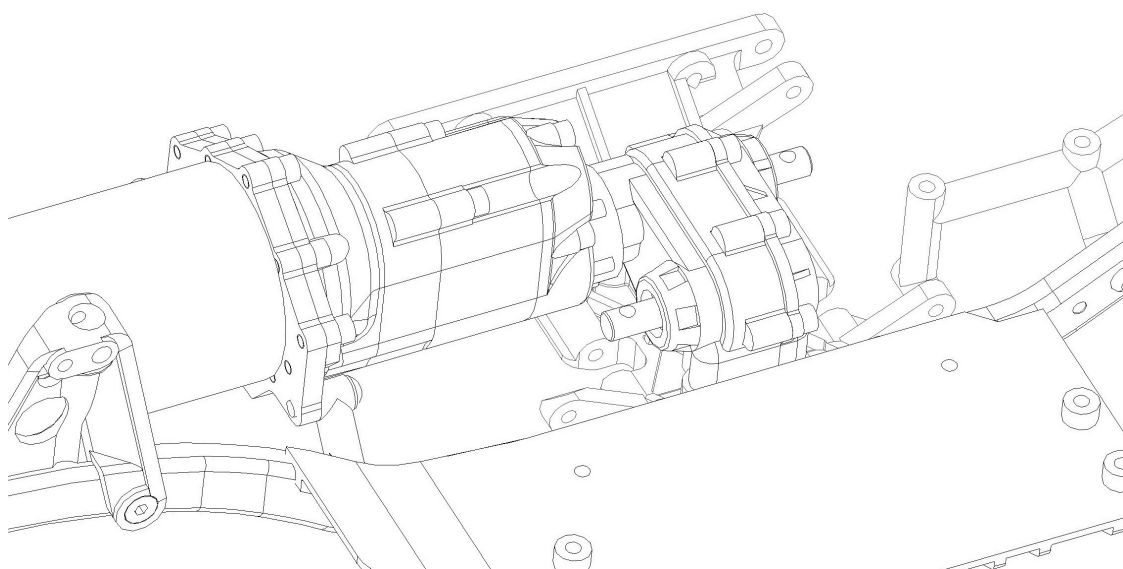

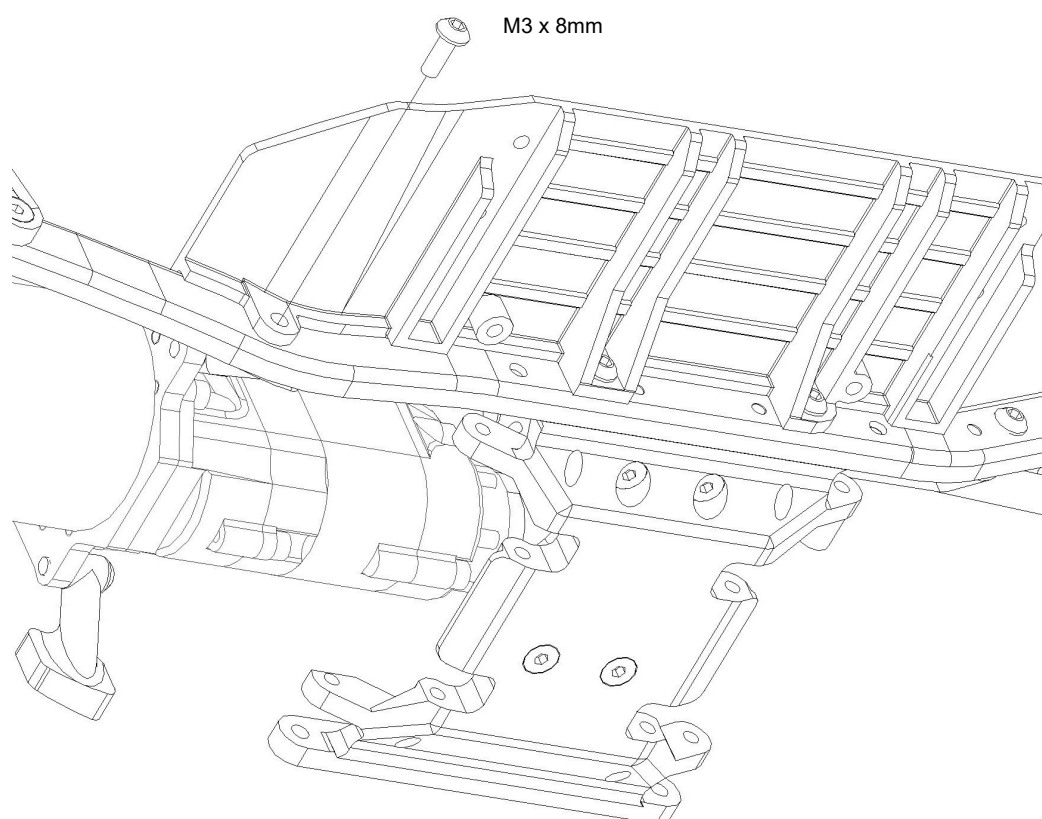
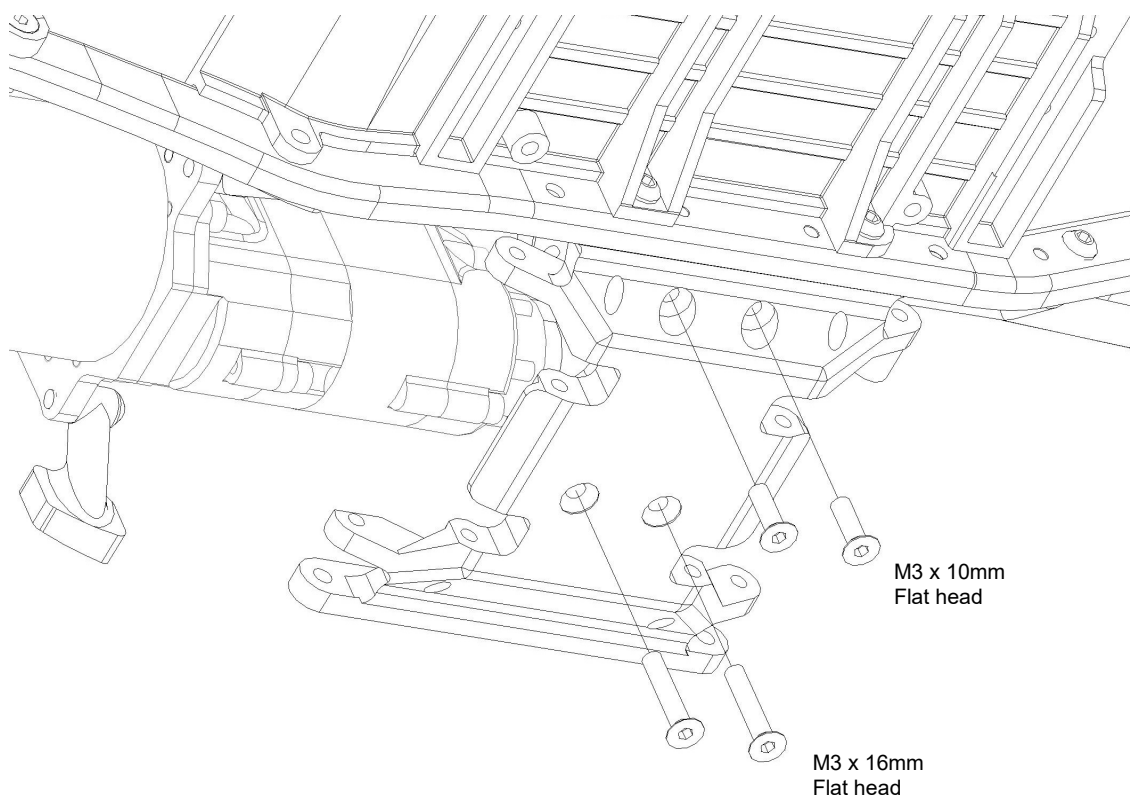

43

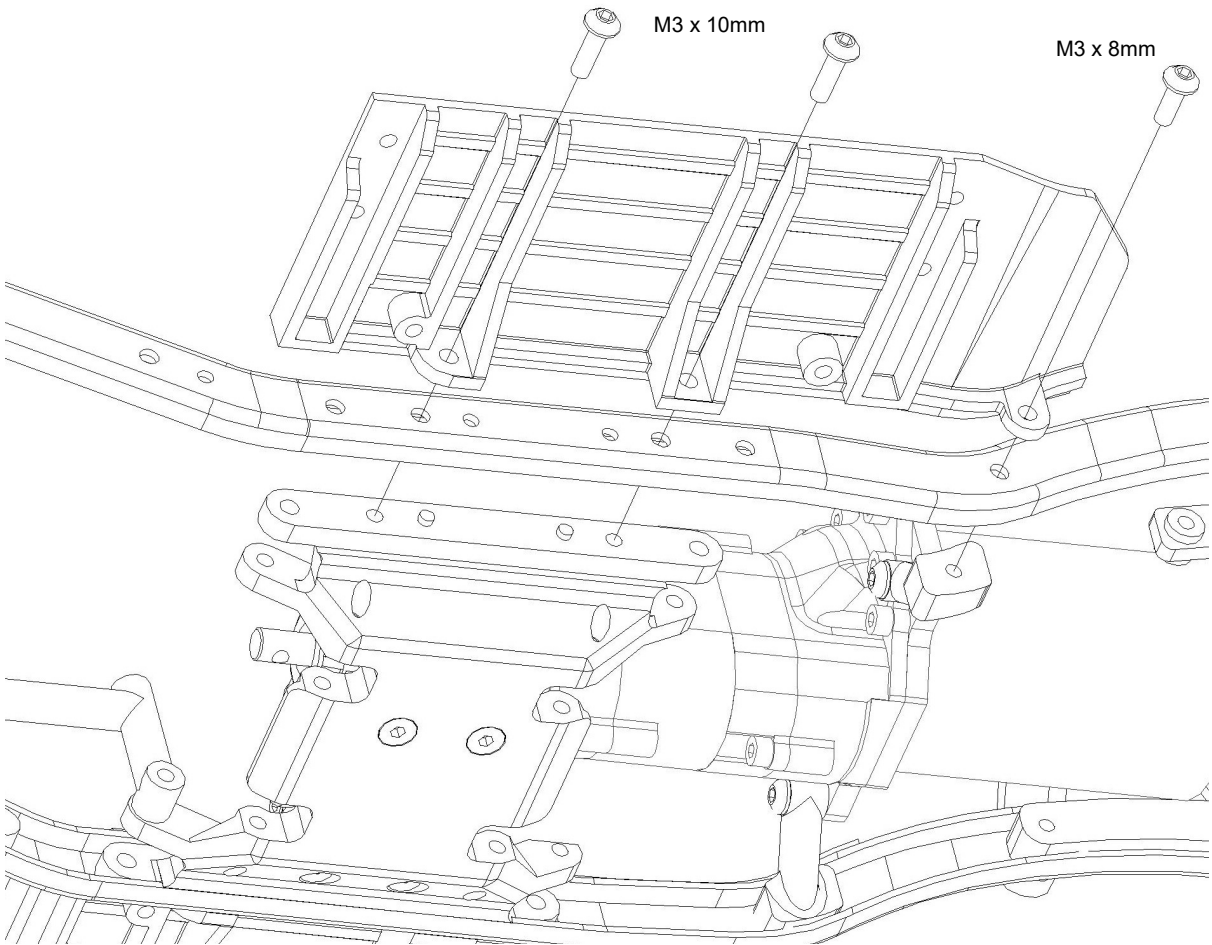

44

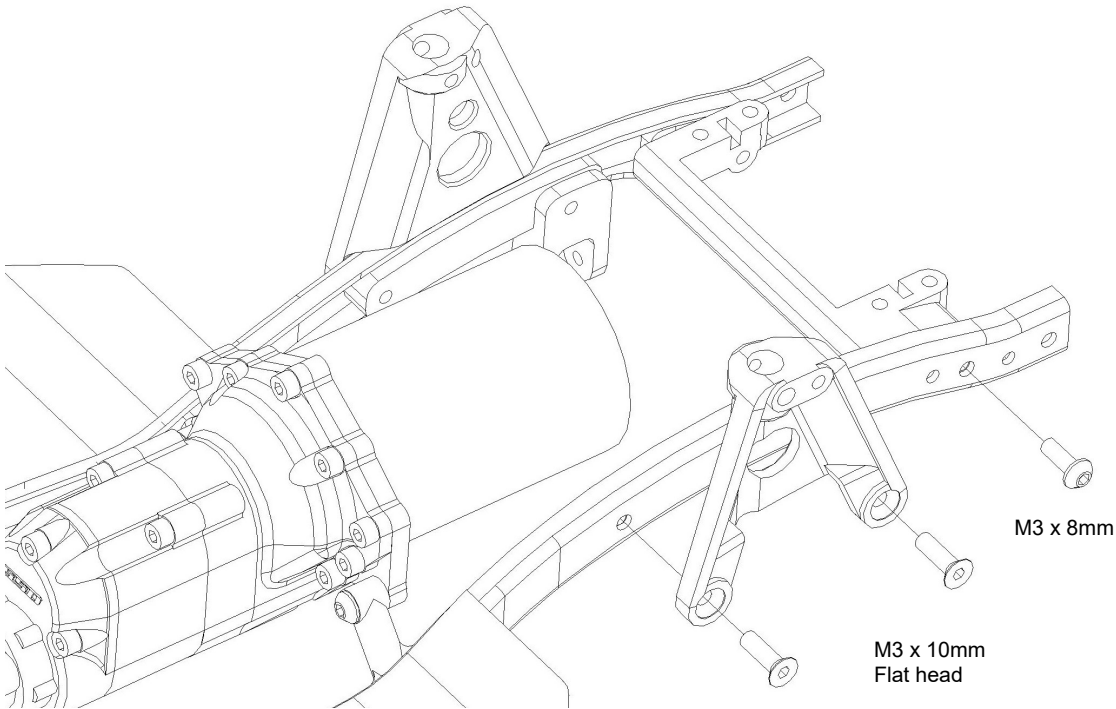

45

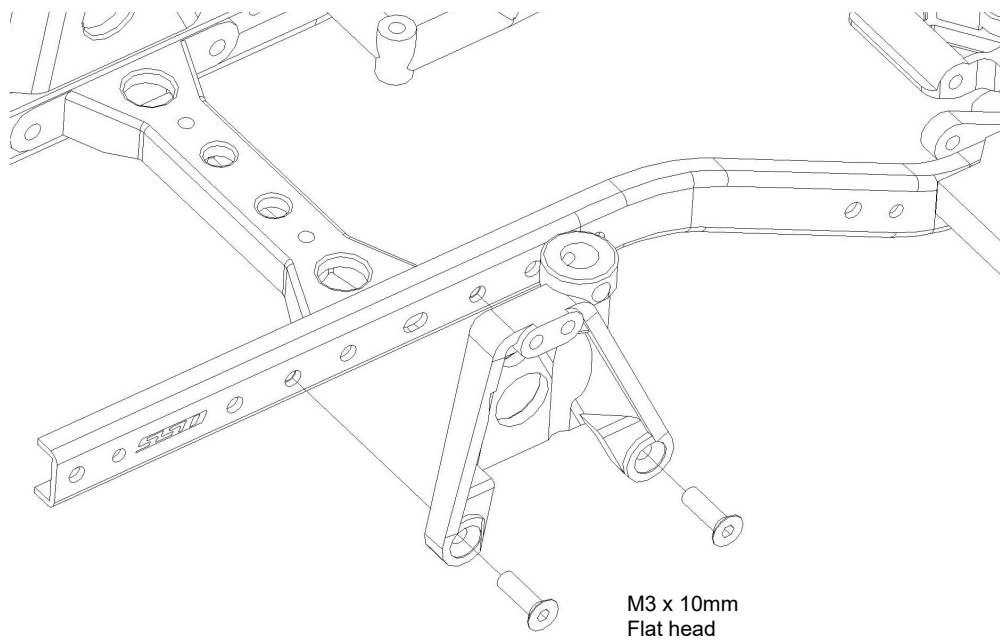

46

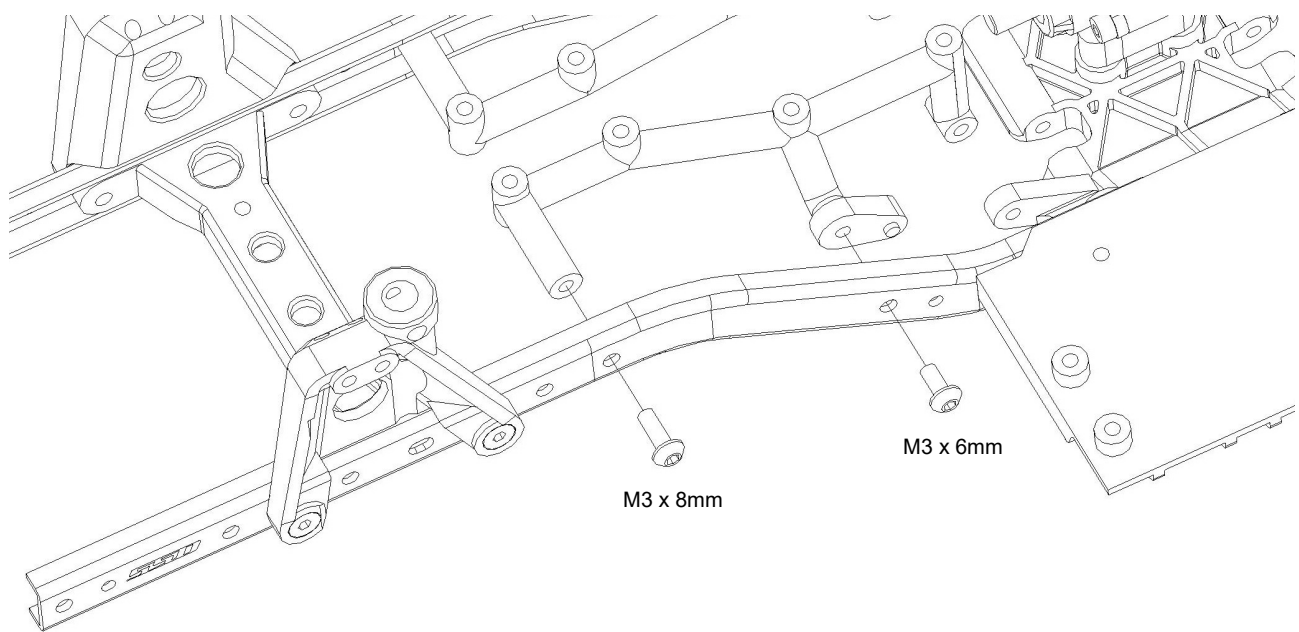

47 Aluminum front bumper mount

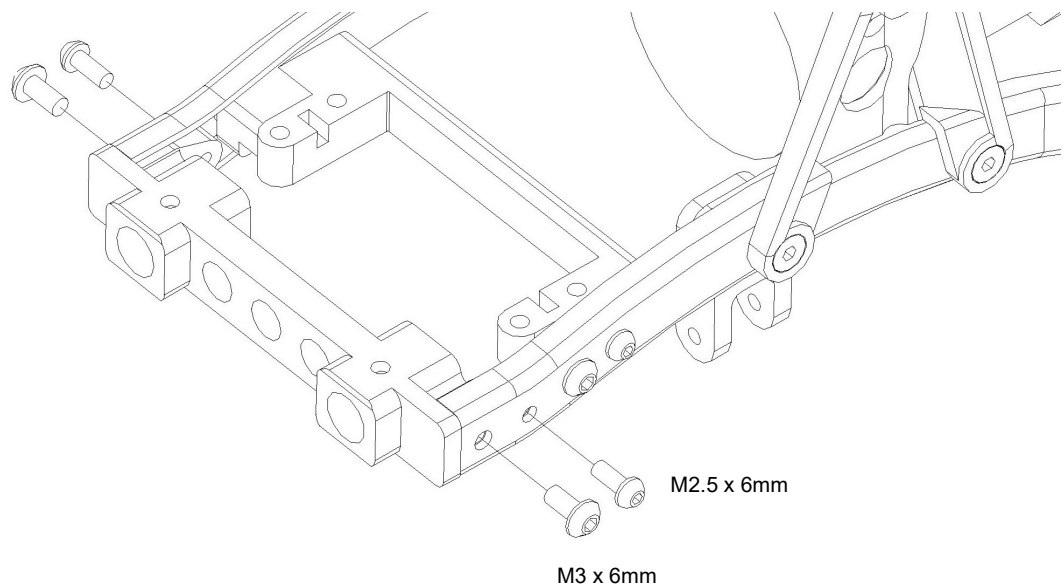

48 Aluminum rear bumper mount

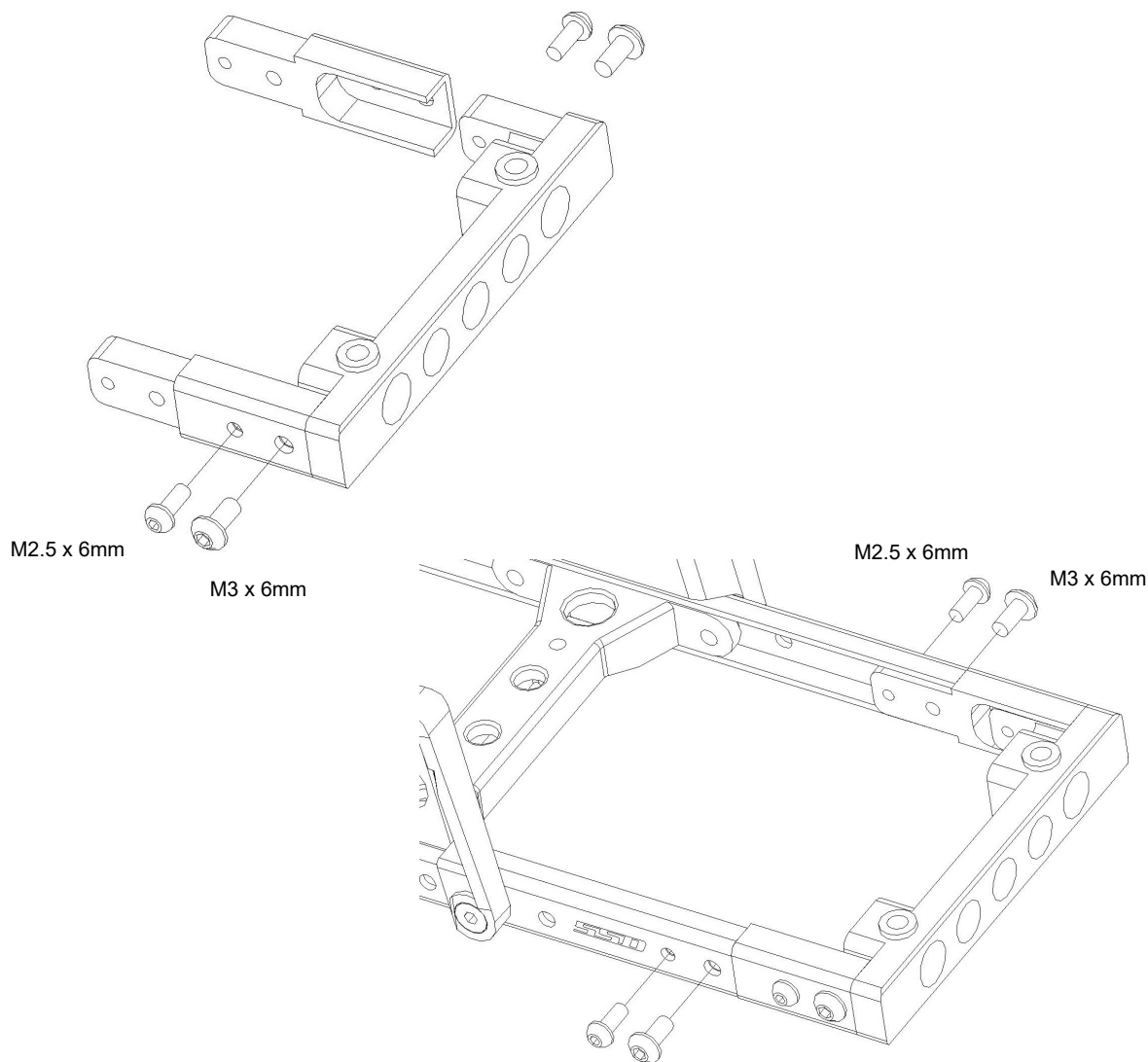



49    Rear upper links

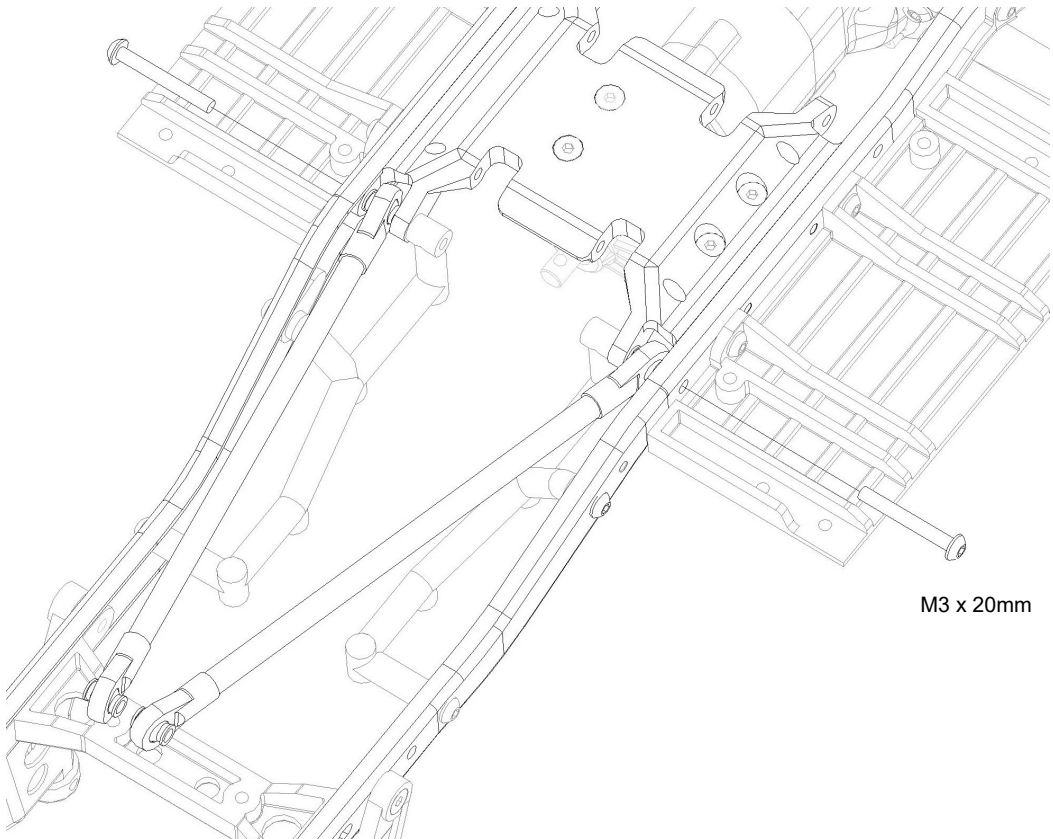

50    Rear lower links

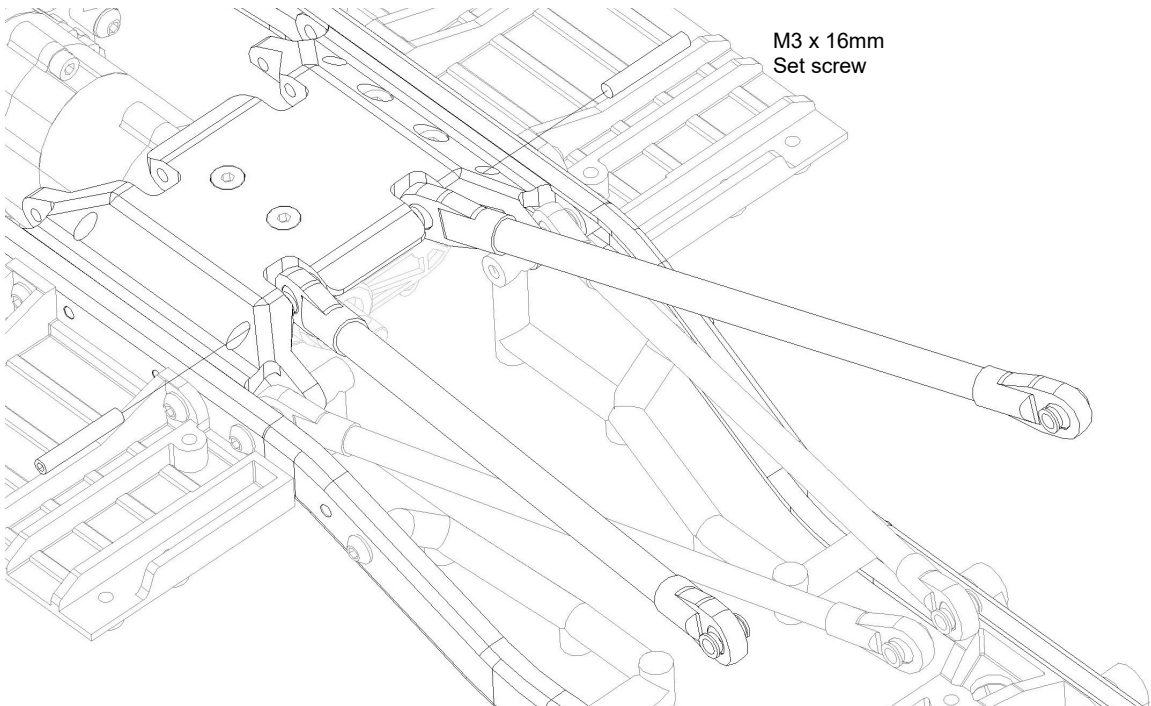

## 51 Front upper link

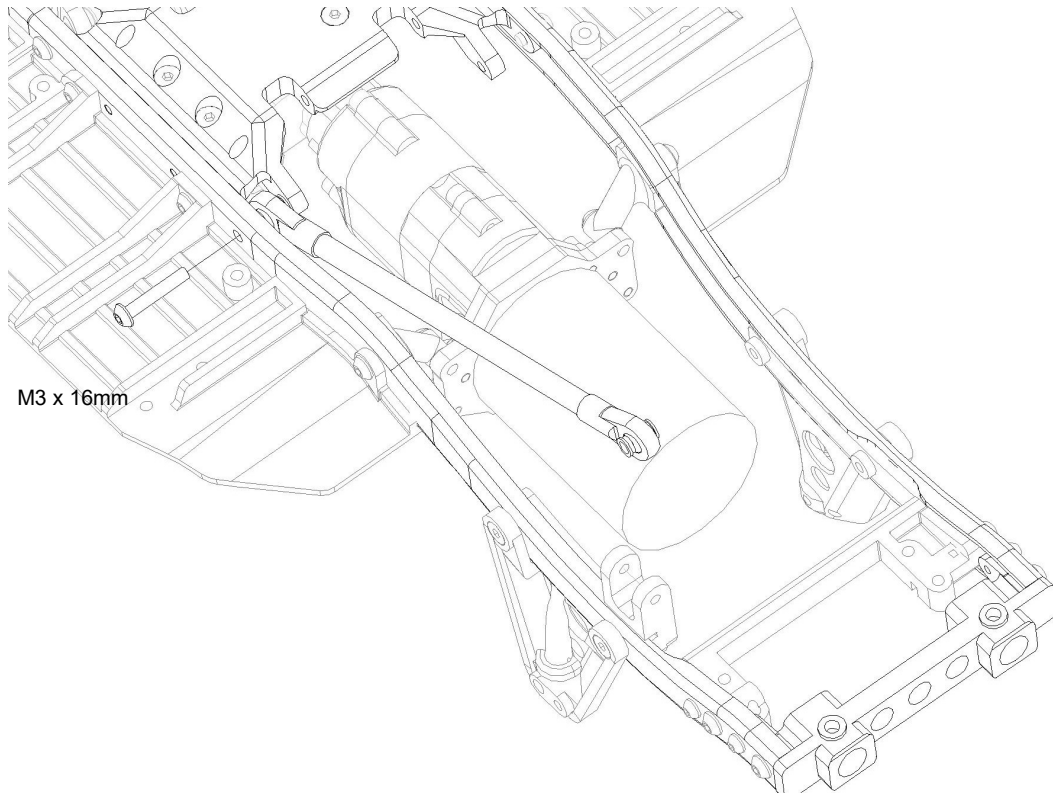

## 52 Front lower links

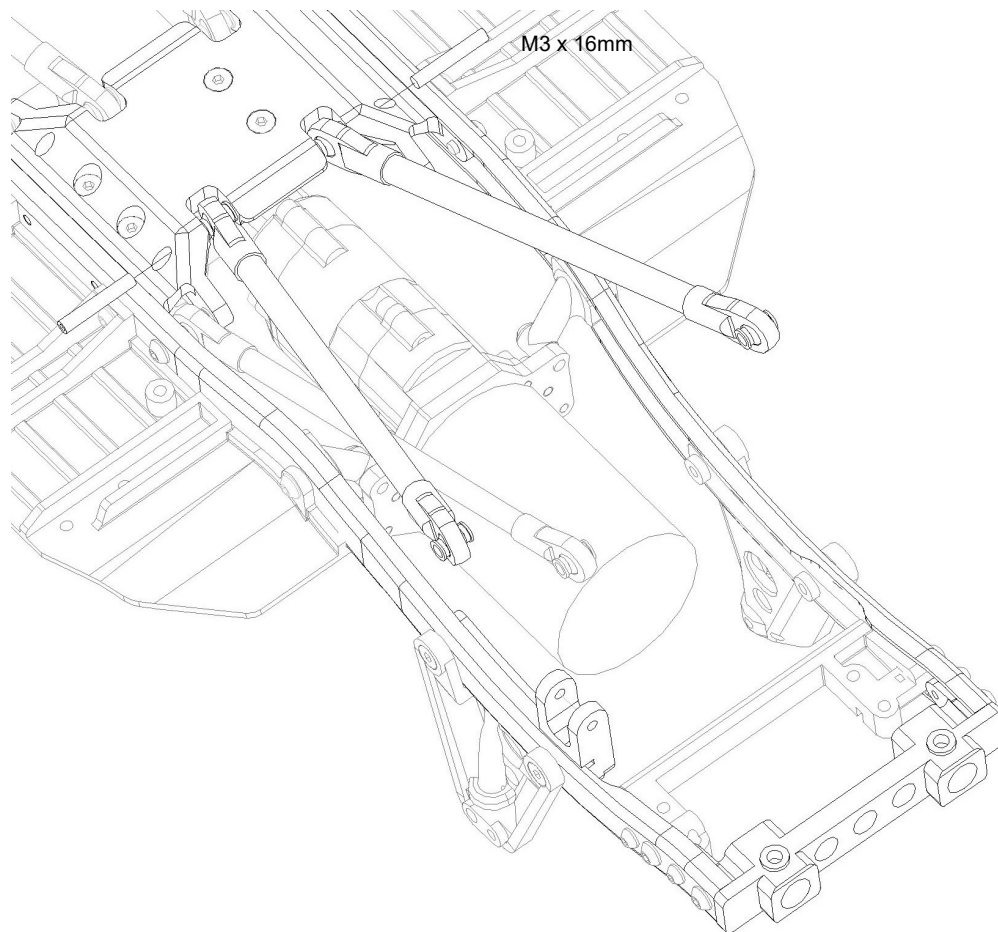

### 53 Panhard bar

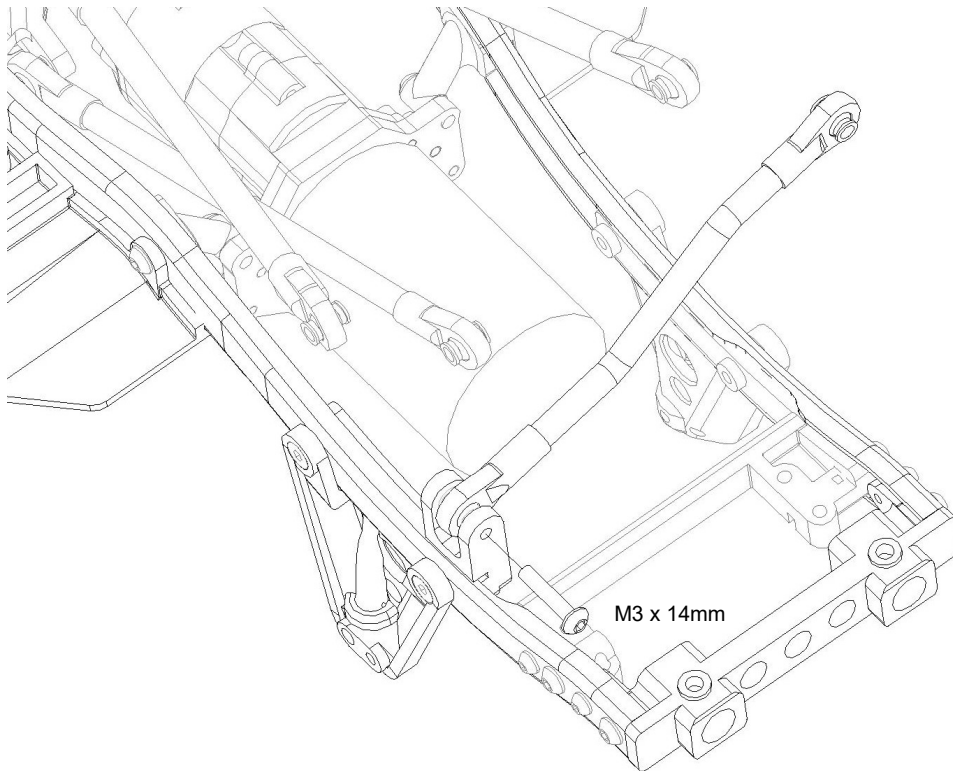

### 54 Rear axle

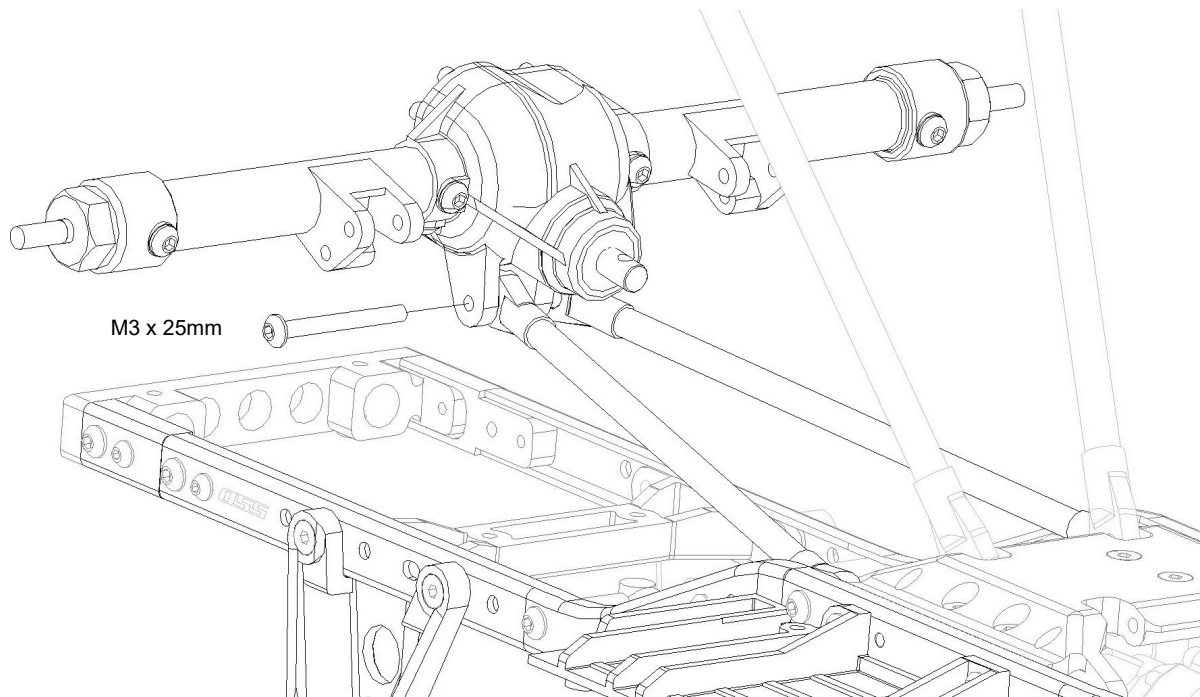

55

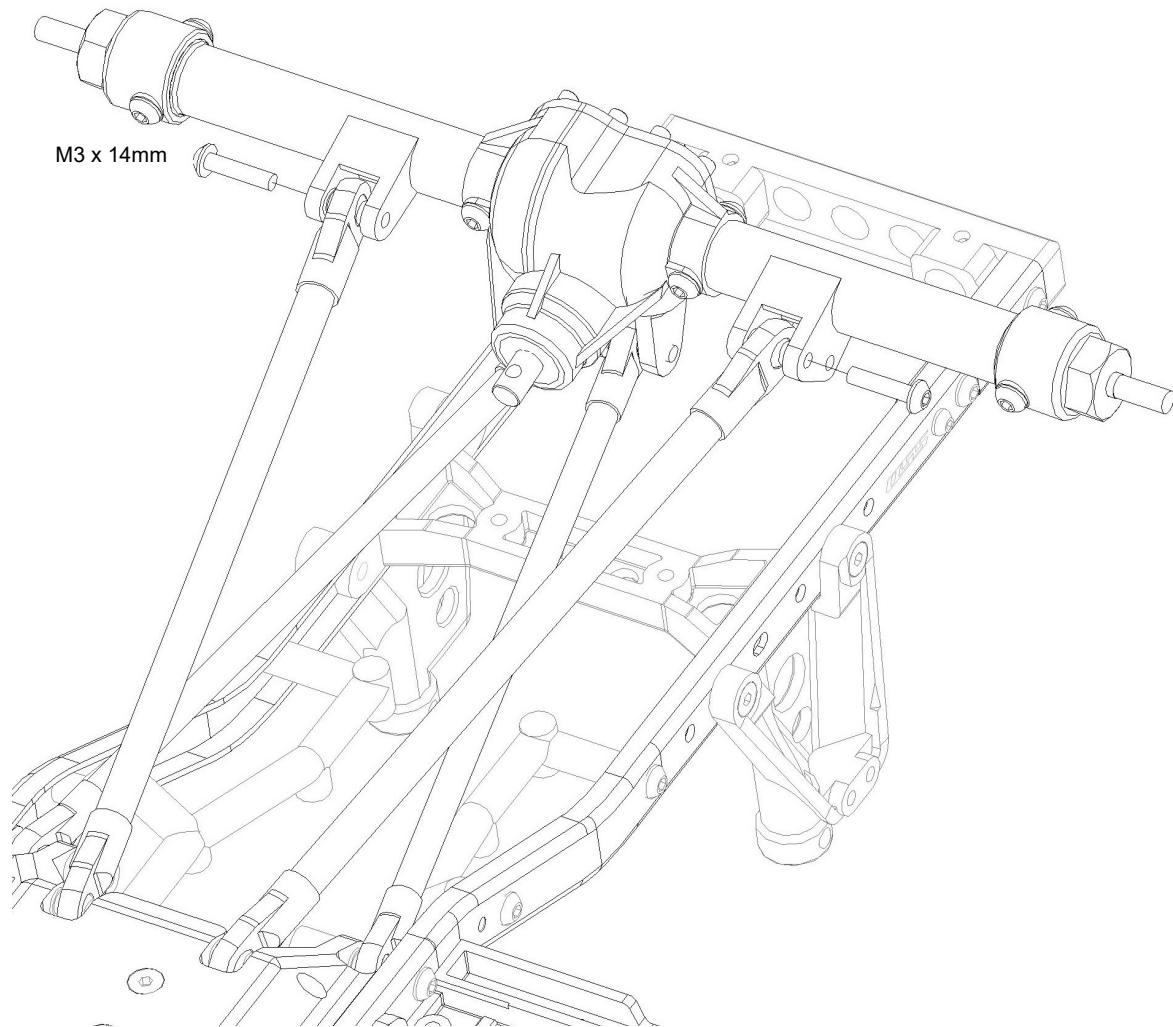

## Open Bag M - Driveshafts

56 Rear (long) driveshaft

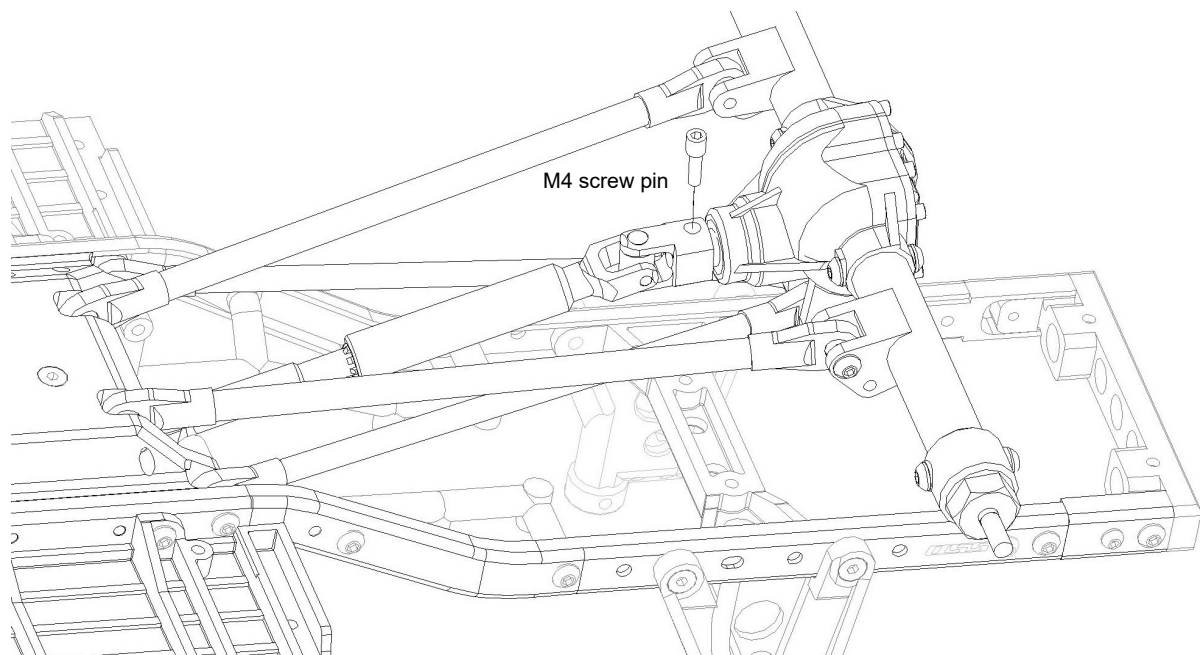

57

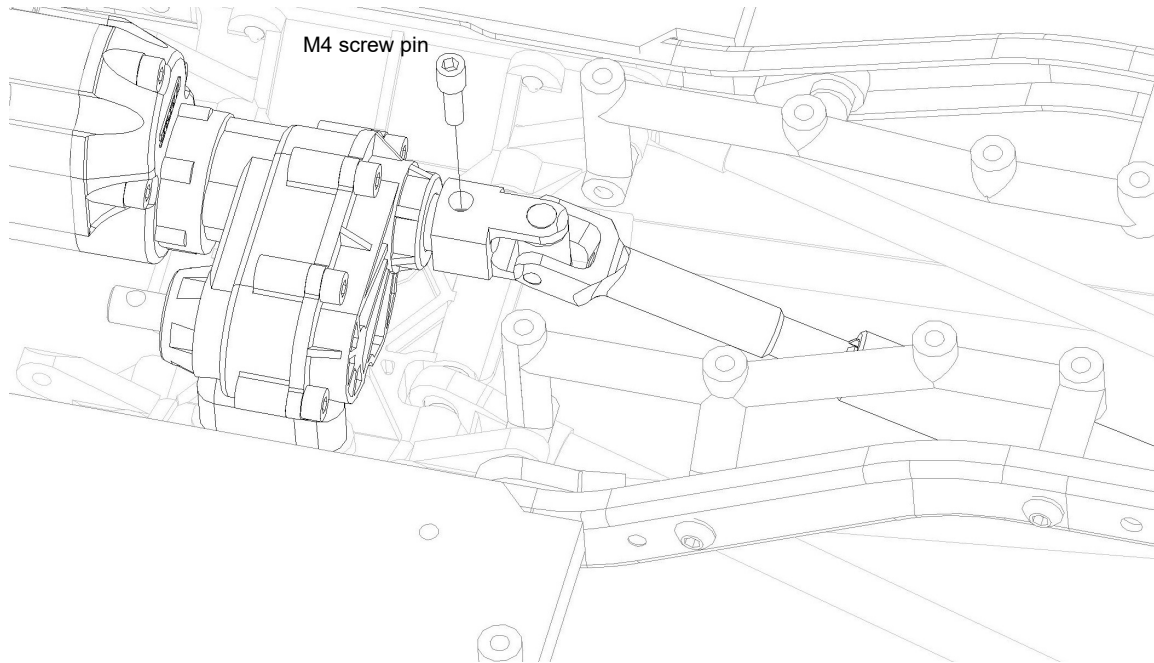

58 Front axle

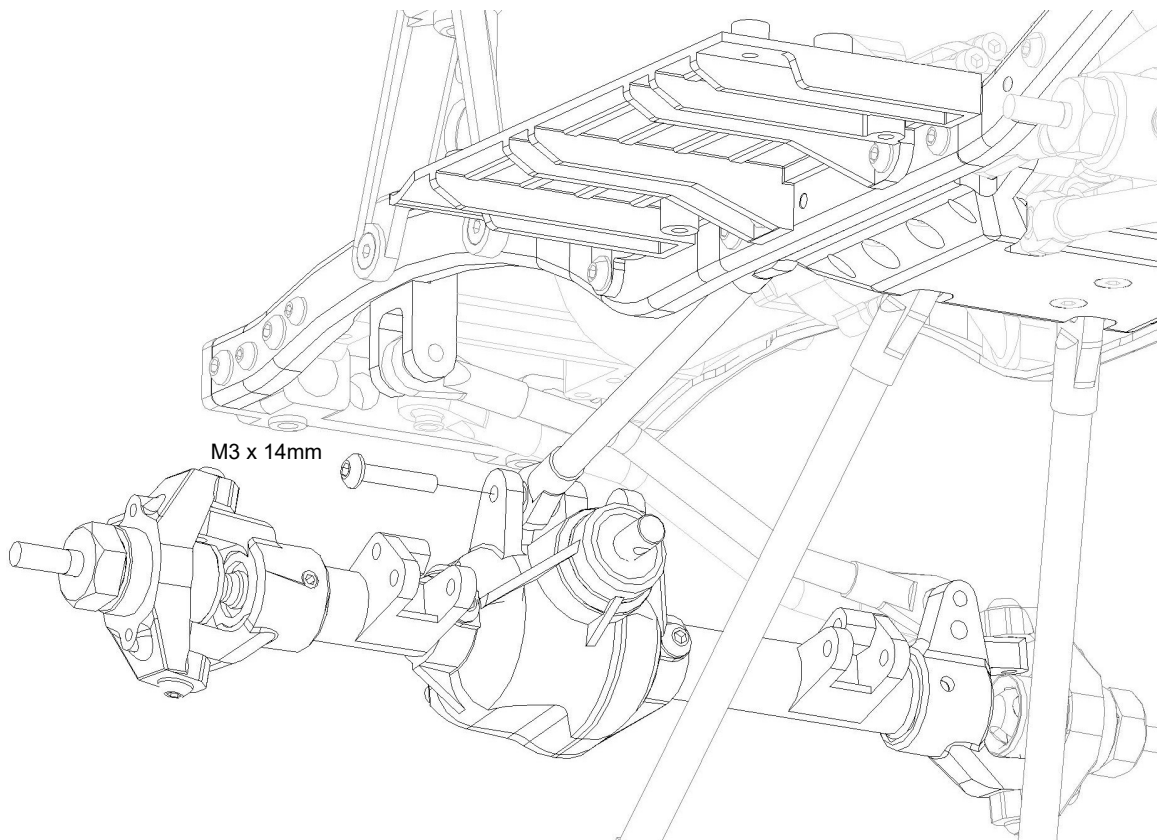

## 59 Front (short) driveshaft

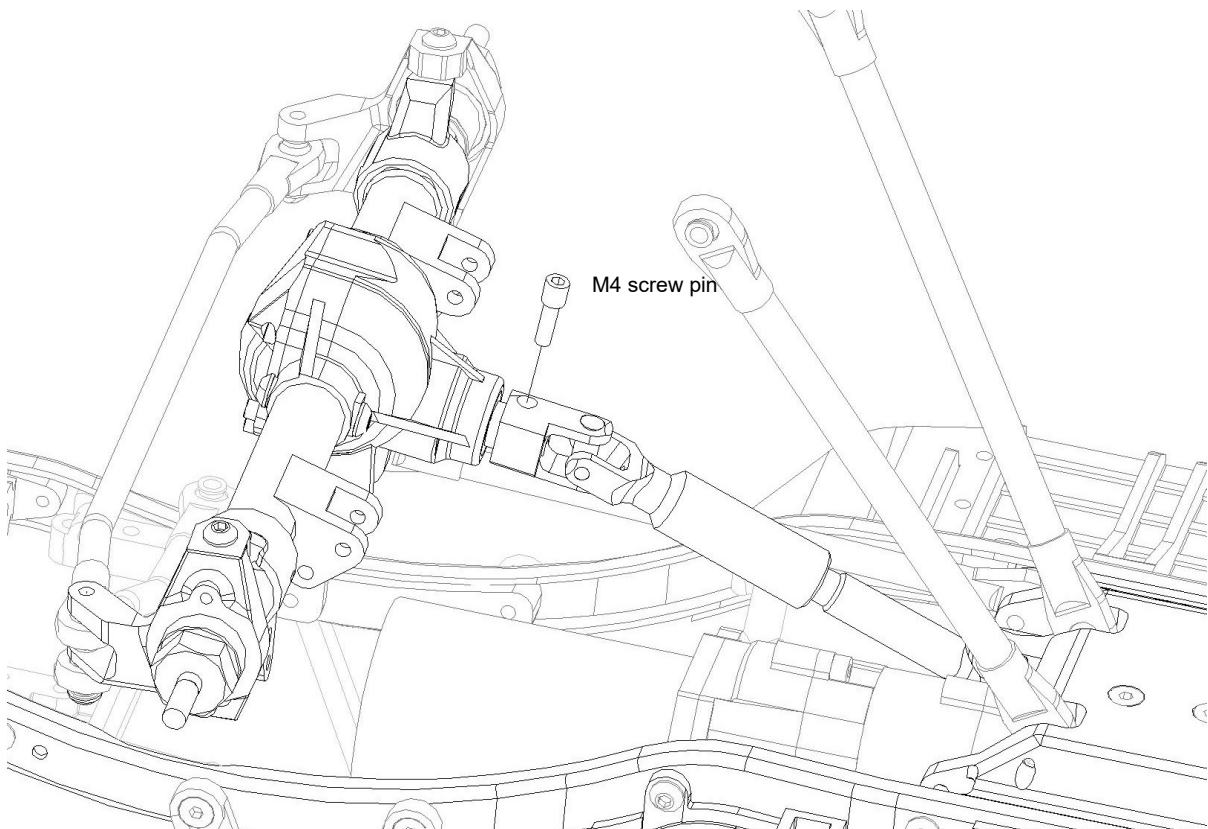
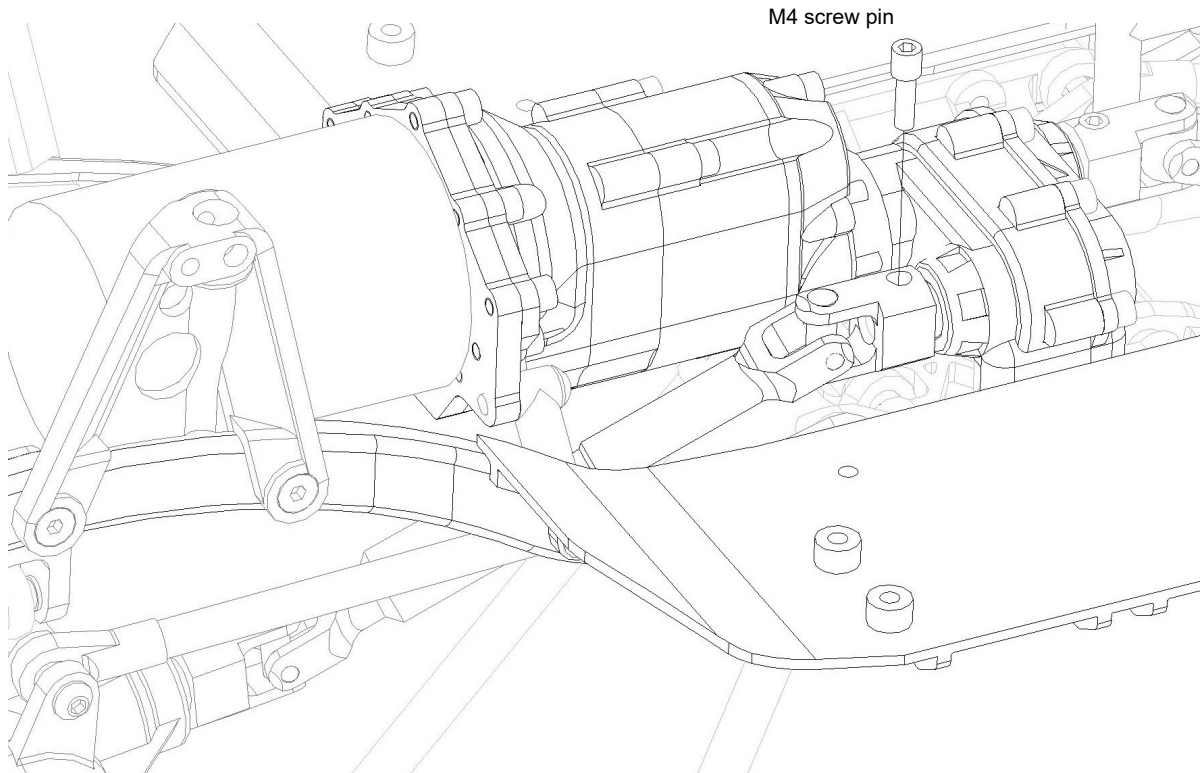

60

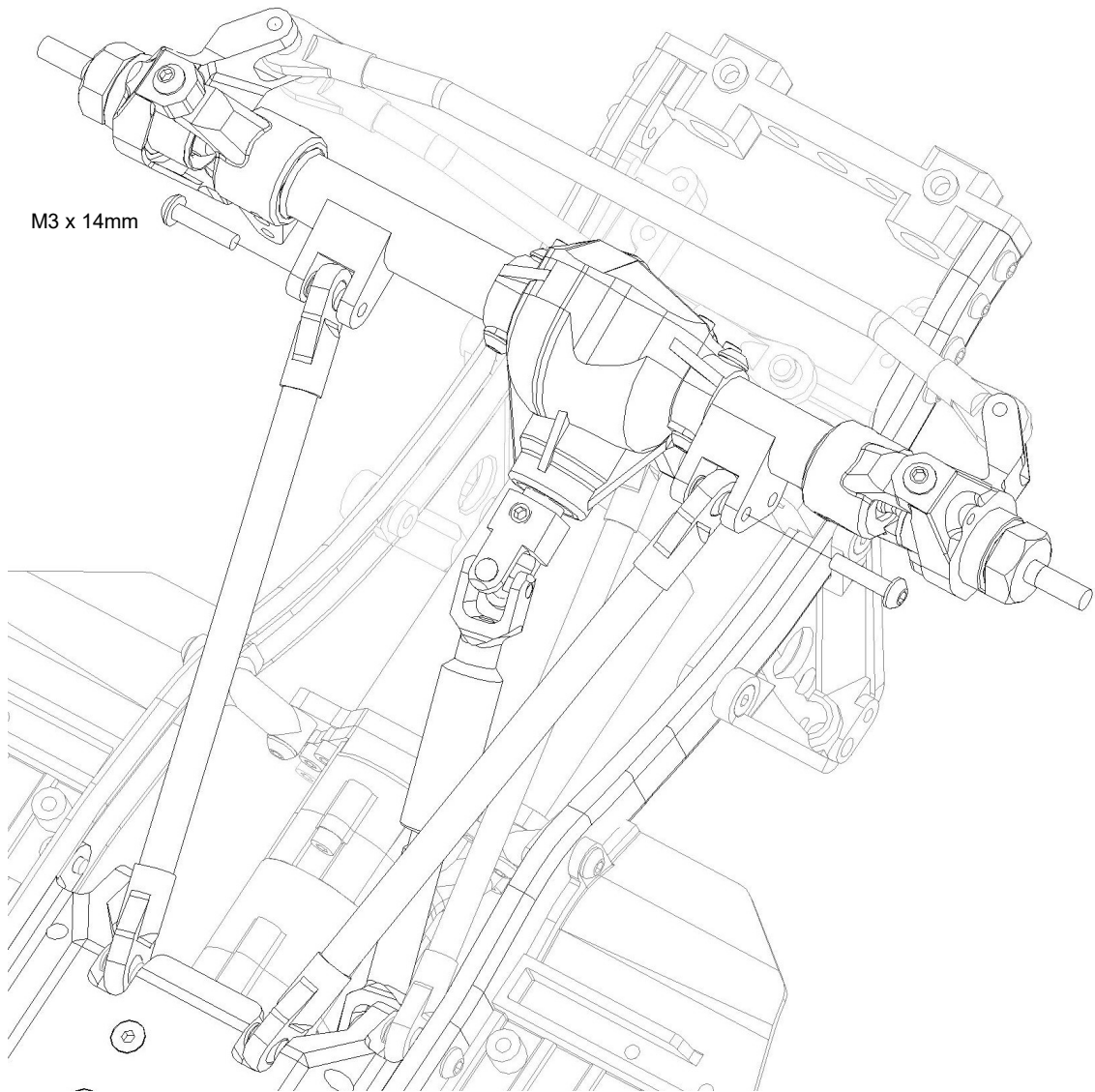

61

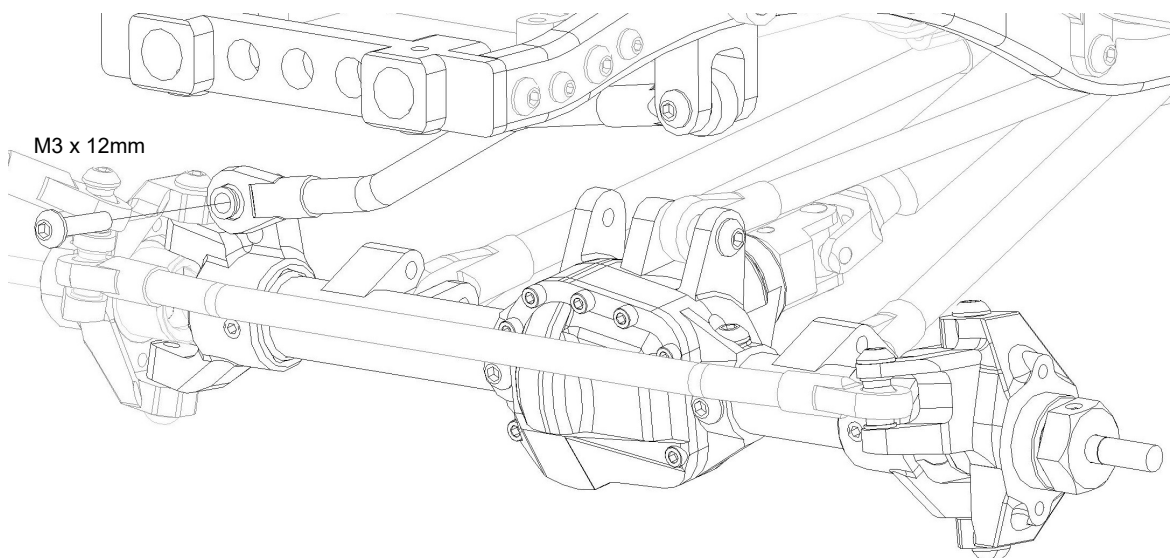

## Open Bag P – Aluminum Shocks

Put shock oil (not included) in all four shocks

### 62 Attach all four shocks

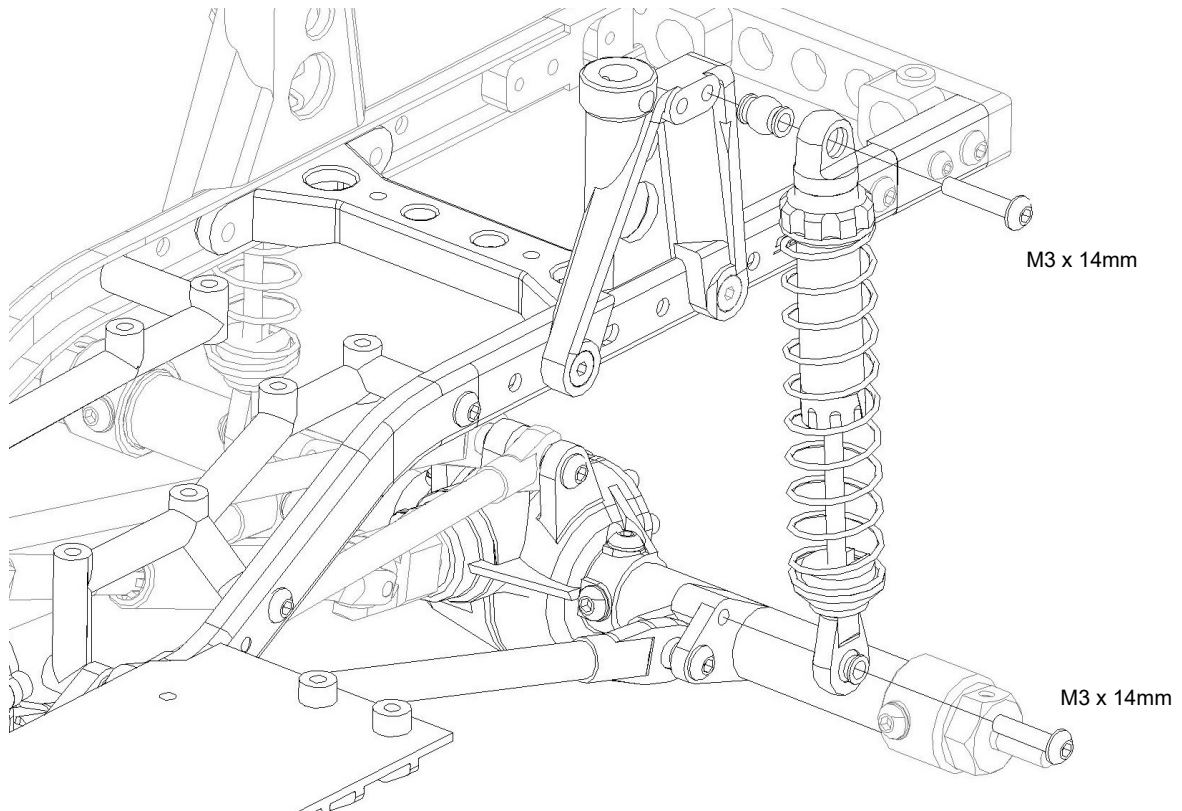

### 63 Install steering servo (not included)

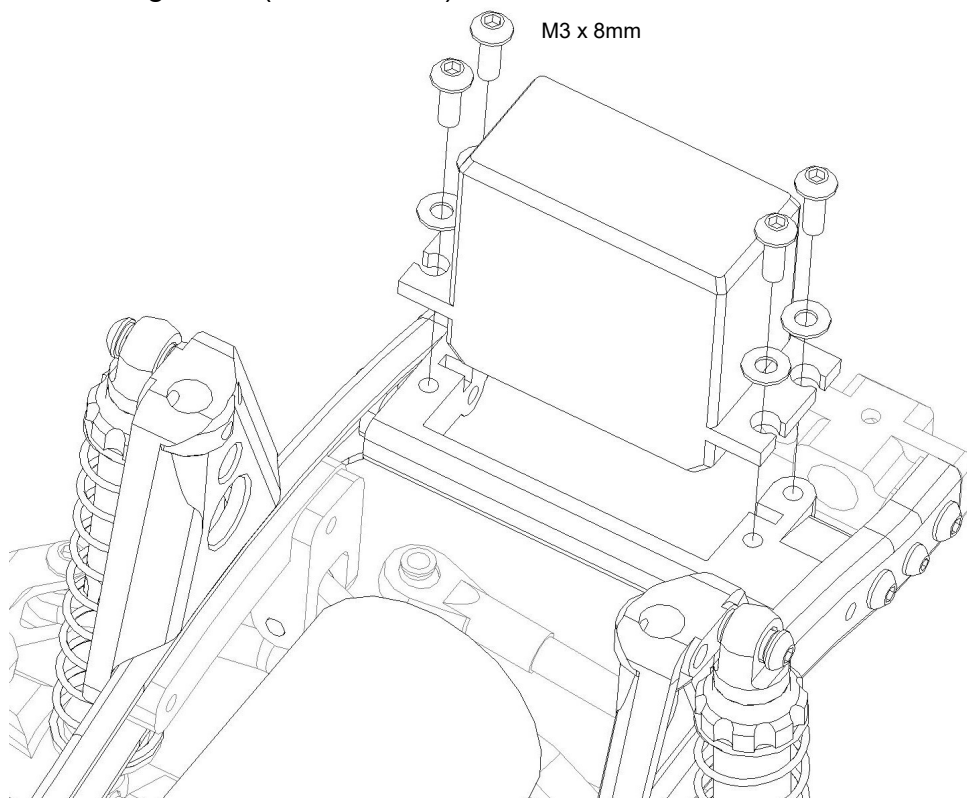



## 64

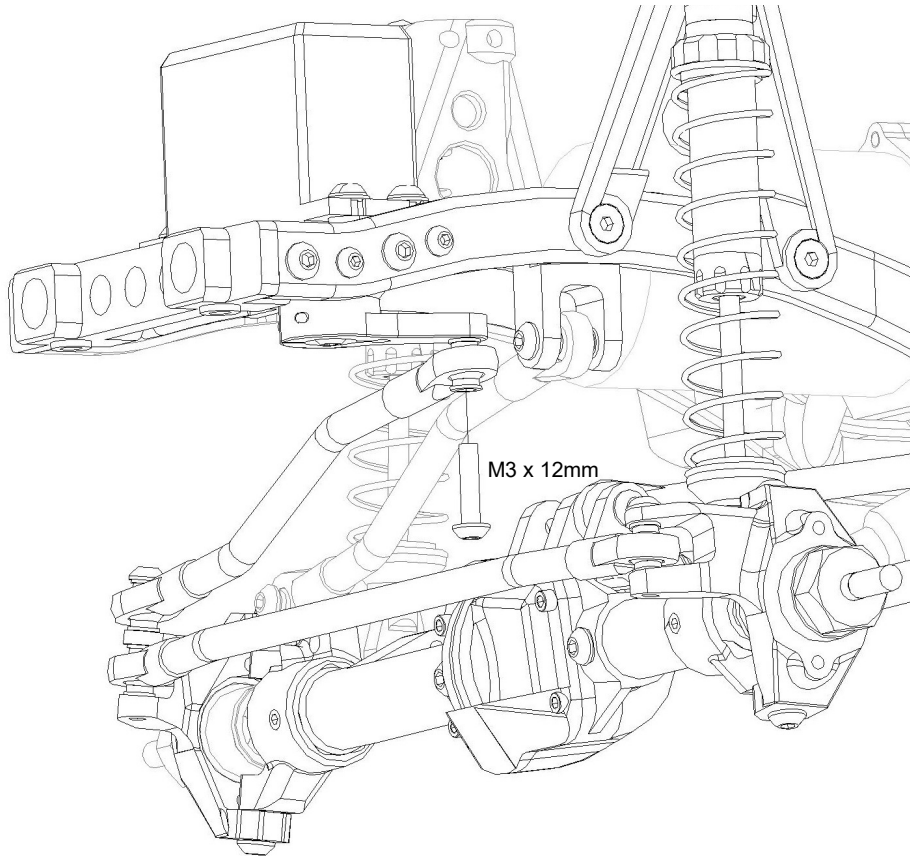

## 65

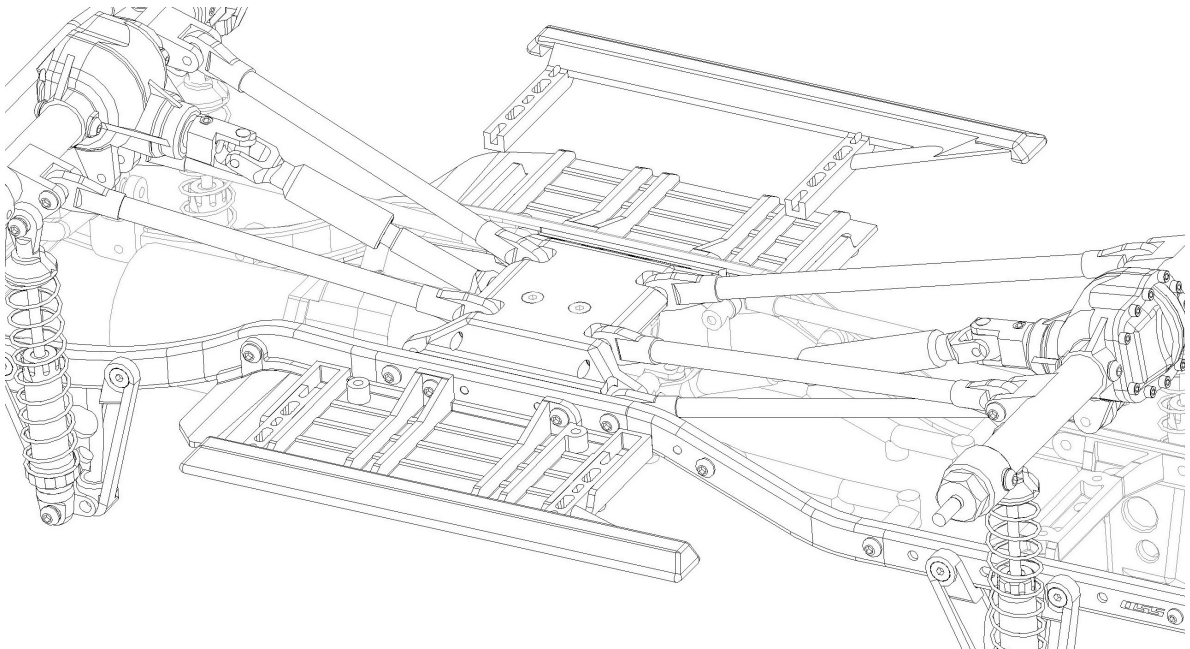

66

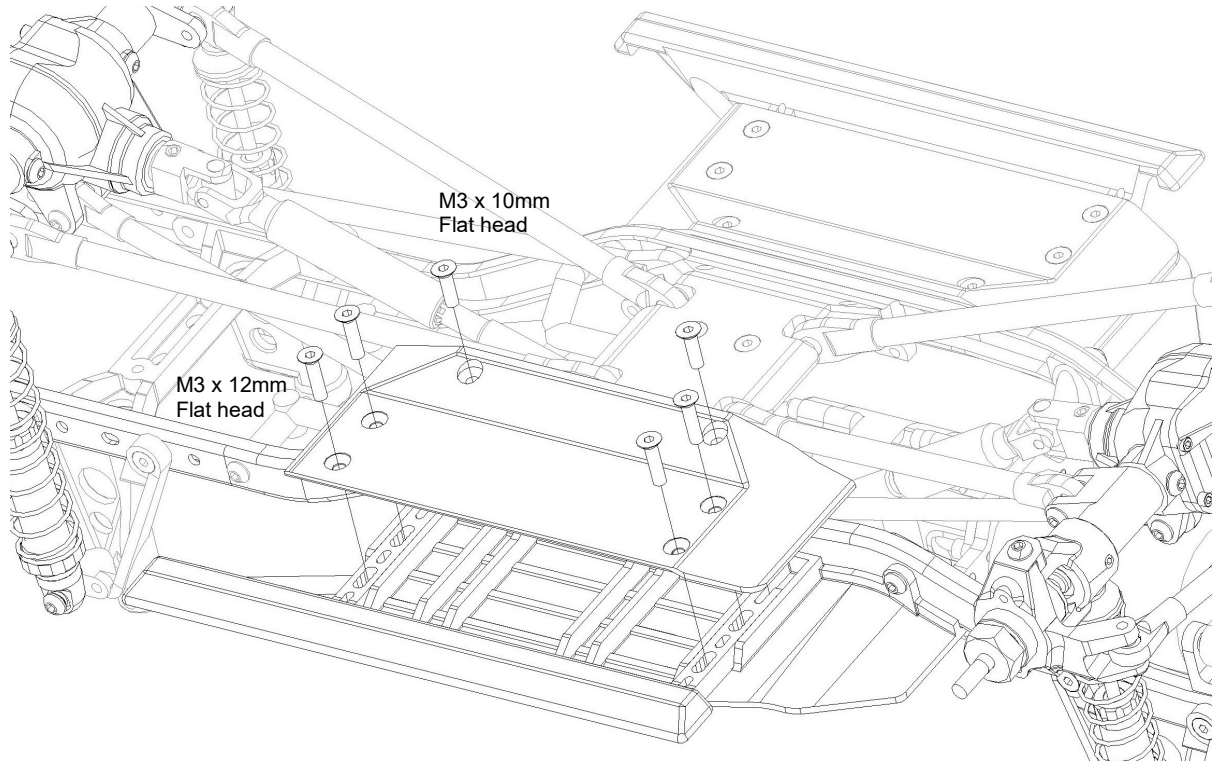

## Open Bag Q – Battery Tray

67

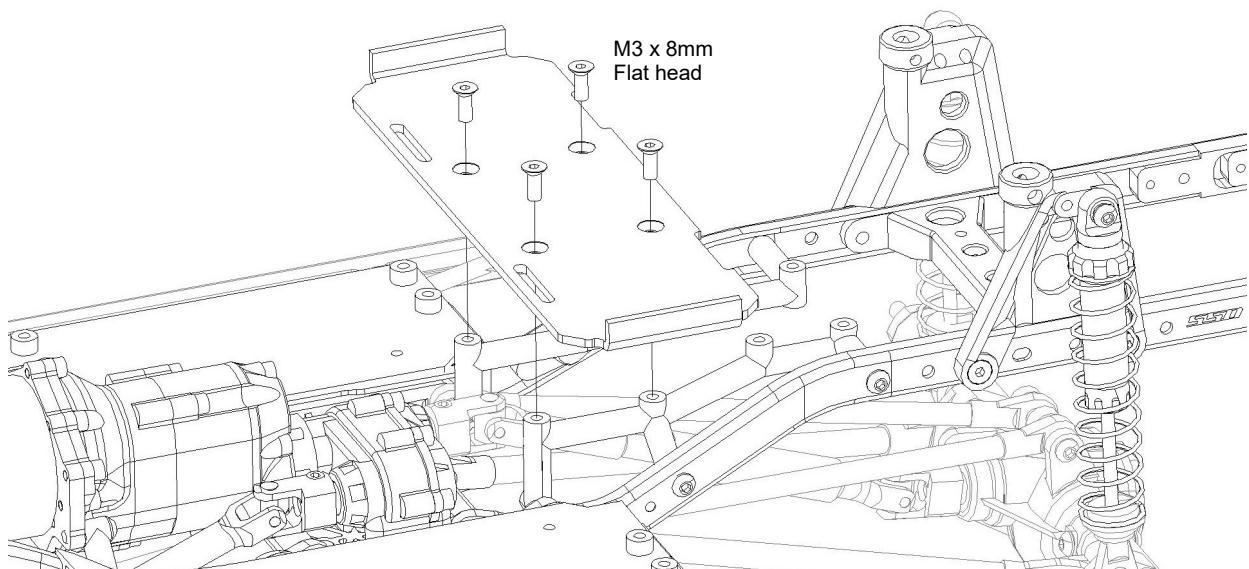

68 Install all body posts

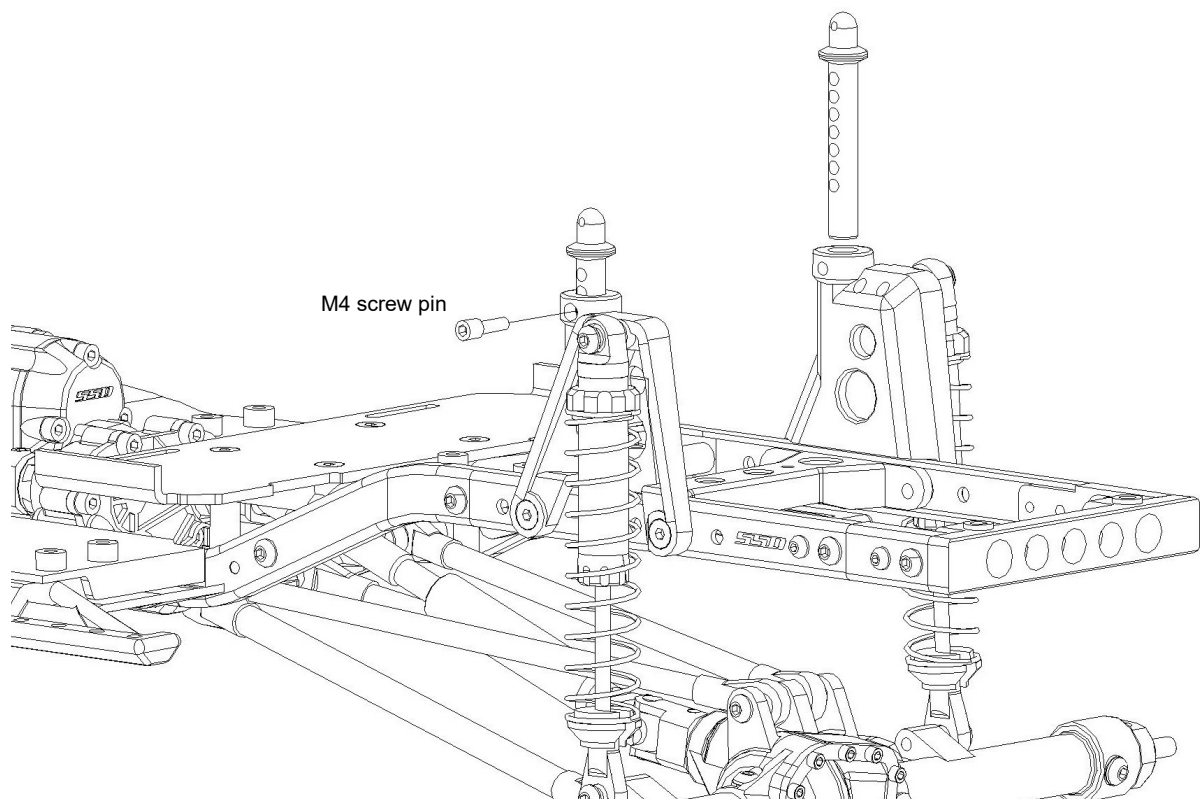

**Open Bag R – Fuel Cell**

69 Use ABS plastic model glue/cement

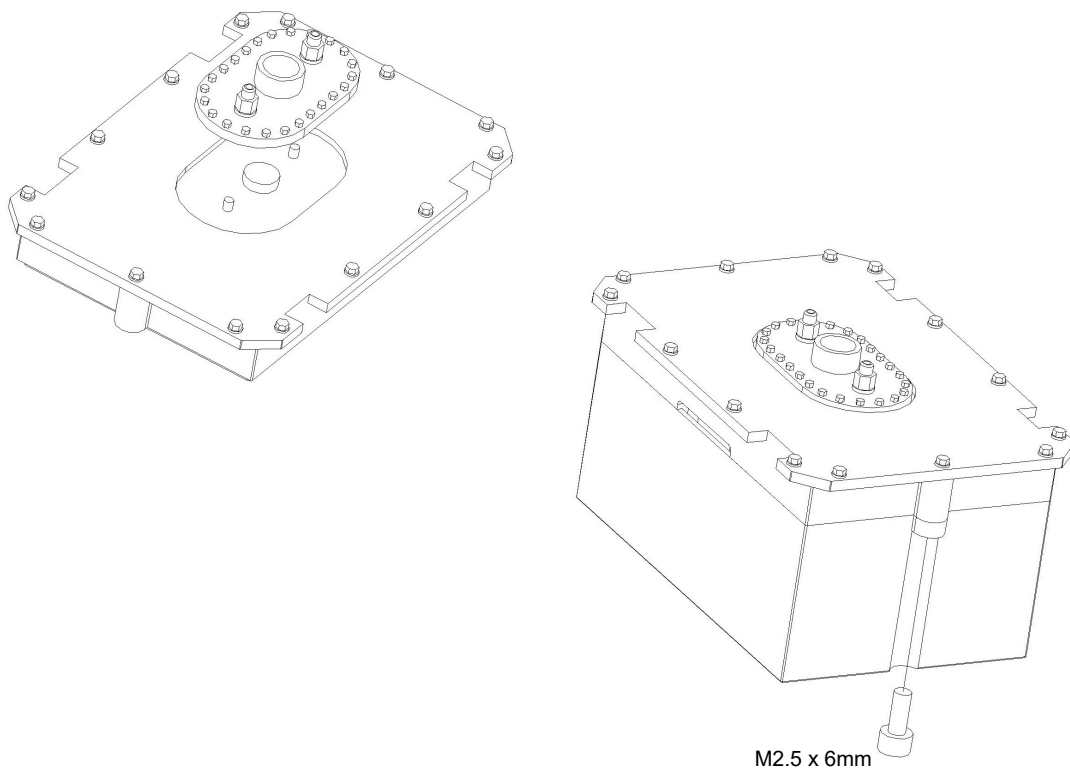

70

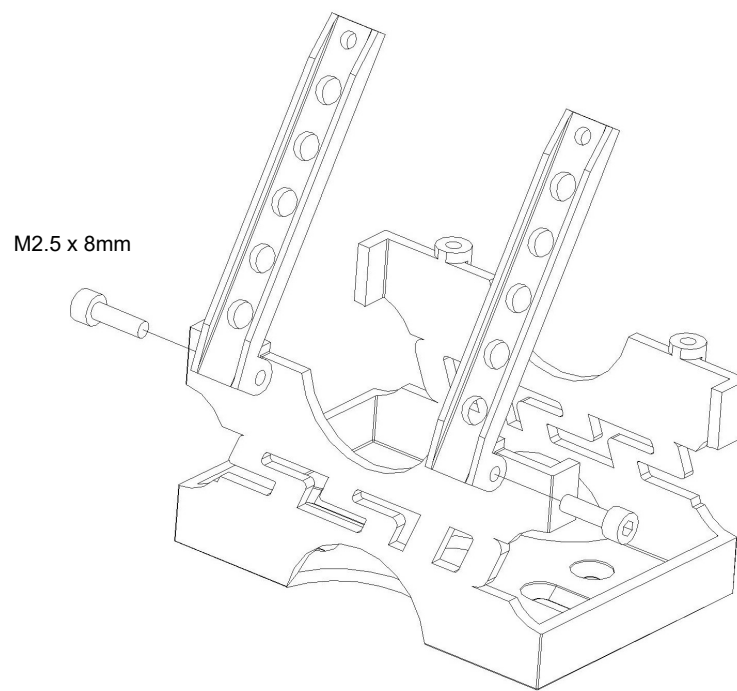

71

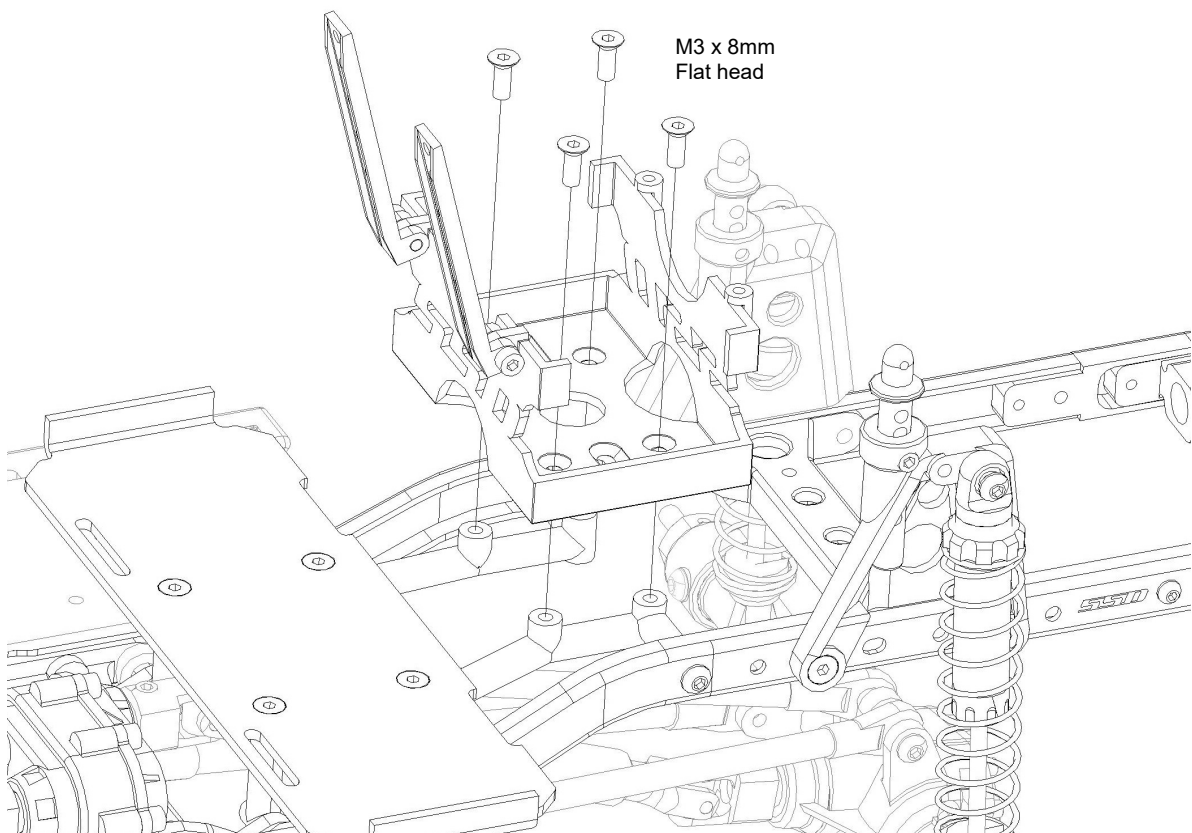

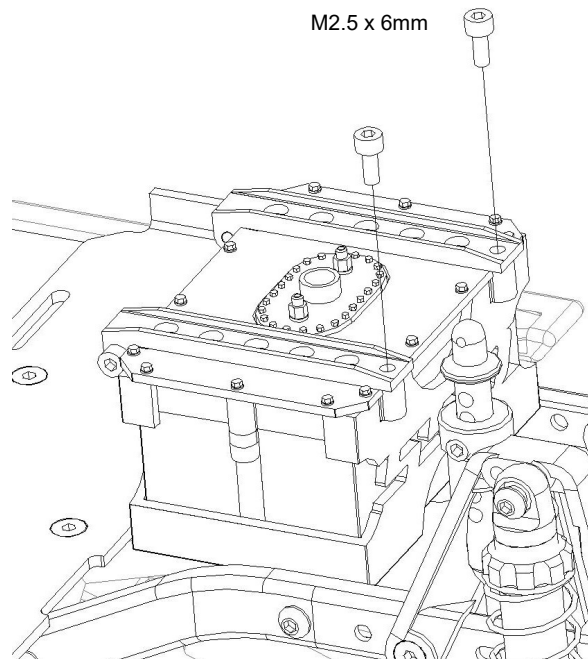
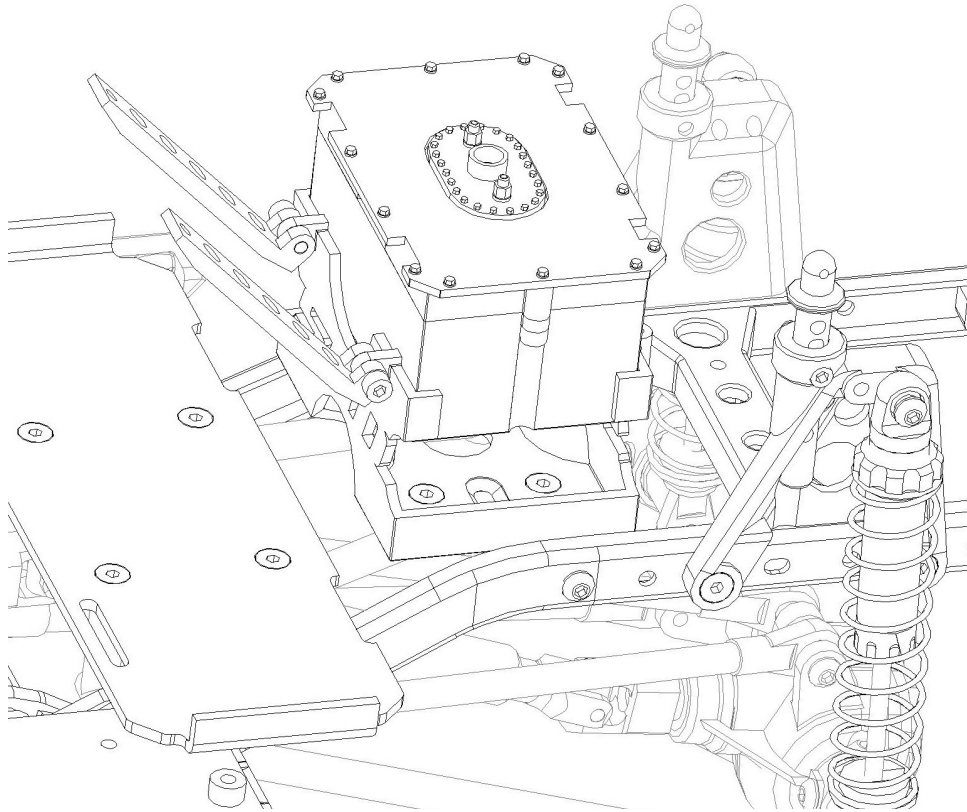

## Open Bag S - V8 Engine

73 Use ABS plastic model glue/cement during engine assembly

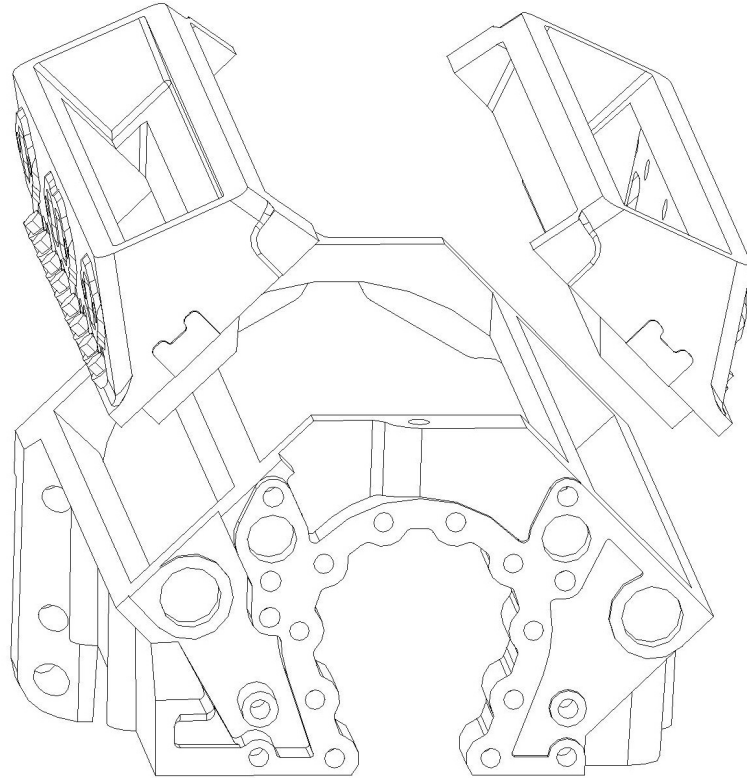

74

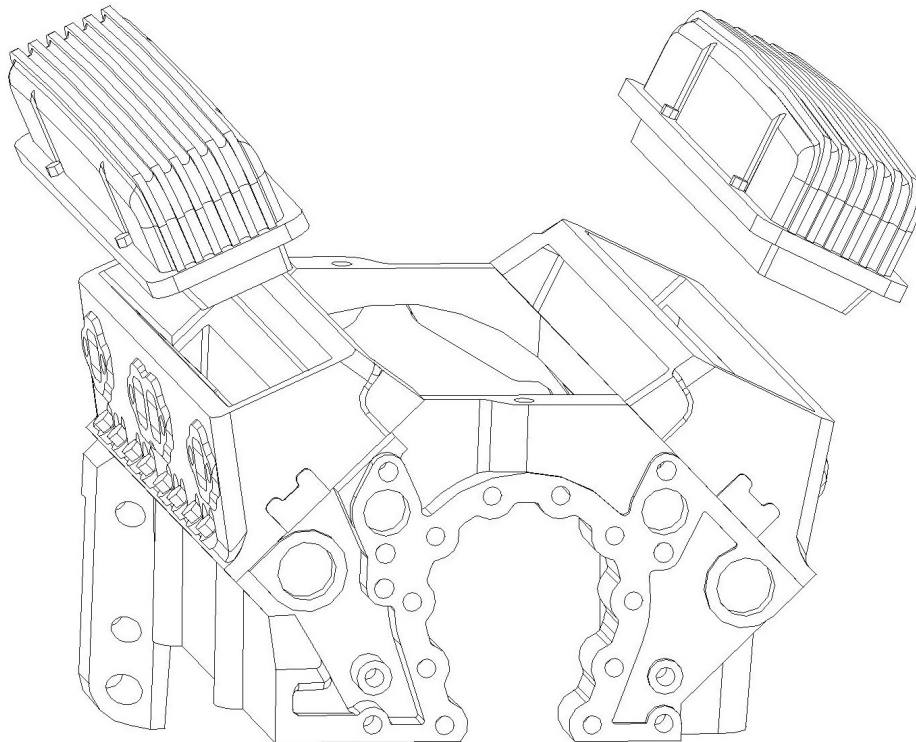

75

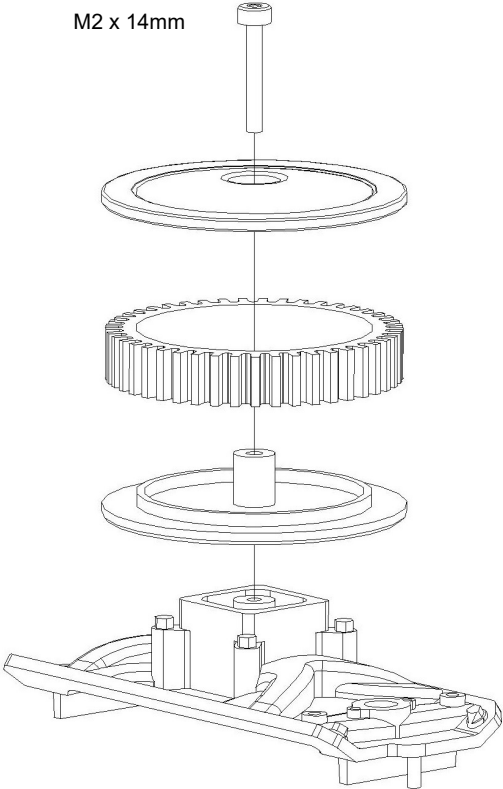

76

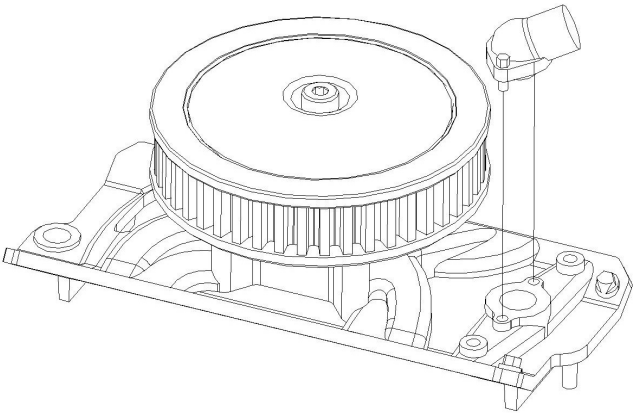

77

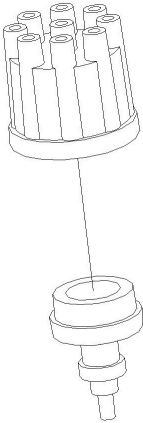

78

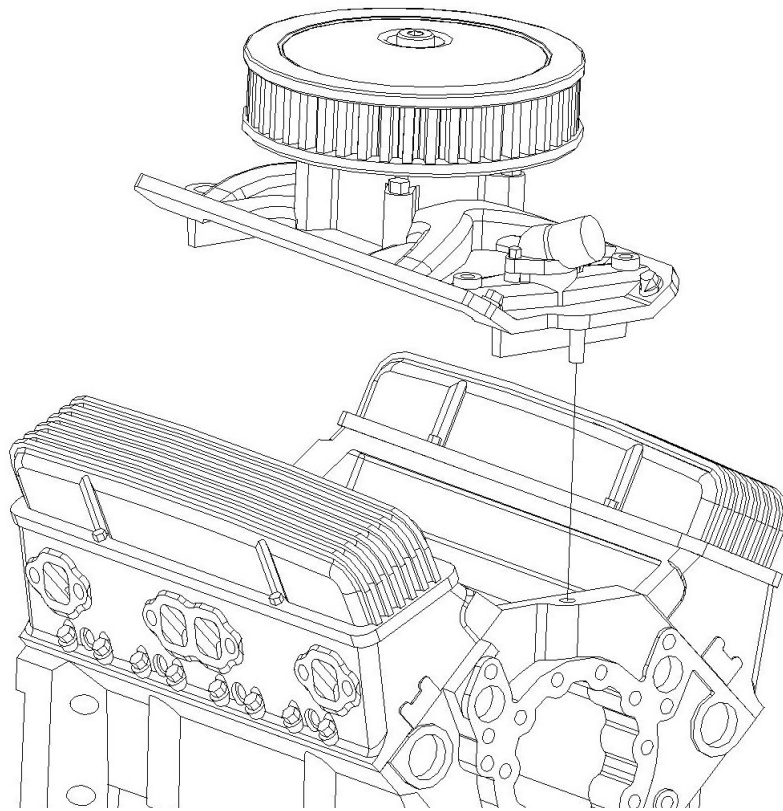

79

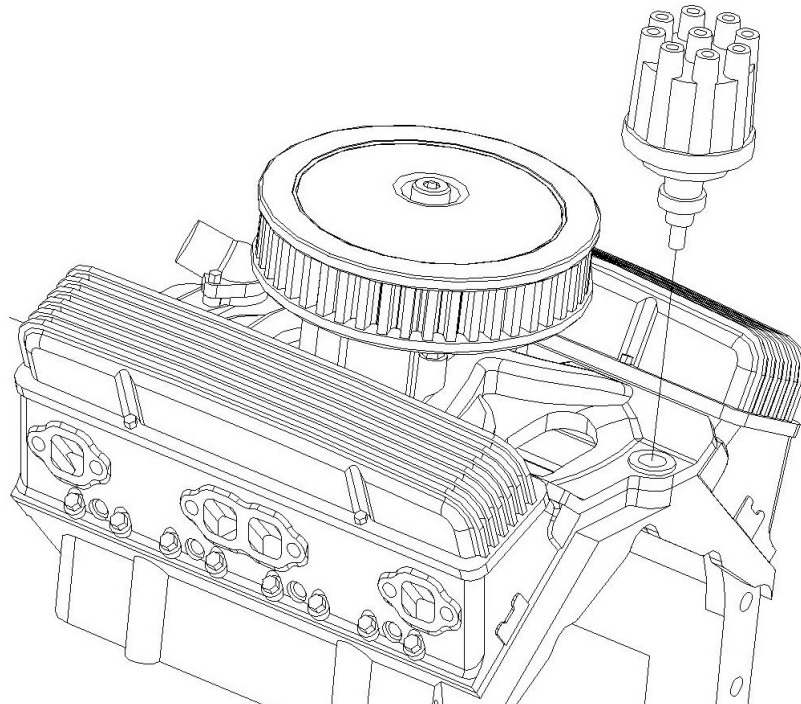



80

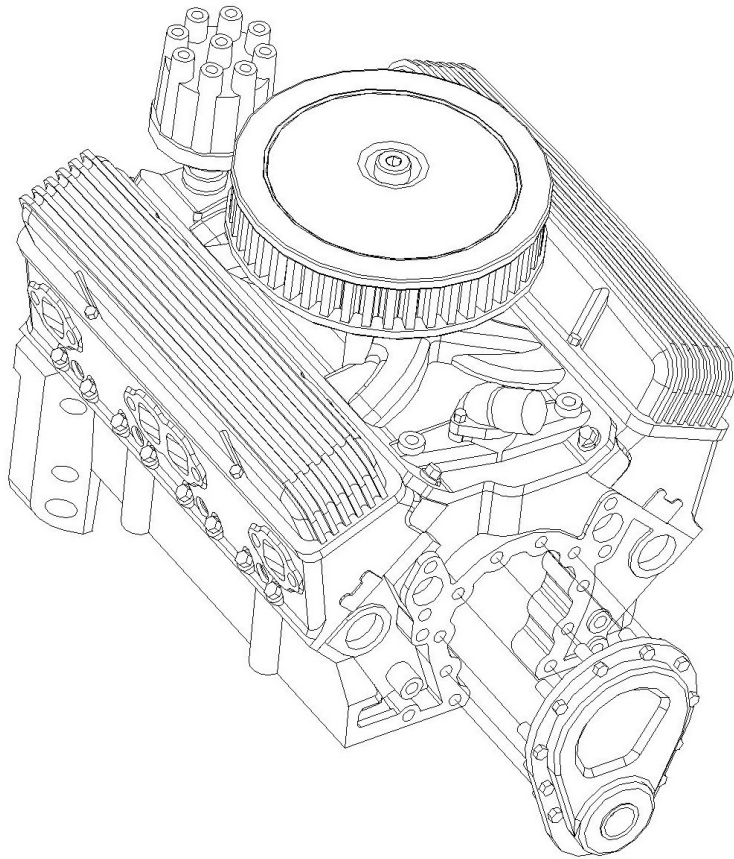

81

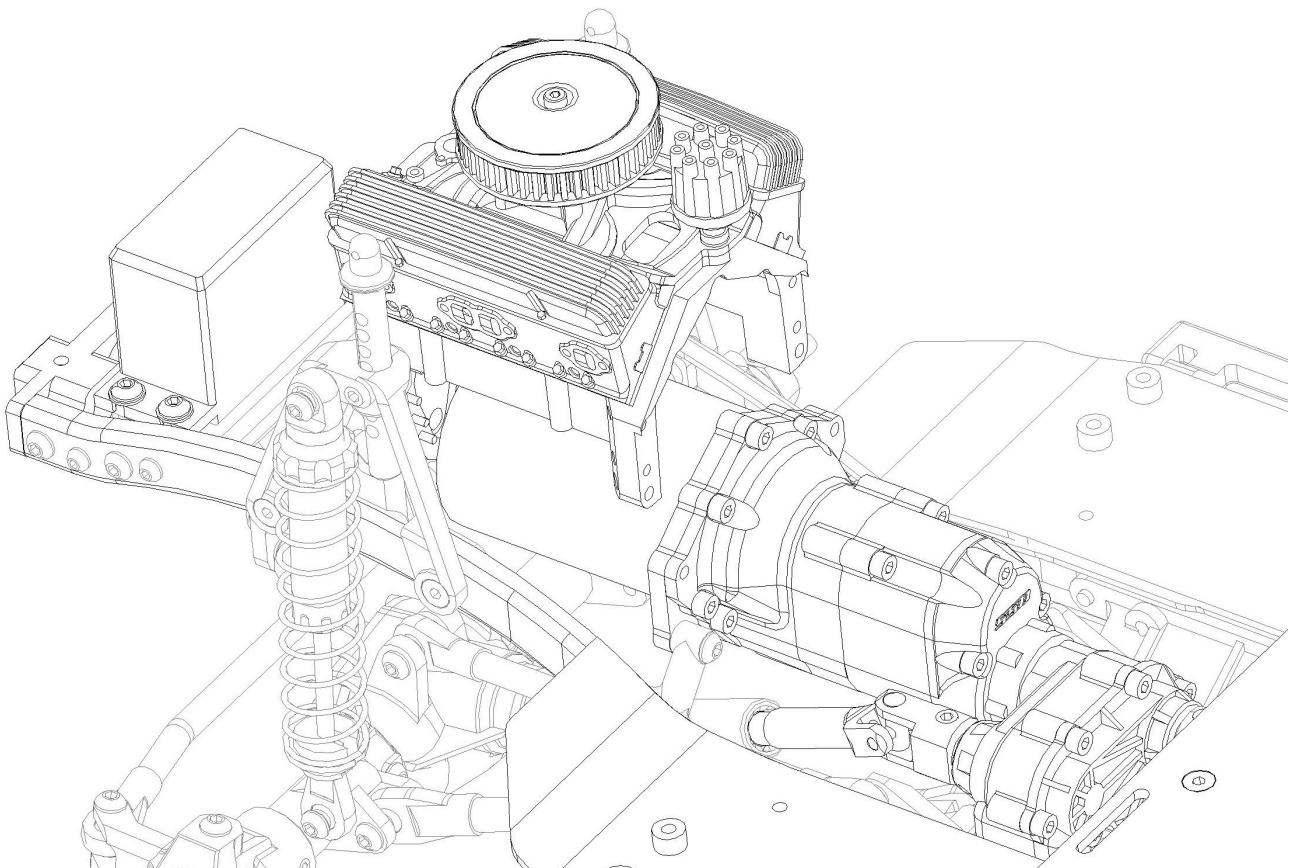

82

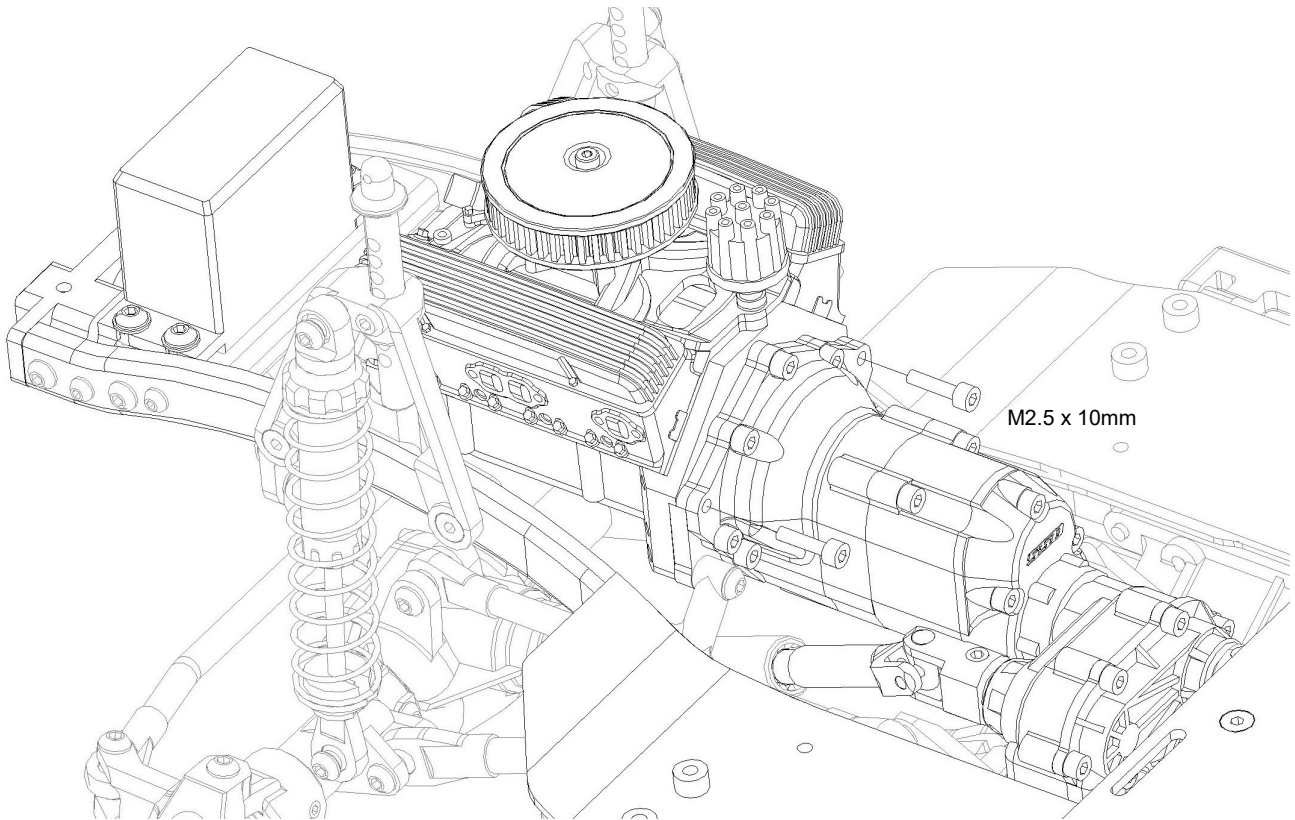

83 Oil pan/motor cover

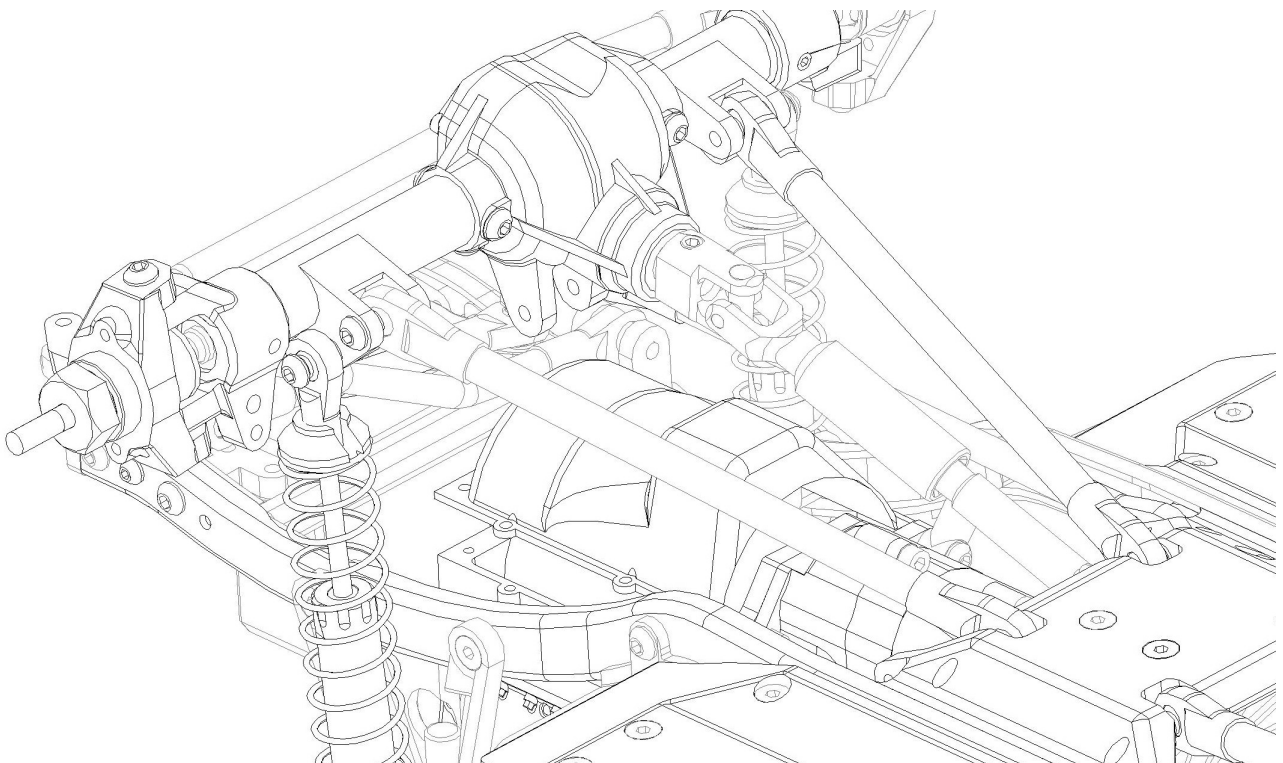

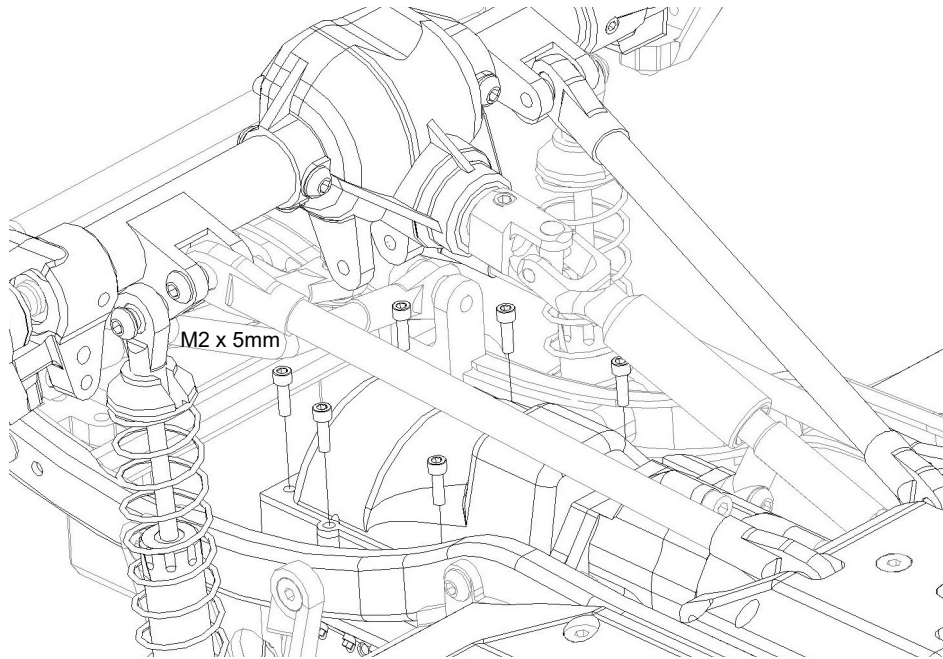

## Bag T - Hardware

This bag contains the hardware needed to mount wheels, body and bumpers.

## Option Parts

- SSD00124 Stainless Steel Lower Links
- SSD00134 25T Servo Horn
- SSD00140 Brass Knuckle Weights
- SSD00176 Rock Shield Aluminum Side Sliders
- SSD00193 Heavy Brass Knuckles
- SSD00206 305mm Wheelbase Conversion
- SSD00217 Pro44 Metal Bearing Clamps
- SSD00226 Diamond 44 Center Section
- SSD00227 Pro44 Metal Diff Cover
- SSD00230 Pro44 Metal Rear Axle Tubes
- SSD00349 Overdrive Axle Gear Set (8T/27T)
- SSD00350 Rear Chassis Extension
- SSD00351 Pro44 Rear Axle Brass Weights
- SSD00355 Aluminum Wide Front Shock Hoops
- SSD00366 Aluminum Offset Front Axle Tubes
- SSD00380 Aluminum Rear Shock Hoops

# TRAIL KING

PRO SCALE CHASSIS

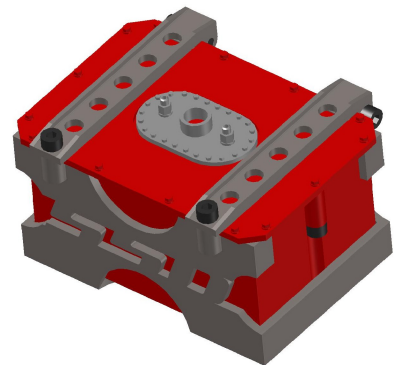
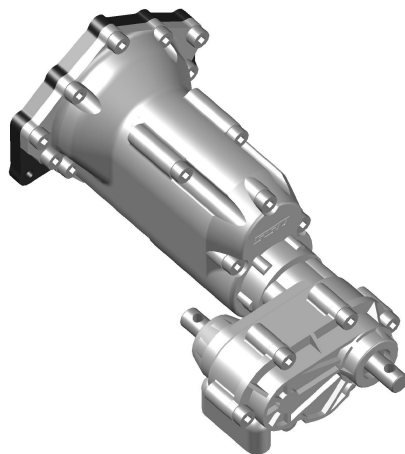
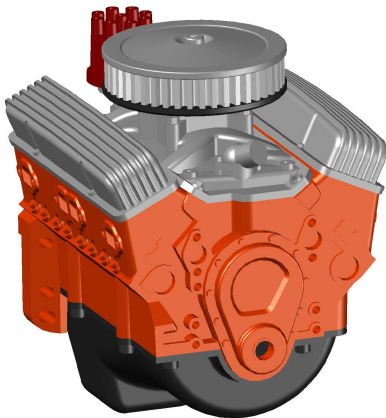
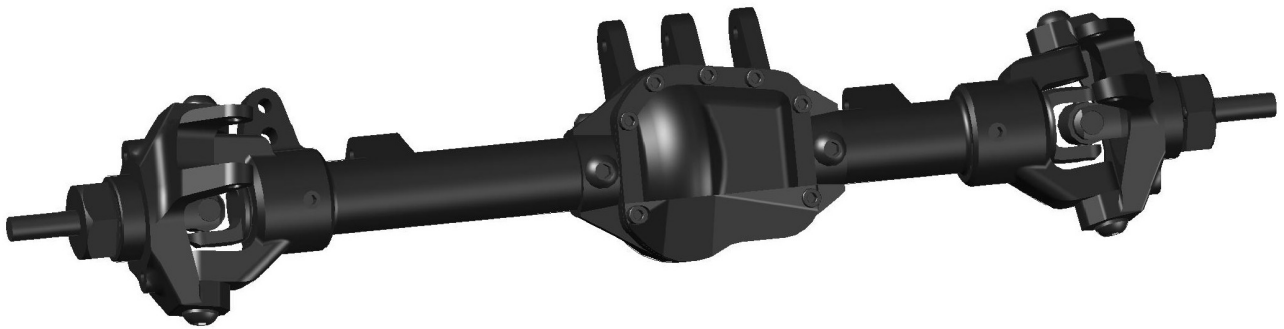

SLD