

SSD Pro44 Portal Rear Axle Assembly Instructions

Note: The stock SCX10 II AR44 axles will need to be disassembled with all gears, bearings and shafts removed before starting.

1 Install tubes into the housing

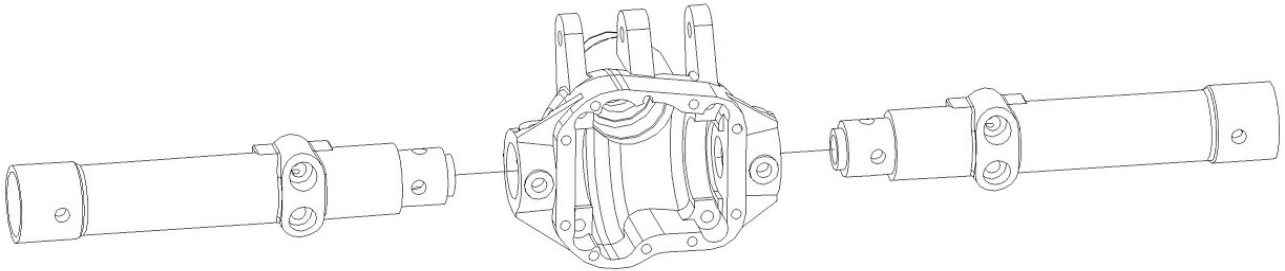

M3 x 5mm

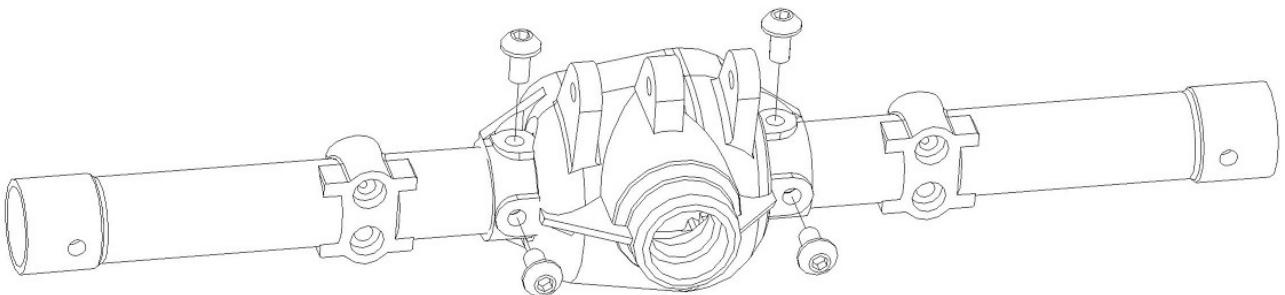

M3 x 5mm

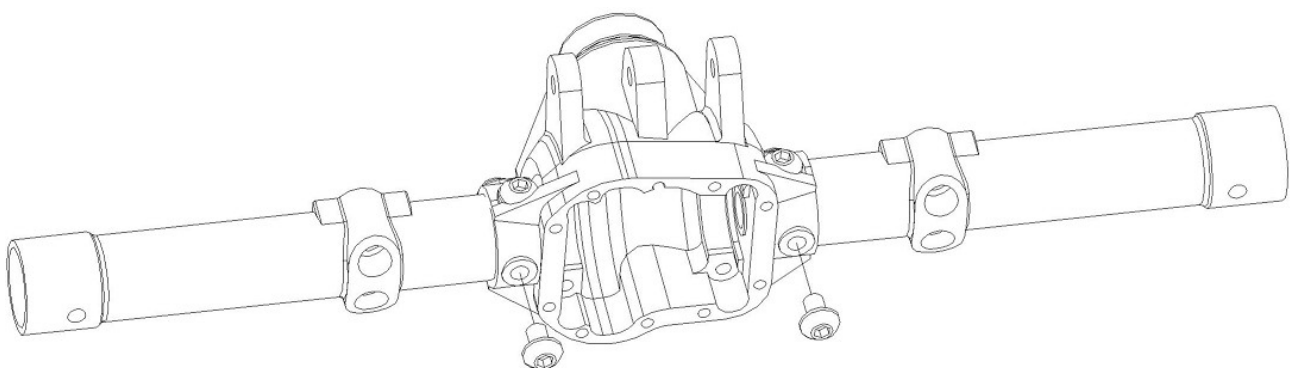

M3 x 4mm

2 Install gears with bearings

Apply grease to the gears before installation

5 x 11 x 4mm bearing

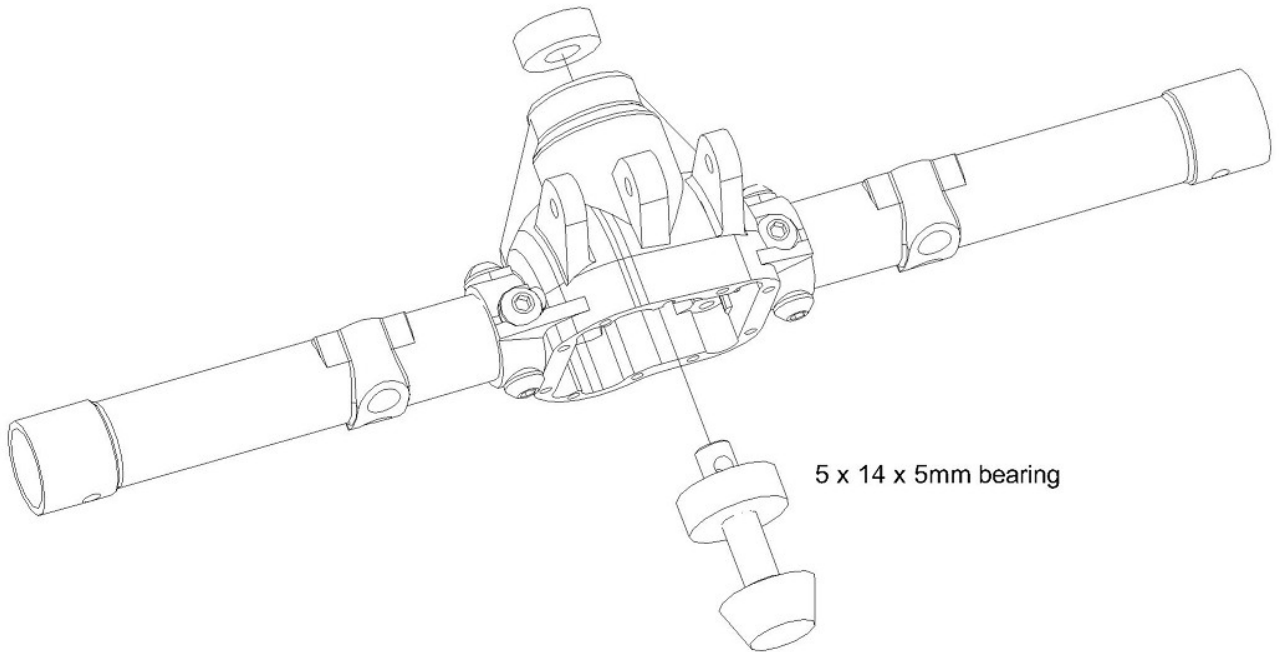

5 x 14 x 5mm bearing

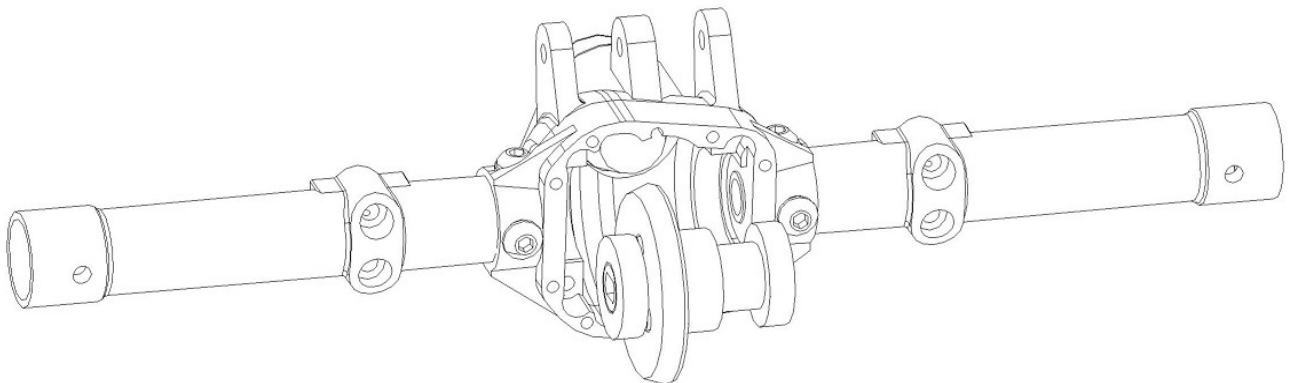

Be careful not to over tighten the screws

M2.5 x 8mm

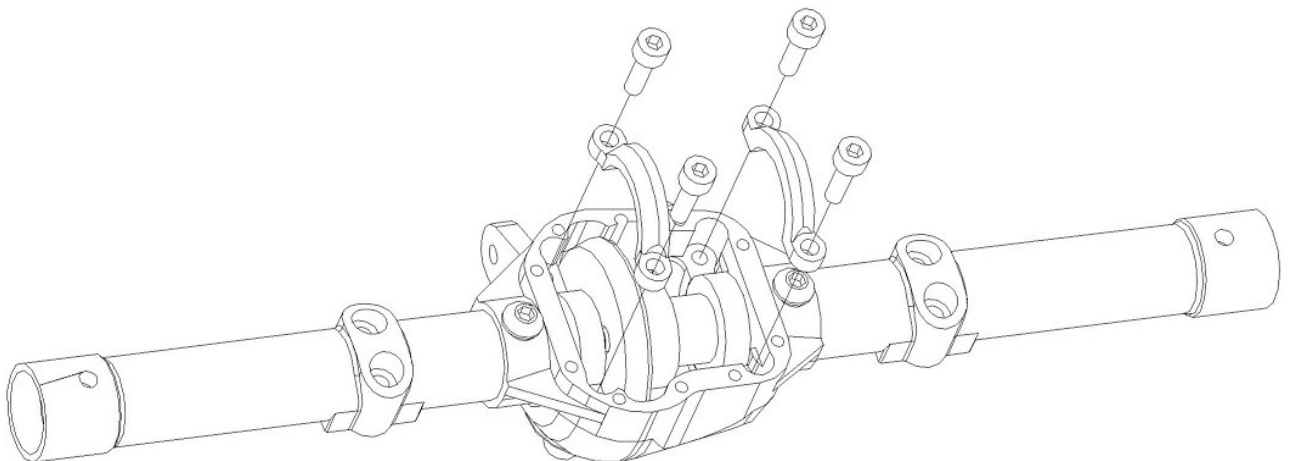

3 Install diff cover

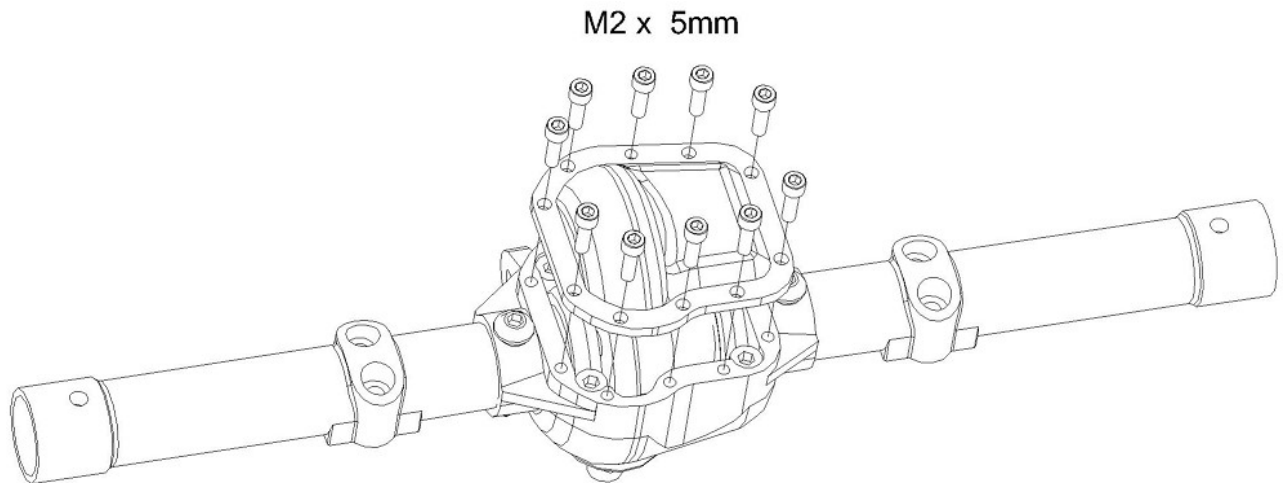

4 Install axle shafts and bearings

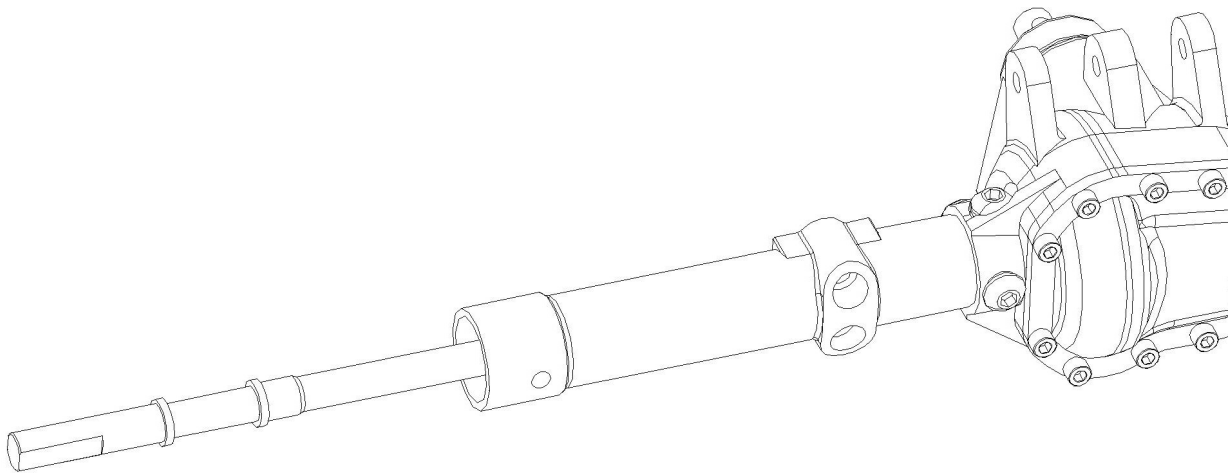

11mm bearing

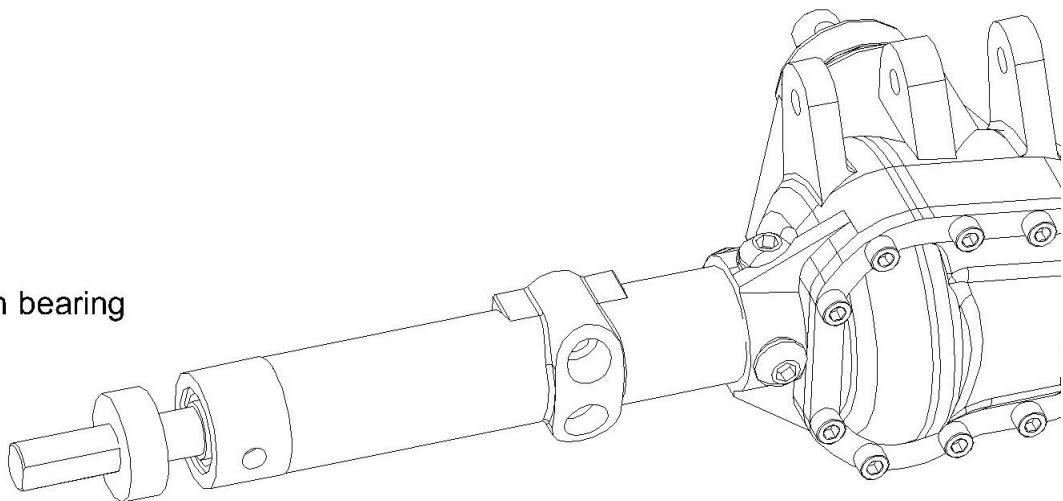

Steps 4 to 8 should be completed on both sides

5 Attach portal gear case

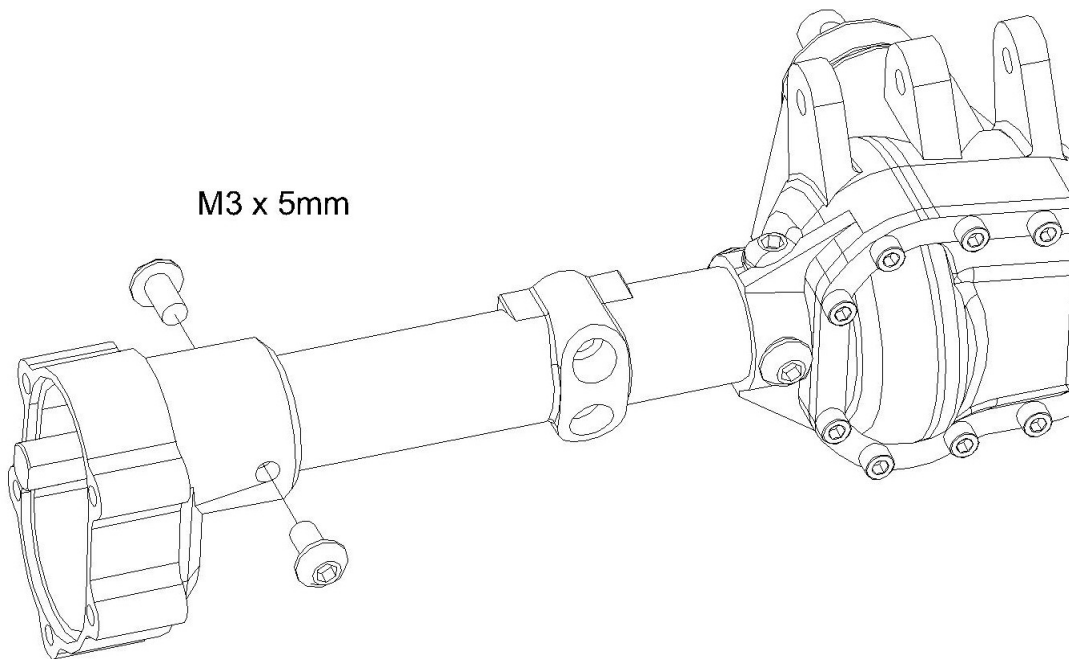
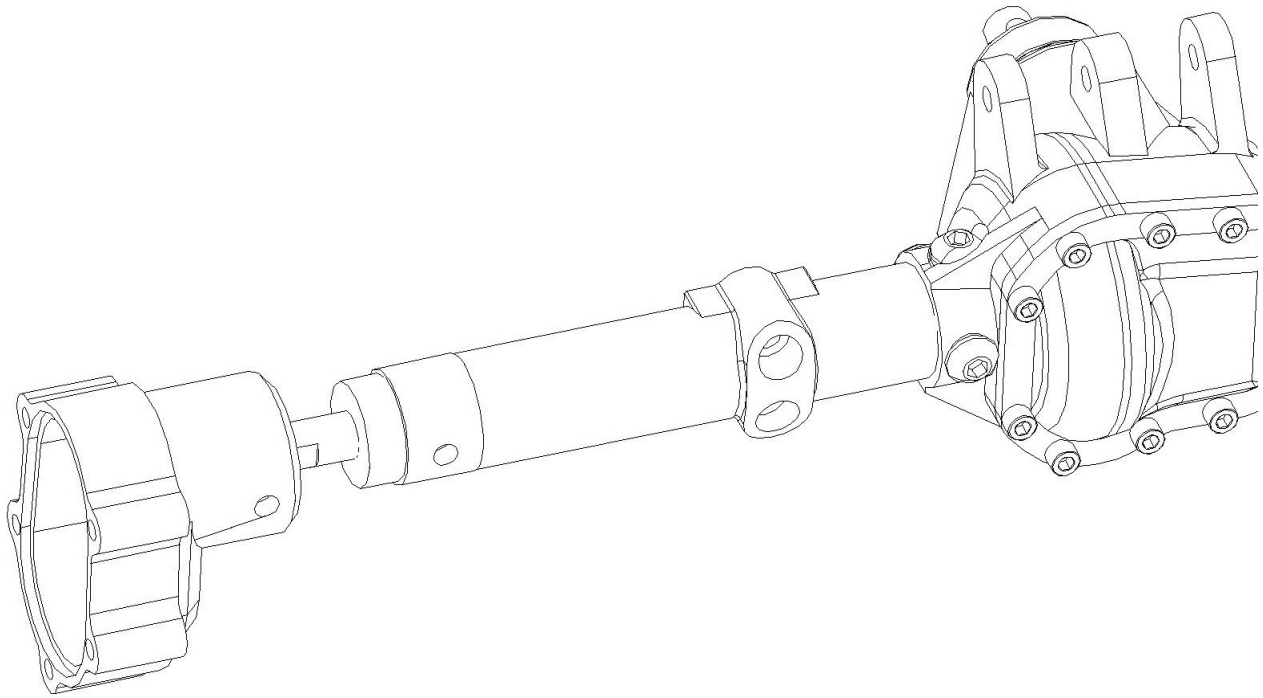

6 Install bearings

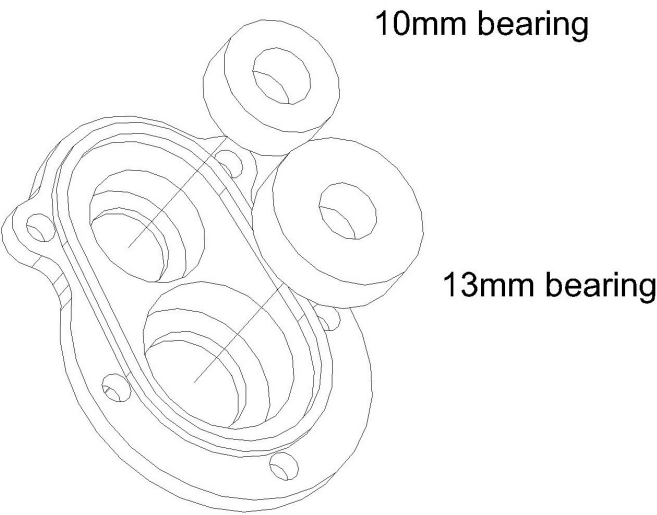
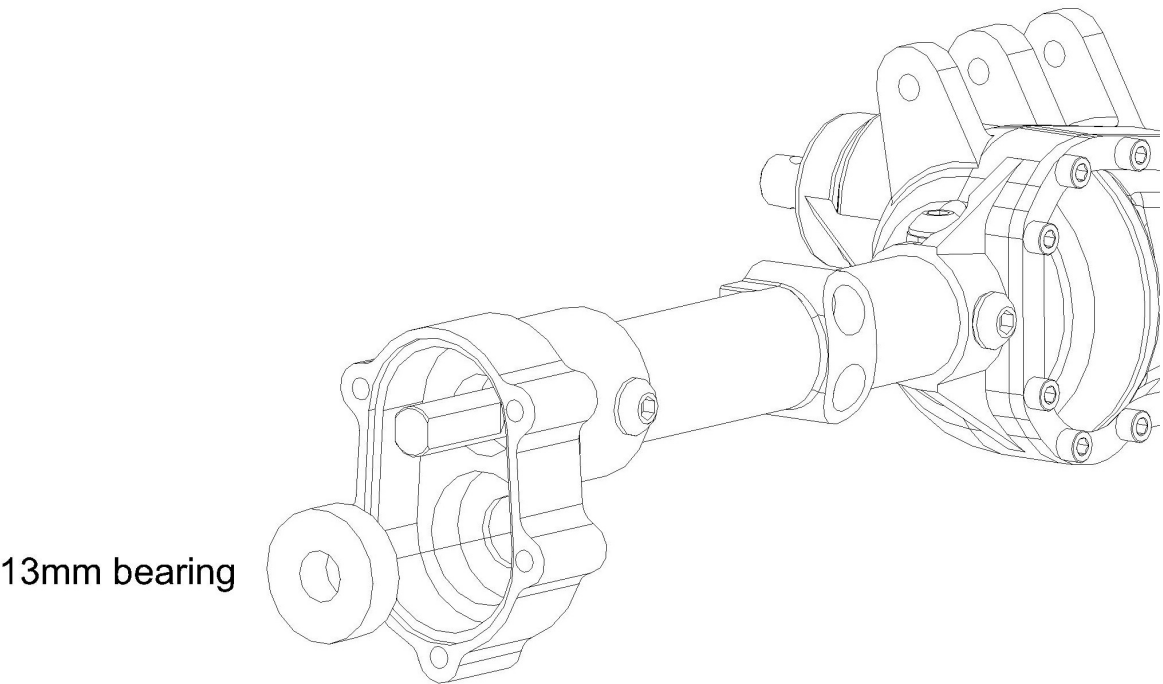

- 7 Install gears
Apply grease to the gears

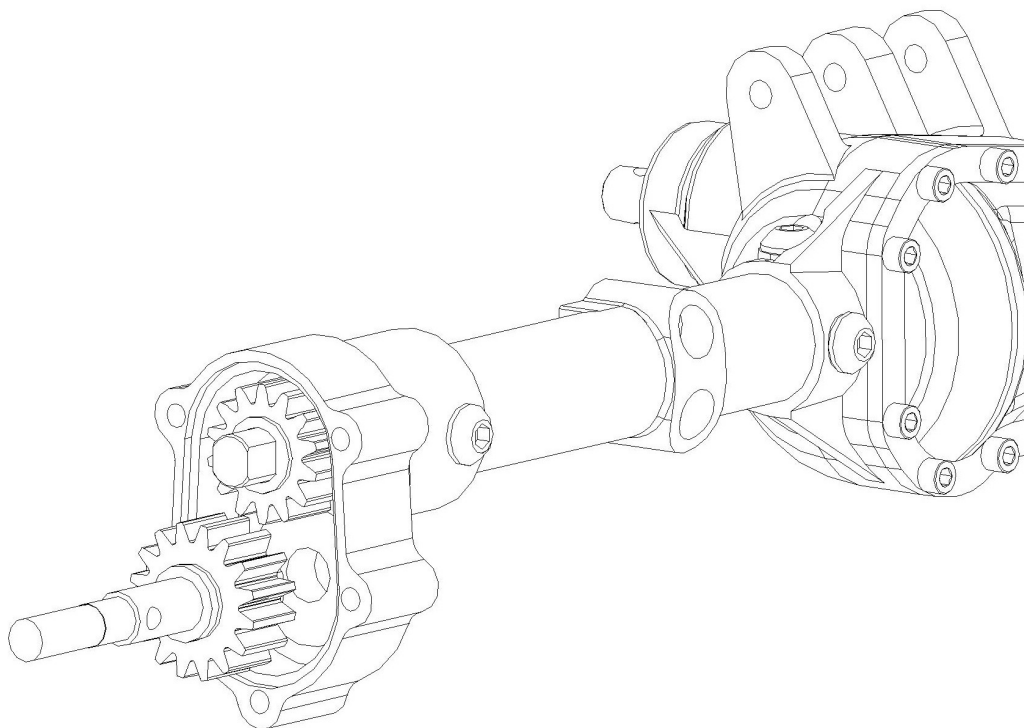
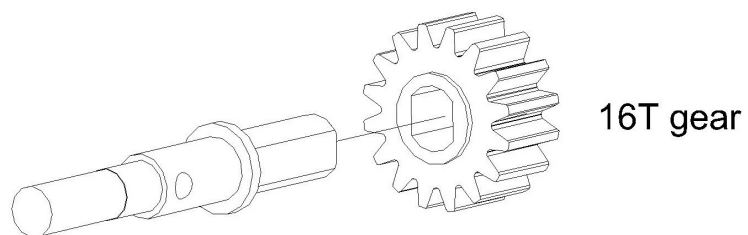
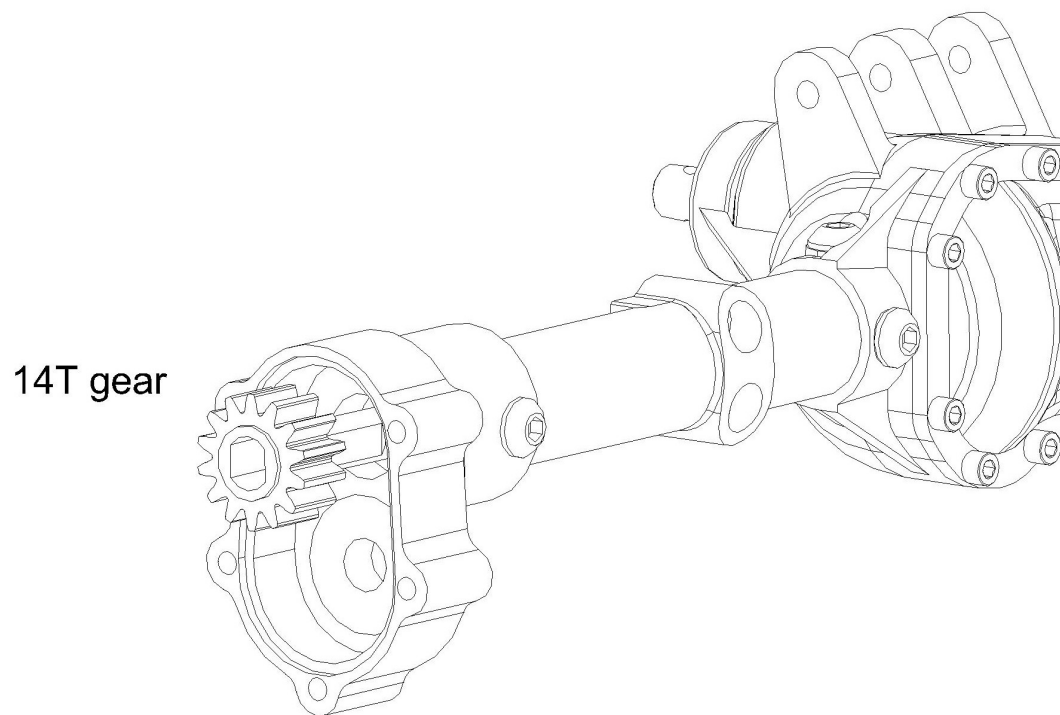

8 Install cover

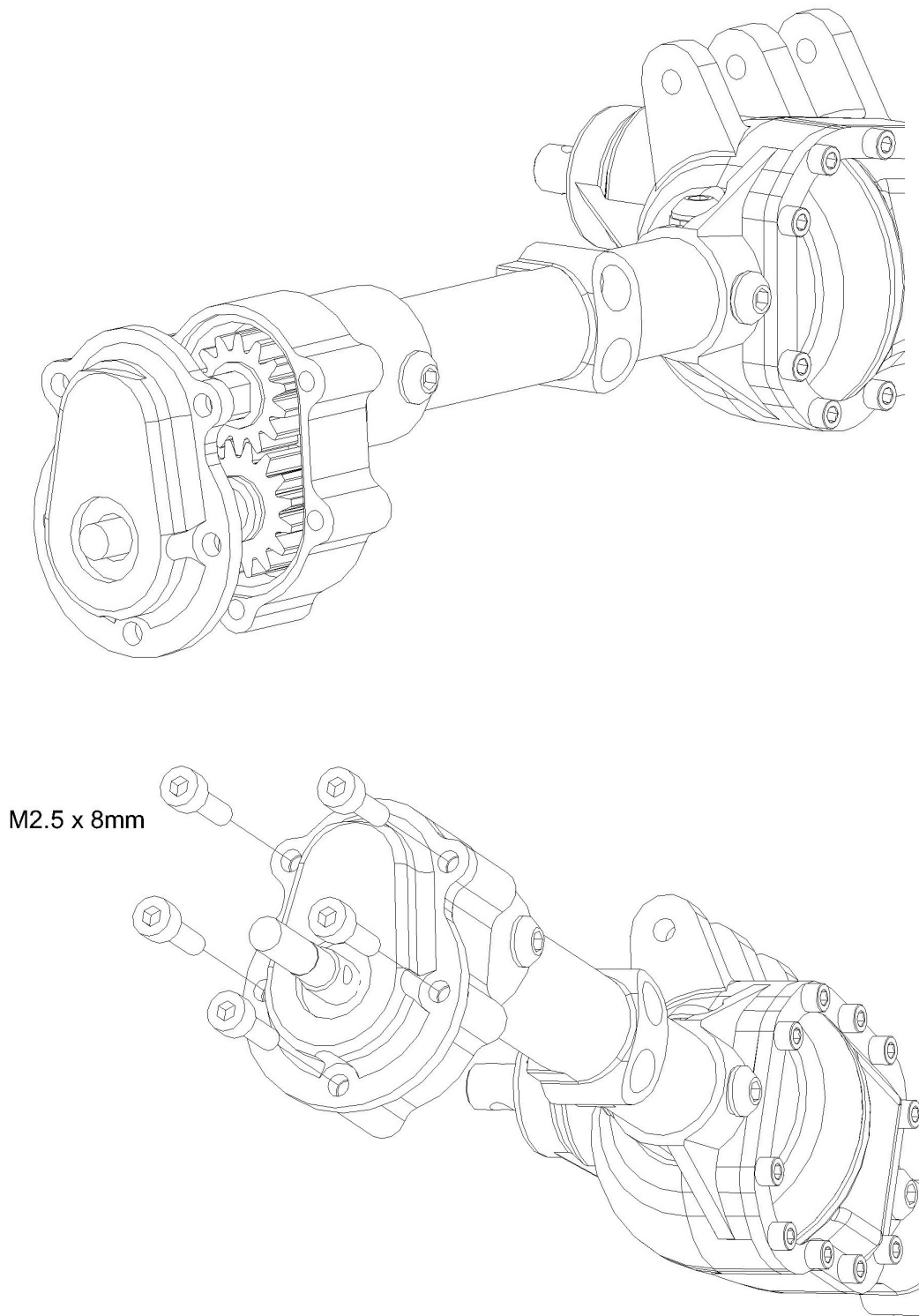

The assembled axle can now be installed on the chassis.
Hexes and wheels can be fitted in the usual way.