

# SSD Pro44 Front Axle Assembly Instructions

## 1 Attach steel locker to ring gear

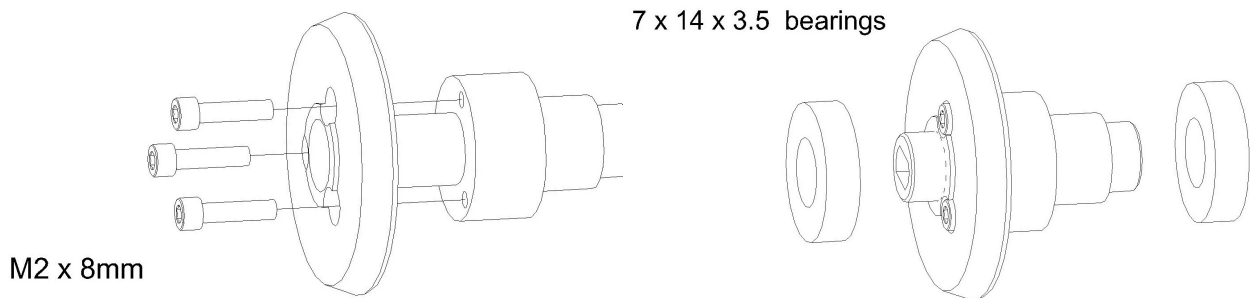

## 2 Install tubes into the housing

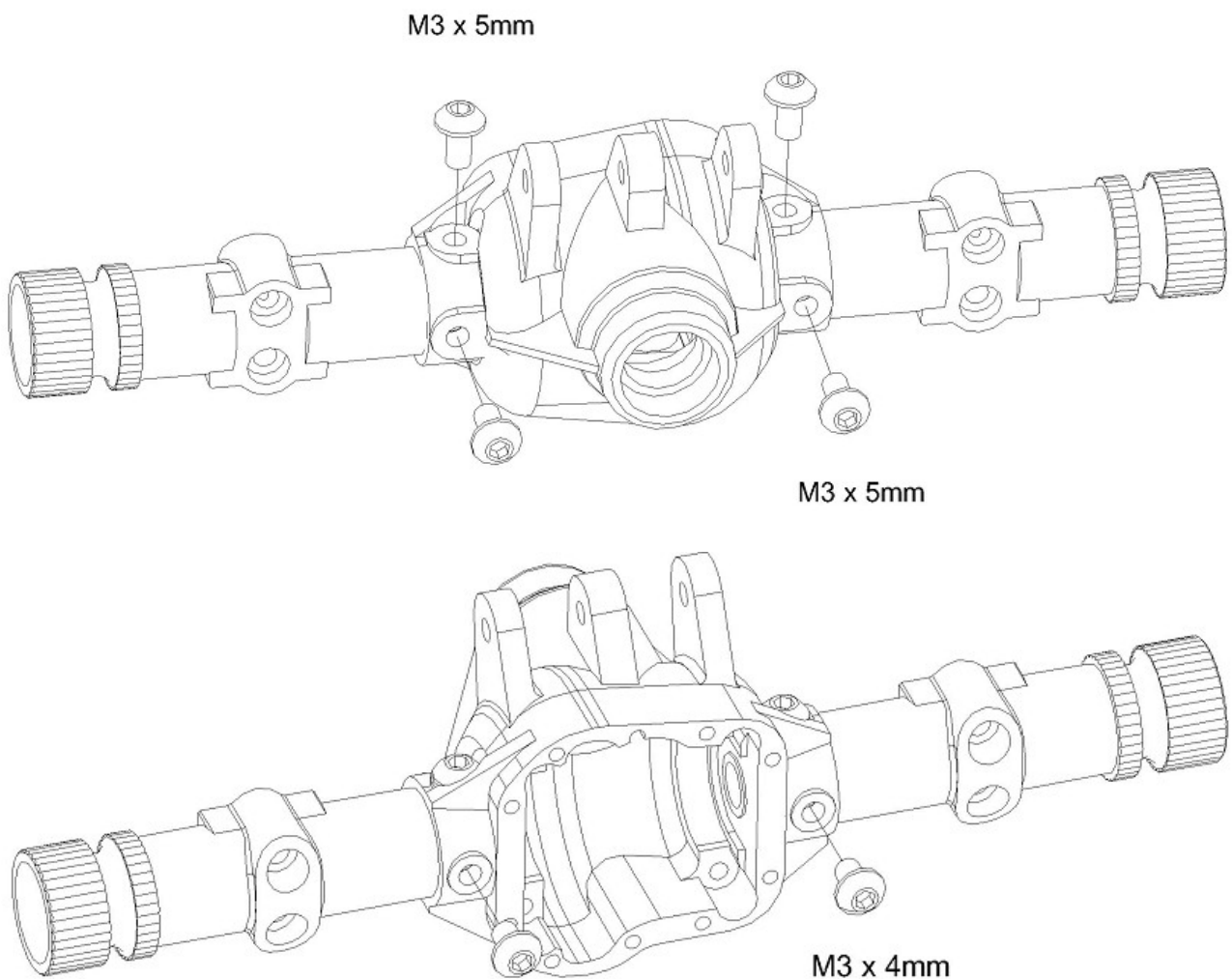

### 3 Install gears with bearings

Apply grease to the gears before installation

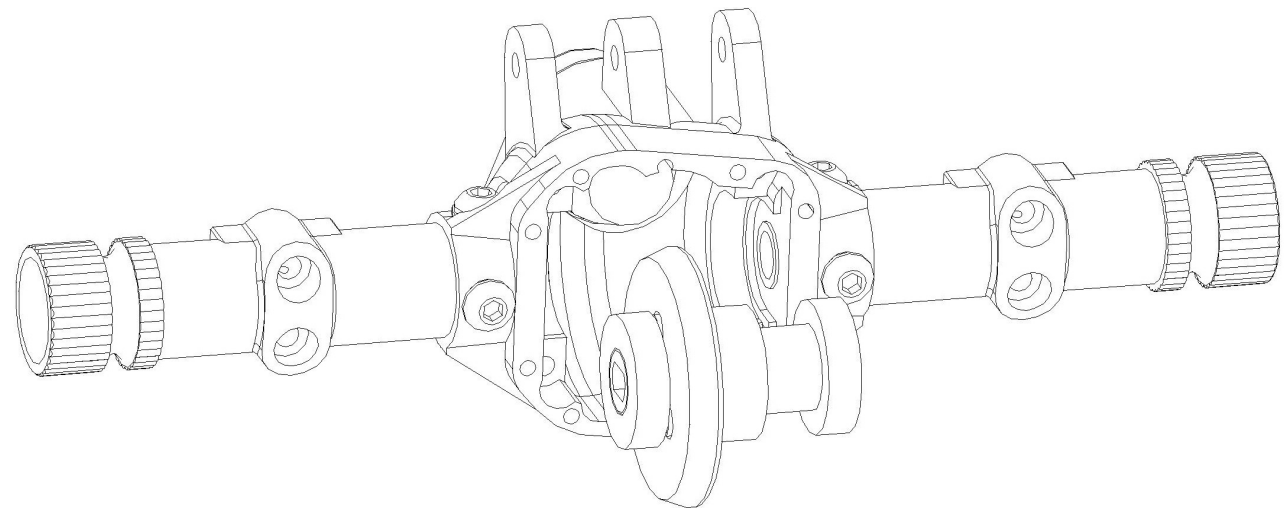
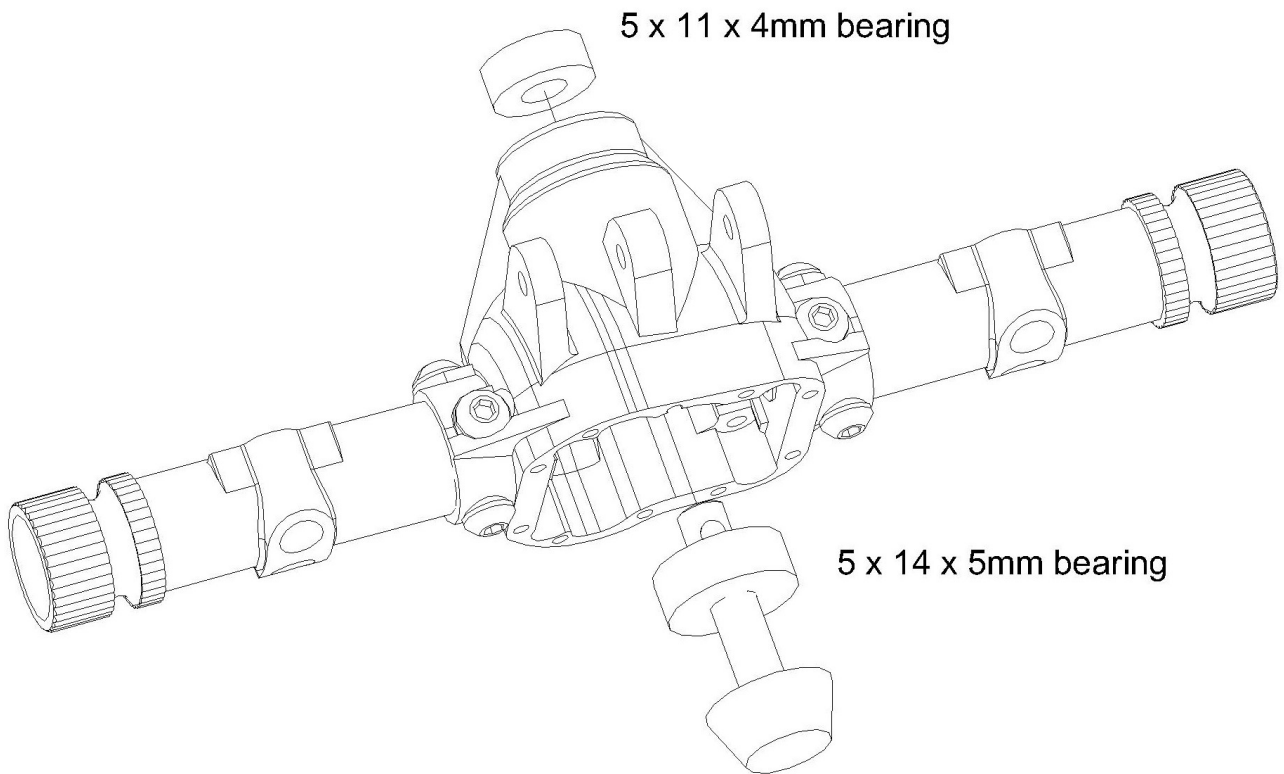

Be careful not to over tighten the screws

M2.5 x 8mm

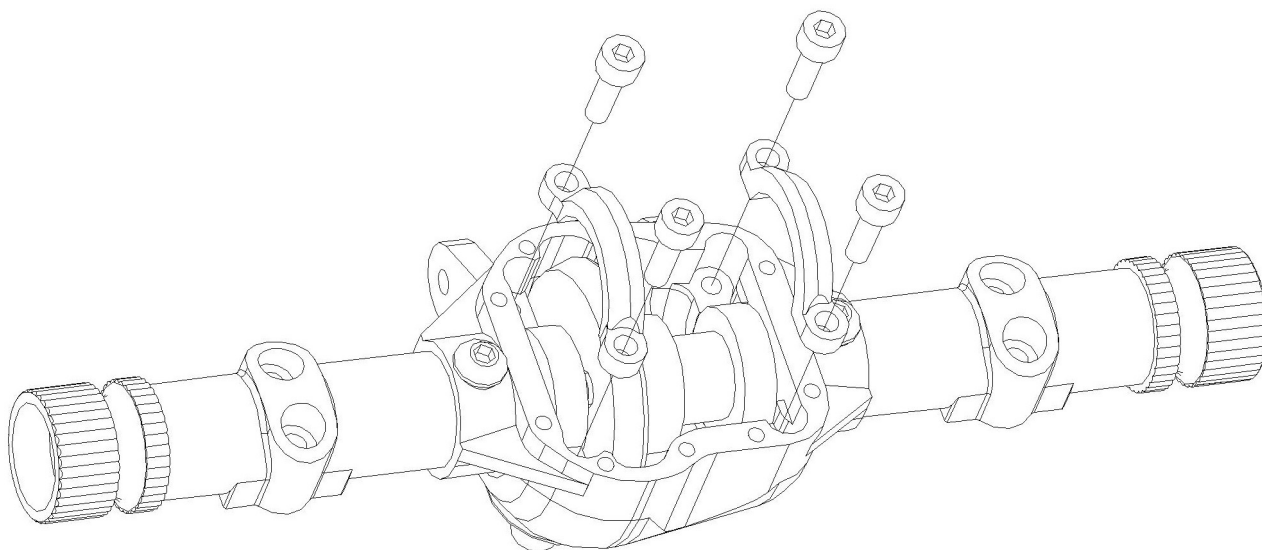

#### 4 Install diff cover

M2 x 5mm

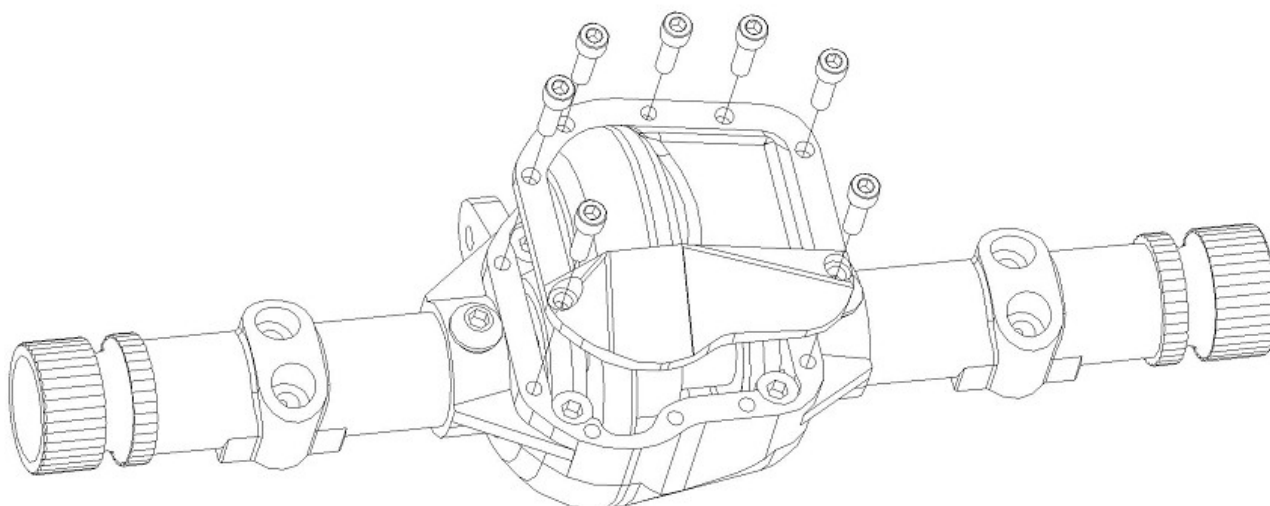

## 5 Install bearings and C hubs

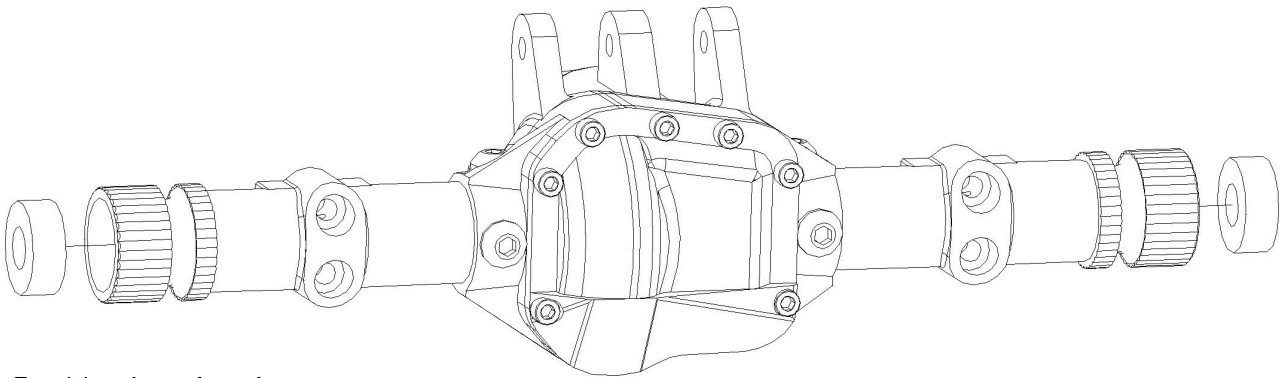

5 x 11 x 4mm bearing

C hubs should be rotated one notch back (10 degrees) when fitting

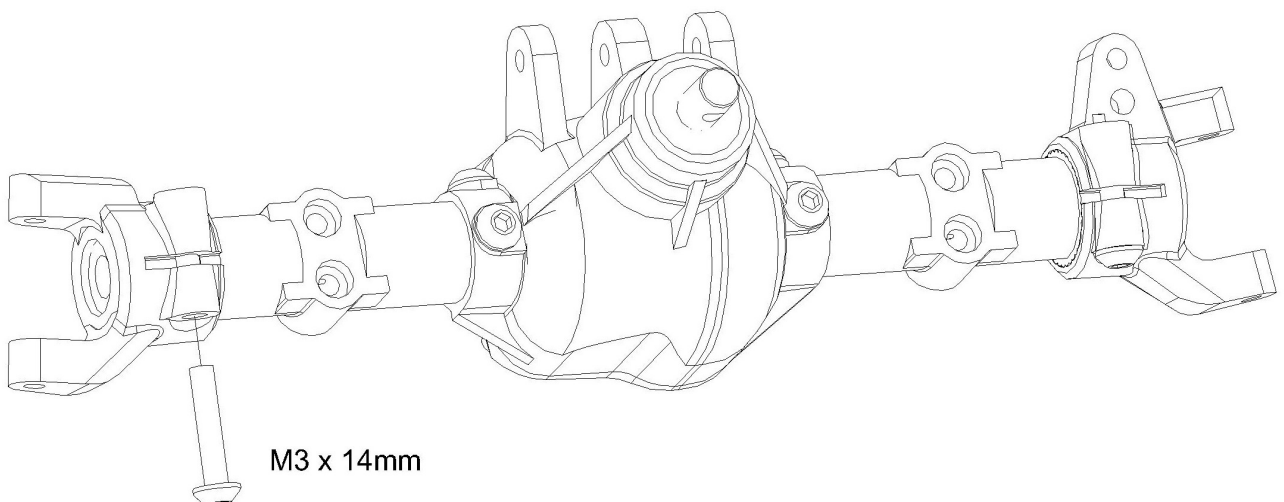
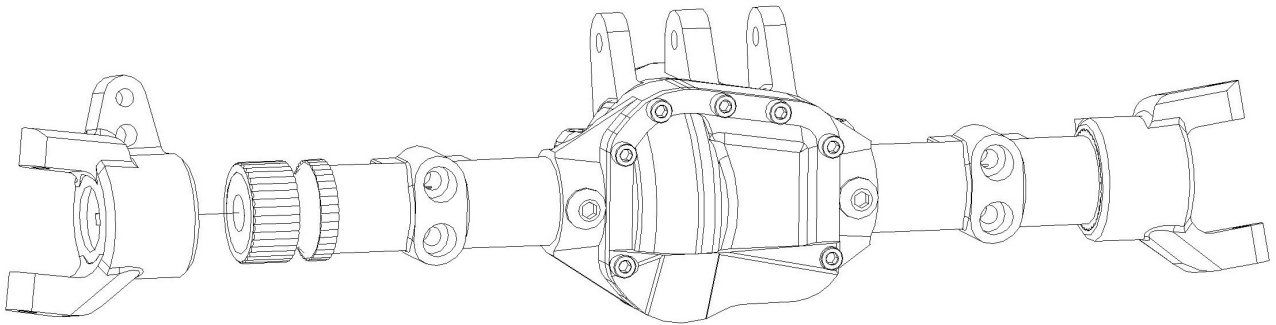

M3 x 14mm

## 6 Install CVDs

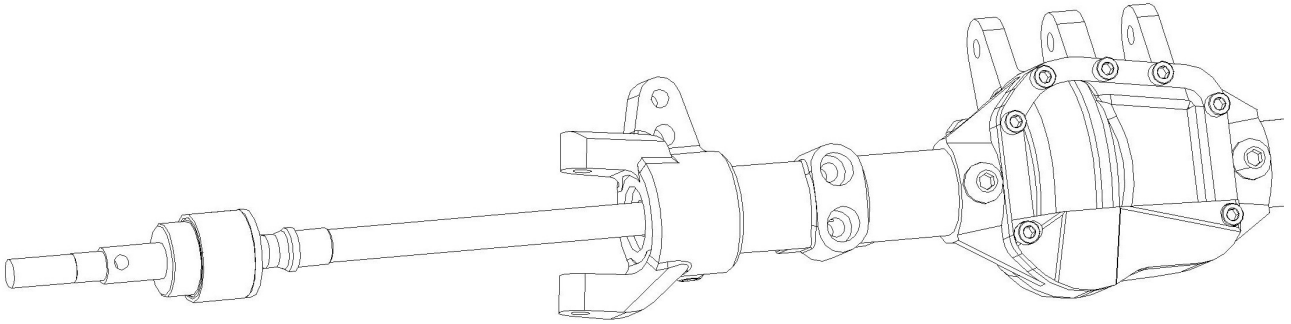

## 7 Attach knuckles Install bearings into knuckles

5 x 11 x 4mm bearing

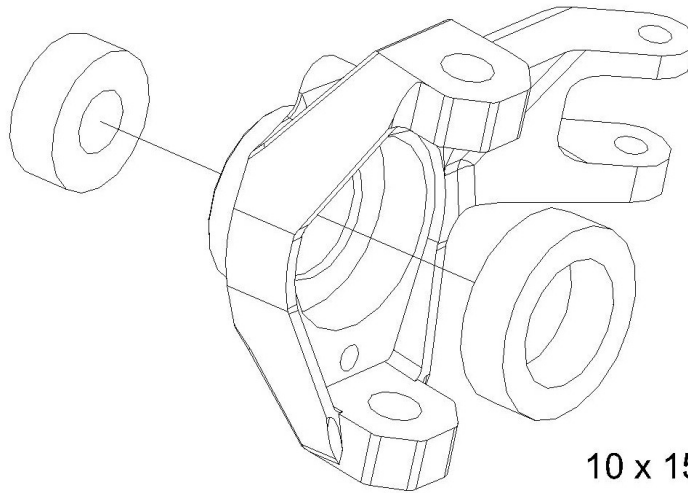

10 x 15 x 4mm bearing

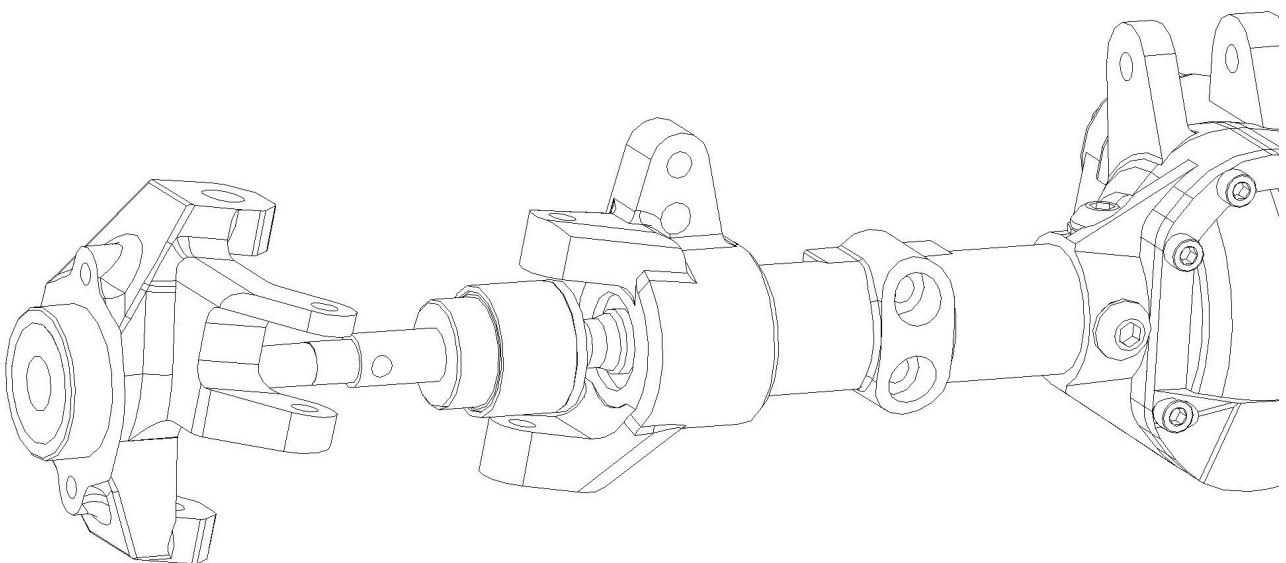

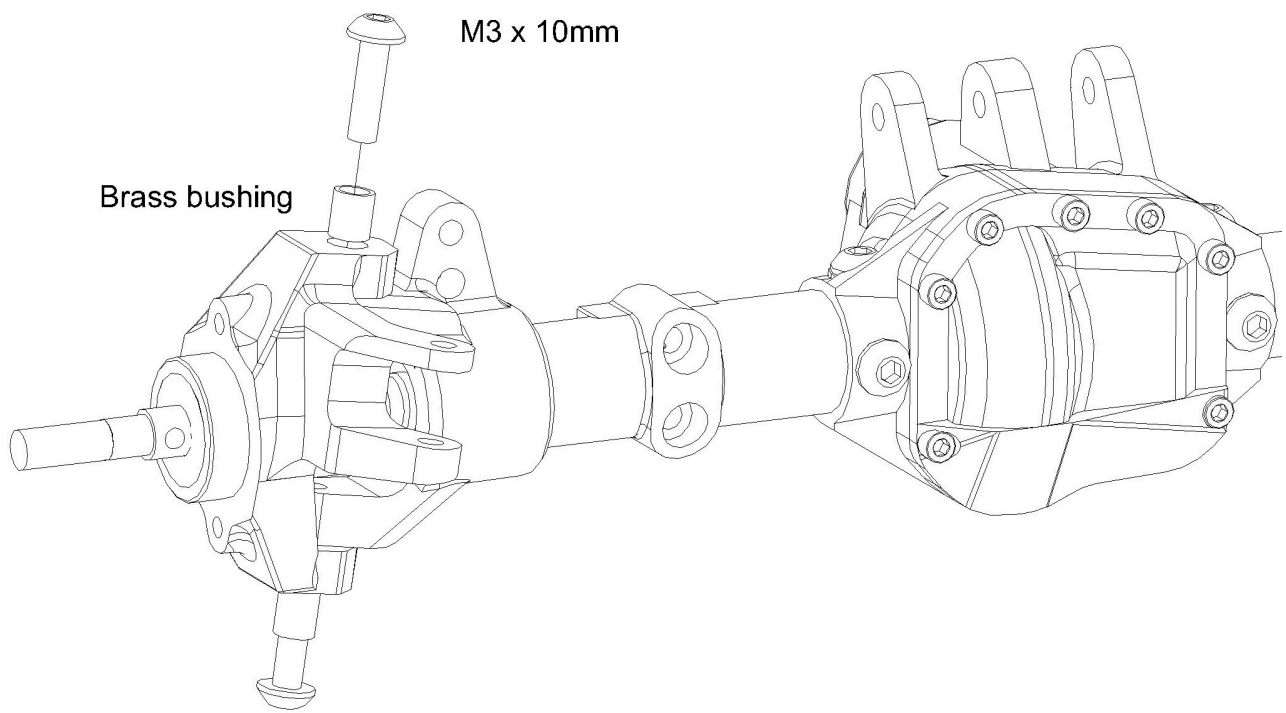

## 8 Attach aluminum link mounts

